

COLLEGE STREET  
PRESBYTERIAN  
COR:  
BATHURST & COLLEGE ST. CHURCH

TORONTO  
ANNUAL REPORT  
1887

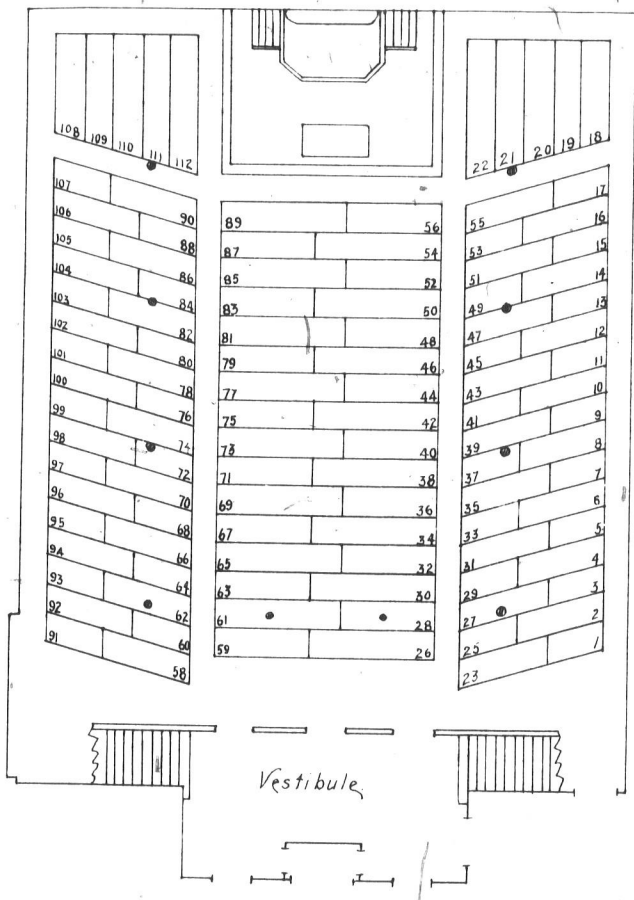

PLAN OF GROUND FLOOR.

*Plan of Gallery on inside of Back Cover.*



ANNUAL REPORT

—OF THE—

Collège Street Presbyterian Church

TORONTO,

For the Year ending December 31st, 1887,  
With the Office-Bearers for 1888.



## GENERAL NOTICES

PUBLIC WORSHIP.—Every Sabbath, at 11 a.m. and 7 p.m.

SABBATH SCHOOL.—Every Sabbath, at 3 p.m. in the School House.

BIBLE CLASS.—Every Sabbath, at 3 p.m. in the Church.

PRAYER MEETINGS.—Congregational, on Wednesday evenings, at 8 o'clock, and Sabbath mornings, at 10.30.

ORDINANCE of the LORD'S Supper is observed on the Second Sabbaths of March, June, September, and December.

ORDINANCE OF BAPTISM is administered on the first Sabbath of every month.

MUSICAL ASSOCIATION.—Meets every Friday evening at 8 o'clock, during winter months, in the School Room.

MISSIONARY COLLECTORS visit their districts monthly.

ALLOCATION OF SITTINGS.—A Committee of Managers is in attendance on first Wednesday evening of every month, at the close of the Prayer Meeting.

ANNUAL MEETING of the Congregation is held on the third Wednesday of January.

COLLEGE STREET AUXILIARY W. F. M. S., meets on first Thursday of every month.

SEATON VILLAGE MISSION—MISSION HOUSE, EUCLID AVENUE.

SABBATH SCHOOL, 9.30 a.m.

PREACHING SERVICE, 3 p.m.

PRAYER MEETING, Thursday, 8 p.m.

When members change their place of residence, notice of such change should be given immediately to the Pastor, or the Elder of their district.



## THE SESSION

	<i>Date of Induction.</i>
<i>Pastor</i> —REV. ALEX. GILRAY—Moderator.....	Jan. 5th, 1875.
(Residence, Belle Vue Avenue).	
JAMES MITCHELL.....	Nov. 28th, 1875.
JNO. SAMUELSON.....	“
JAS. CRANE.....	Apr. 28th, 1877.
ALEX. RHIND.....	Aug. 31st, 1879.
G. E. DALBY (Session Clerk).....	“
GEO. GALL.....	Mar. 6th, 1881.
WM. H. ACHESON.....	“
CHAS. R. PETERKIN.....	“
ALEX. M. CLARK.....	Aug. 15th, 1886.
J. R. MILLER.....	“
W. P. ELDER.....	“

## BOARD OF MANAGERS FOR 1888

JOHN MCCRAKEN.....	<i>Chairman.</i>
GEO. GALL.....	<i>Treasurer.</i>
G. E. DALBY.....	<i>Secretary.</i>
C. R. PETERKIN.....	<i>Treas. Building Fund.</i>
W. F. MITCHELL.....	J. ALEXANDER.
W. R. CALLAWAY.....	W. WILLARD.
A. B. SMITH.....	W. P. ELDER.
D. W. CLARK.....	WM. H. ACHESON.

## SUB-COMMITTEES.

### Finance.

JOHN MCCRAKEN, W. R. CALLAWAY, A. B. SMITH, GEO. GALL,  
C. R. PETERKIN, W. F. MITCHELL, *Chairman.*

### Church Property.

A. B. SMITH, J. ALEXANDER, C. R. PETERKIN,  
GEO. GALL, *Chairman.*

### For Allocating Sittings.

D. W. CLARK, W. WILLARD, WM. H. ACHESON, GEO. GALL  
W. P. ELDER, *Chairman.*

**Trustees.**

JAS. MITCHELL, (Elder) GEO. GALL, WM. MELVILLE.

**Leader of the Choir.**

JOHN ALEXANDER.

**Organist.**

MISS E. TORRANCE.

**Auditors.**

J. S. BROWN, R. A. C. DURNO.

**Church Officer.**

WALTER CADDELL, 177 Brunswick Avenue.

---

**SESSION REPORT**

---

**Statistics.**—During the year, 167 members have been added to the roll and 87 disjoined, leaving a net increase of 80 members. The number now on the roll is 680. 61 children have been baptized. Although the number added to the roll last year (167), nearly equals the remarkably large number (169), of the preceding year, the net increase is not nearly so large. The difference is found in the number disjoined, which is 38 in excess of the year 1886. The number and personale of our Session remain unchanged—our Pastor and eleven Elders.

The liberality of the congregation to the support of ordinances is encouraging, but not quite up to the standard we aimed at. It is very gratifying, however, to note that progression is the general characteristic of the reports of our several departments of congregational work for the past year.

The **Sabbath School** is still flourishing, the diligent and faithful efforts of the many earnest workers in this important department have been marked with much success. A large increase of members cannot be expected with its present inadequate accommodation.

The **Bible Class** has enjoyed the instructions of Mr. Thos. Logie, B.A., and under the care of one so eminently qualified, is progressing satisfactorily.

The **Missionary Association**.—The contributions of the congregation to the schemes of the church have been taken up by the collectors once per month during the past year, and a copy of *The Presbyterian Record* distributed to each family. We are much pleased with the large increase in the amount realized. Surely we can have no objects more worthy of our sympathy and liberality than those recommended by our General Assembly.

The College Street Auxiliary to the Womans' Foreign Missionary Society yields its quota this year. This Society has been a means of inspiring missionary zeal by its meetings and its literature.

We heartily congratulate the active agencies of these departments on their gratifying success. "Let us not be weary in well doing," but may we all so highly appreciate the great privileges we enjoy as to be filled with gratitude and love that our zeal may abound.

**Our Own Mission** at Seaton Village. The Sabbath School here opened on the first Sabbath morning of 1887, with preaching service on the same afternoon and a weekly prayer meeting on Thursday evening.

These meetings have been carried on without intermission. The Session appointed the Pastor, Mr. Mitchell, and the Elder of the district, a Committee charged with the special oversight.

During the summer months, Mr. Logie was appointed to the charge of the congregation and labored with much acceptance as missionary, and when the winter season began Mr. Buchanan succeeded him; the faithful service rendered by these gentlemen has been well appreciated. The attendance at the congregational service has been fluctuating, the average being 25. The Mission Hall is in an obscure place, inconvenient, unattractive, and unsuitable, but being the only available building, has been used of necessity. Any considerable growth cannot reasonably be expected in such circumstances. The Mission has been loyally and zealously supported, however, by our few friends resident in the locality.

The Mission Sabbath School has grown and flourished. The teachers and officers engaged in it have been encouraged by the large attendance and the admirable conduct of the scholars. The mutual attachment of teachers and scholars is a source of much satisfaction. Above all, we gratefully recognize the good hand of the Master in the evidences of growth in Christian grace both in the school and congregation. We earnestly commend the Mission to the whole congregation, hoping it may be the means of developing a large-hearted and unselfish missionary spirit, and afford ample scope for aggressive work.

As we expect each department to submit a report of its operations we deem it unnecessary to enter into further details, which would probably anticipate the interesting matters they will present. We cannot close our brief report, however, without expressing our gratitude for the peace and concord which have prevailed throughout the year, and for all the prosperity our good Lord has been pleased to send upon us.

To His name be all the praise.

ALEX. GILRAY,

*Moderator.*

G. E. DALBY,

*Clerk.*

## MISSIONARY ASSOCIATION

REV. ALEX. GILRAY.....	<i>President.</i>
MR. J. R. MILLER.....	<i>1st Vice-President.</i>
MR. JAMES CRANE.....	<i>2nd Vice-President.</i>
MR. ALEX. B. SMITH, 29 Oxford Street.....	<i>Sec.-Treasurer.</i>

### Executive Committee.

DR. FERGUSON,	MR. ROBT. MARSHALL,
MR. JNO. BREMNER,	MR. ANDREW WILSON,
MR. J. A. DINGWALL,	MR. WM. SIMPSON.

### Collectors.

Miss Edith Dalby,	Mrs. J. Breckinridge,	Mrs. Sargent,
Miss M. Cooper,	Miss M. Smith,	Miss Hanna,
Mrs. Sinclair,	Mrs. Taylor,	Miss Rhind,
Mrs. J. McCracken,	Miss Peterkin,	Mrs. Samuelson,
Miss Jessie Mitchell,	Mrs. McLeod,	Miss Clark,
Miss L. Grimason,	Mrs. J. R. Miller,	Mrs. A. B. Smith,
Miss Abbie Grimason,	Mrs. W. P. Elder,	Miss Forfar.
Miss Overton,	Miss E. Clark,	Miss McWhinney

Your Committee are glad to be in a position to report a substantial and gratifying increase in the missionary offerings. It is always encouraging to those who take an active interest in the welfare of this association to find that the congregation is not only growing in liberality but also in missionary spirit and intelligence.

The system of visiting the districts and distributing the *Record* monthly has met with favor, and the committee is so well satisfied with the experiment that the same system will be adhered to in future. After deducting the cost of the *Record* the amount at the disposal of the congregation is \$180.68 in advance of the preceding year.

A. B. SMITH,  
*Sec.-Treasurer.*

Financial statement, page 14.

COLLEGE STREET PRESBYTERIAN CHURCH

STATEMENT OF MONEYS CONTRIBUTED DURING THE PAST YEAR  
AND HOW APPLIED

MISSIONARY SCHEMES	Missionary Ass'n	Sabbath School	Bible Class	Total
Home Missions.....	\$123 50	\$40 00	\$3 00	\$166 50
Foreign Missions.....	77 00	86 29	4 00	167 29
Augmentation .....	128 50		3 00	131 50
French Evangelization .....	30 00	10 00		40 00
Knox College.....	35 00			35 00
Aged and Infirm Ministers' Fund.....	12 00			12 00
Widows and Orphans .....	5 00			5 00
Manitoba College.....	18 00			18 00
Assembly Fund.....	12 00			12 00
Students' Missionary Association of Knox College.....	10 00	15 00		25 00
St. Paul's Institute, Tarsus .....		12 00		12 00
Seaton Village Mission.....	35 00	10 00	30 00	75 00
Total .....	\$486 00	\$173 29	\$40 00	\$699 29
College St. Auxilliary W. F. M. S.....				111 33
Grand total.....				\$810 62

COLLEGE ST. AUXILIARY W. F. M. S.

- MRS. GILRAY..... *President.*
- MRS. W. F. ROSS..... *1st Vice-President.*
- MRS. A. B. SMITH..... *2nd Vice-President.*
- MRS. J. R. MILLER..... *3rd Vice-President.*
- MRS. GEO. GALL..... *Secretary.*
- MISS T. B. PETERKIN..... *Treasurer.*

This Society was formed last February. We have had much encouragement in every respect. The interest has been well sustained. Present membership 44. Our object is to aid in sending out and sustaining female missionaries in Foreign Fields and the North West. A quantity of clothing has been sent for distribution in the latter field. "Inasmuch as ye have done it unto the least of one of these, ye have done it unto Me."

M. GALL,  
*Secretary.*

## SEATON VILLAGE MISSION

(FIRST ANNUAL REPORT)

Largest attendance of congregation, 40, smallest 11.  
 Average attendance of congregation, 25.  
 Largest attendance of scholars 51, smallest (opening day) 1.  
 Average attendance of scholars, 31.  
 Average attendance of teachers and helpers, 4.

We have much cause to thank our Heavenly Father for His goodness and for the prosperity that has attended our feeble efforts, especially in the Sabbath School, the success of which has far exceeded our expectations.

We have to record the death of two of our infant class.

We would have been pleased to have reported a larger attendance at the congregational services, but with location and other circumstances considered, we have every reason to be thankful. With an ever increasing school, the average attendance of which would have been larger had it not been for the prevalence of diphtheria in the village, we have great faith in the future of the congregation.

J. J. HARTON,

*Secretary.*

Financial statement, page 16.

## SABBATH SCHOOL

### Office-Bearers

REV. A. GILRAY .....	<i>President.</i>
MR. J. R. MILLER .....	<i>Superintendent.</i>
MR. JOHN SAMUELSON .....	<i>Asst. Supt.</i>
MR. ALEX. M. CLARK .....	<i>Deputy Asst. Supt.</i>
MR. JAS. SALMOND .....	<i>Sec.-Treasurer.</i>
MR. GEO. B. SALMOND .....	<i>Asst. Sec.-Treas.</i>
MR. D. W. CLARK .....	} <i>Librarians.</i>
MR. JAS. A. DINGWALL .....	
MR. JAS. MITCHELL .....	} <i>Missionaries.</i>
MR. WM. WILLARD .....	
MR. W. H. ACHESON .....	<i>Leader of Singing.</i>
MISS ELLA GRAY .....	<i>Organist.</i>

### Teachers

Mr. Sharpe	Mrs. J. P. Martin
" T. Johnson	" Martin
" A. M. Clark	Miss Urry
" Grant	" A. J. Grimason
" W. McCully	" J. Scott
" A. Morrison	" Elsie Clark

Mr. W. F. Mitchell	Mrs. Bentley
" D. Cameron	Miss Gray
" D. Carswell	" Woolley
" Lang	" Waterston
" J. Adamson	" McGregor
" David T. Gray	" J. Rhind
" J. J. Johnstone	" G. Taylor
" A. Wilson	" M. Grimason
" Hay	" A. Grimason
" Geo. Duthie	" Hannah
" Jno. McCracken	" Smith
" John Mutch	" Dalby
" W. H. Acheson	" E. Gray
" Geo. Gall	" Savage
" Graham	" Forsyth
Mrs. Peterkin	" L. Grimason
" Taylor	" Howell
" Miller	

**Statistics**

Average attendance of scholars was 389.  
 Highest attendance during the year 466, lowest 252.  
 Average attendance of teachers, 42.  
 During the year 7 boys and 7 girls have been present every Sabbath.  
 Collections for Missions, \$173.29; for appropriations, see page 7.

Mr. Mitchell having resigned the Superintendency, Mr. Miller was appointed to the office.  
 We have to record the removal by death of Miss Connell, who had been a faithful teacher for several years.

JAS. SALMOND,  
*Sec.-Treasurer.*

Financial statement, page 15.

**BIBLE CLASS**

MR. THOS. LOGIE, B.A. ....	<i>Teacher.</i>
MR. W. S. DALBY .....	<i>Treasurer.</i>
MR. JAS. BROWN .....	<i>Secretary.</i>

The average attendance was 36, an increase of 11 over last year. Collected for Missions, \$40.70; an increase over 1886 of \$1.46. The collections of the last Sabbath of each month are devoted to a fund for the furnishing of a new class-room. The balance is applied to the support of missions at home and abroad.

JAMES BROWN,  
*Secretary.*

For application of Mission Funds, see page 7.  
 Financial statement, page 16.

## MANAGERS' REPORT

Our ordinary revenue is derived solely from weekly contributions either by envelope or collection taken on the plates each Sabbath day.

We have received during the year the following amounts:—

1st Quarter by Envelope...	\$776 28	By Collections:...	\$255 66
2nd " " .....	798 01	" " .....	271 51
3rd " " .....	746 80	" " .....	228 90
4th " " .....	815 76	" " .....	269 34
	\$3136 85		\$1025 41
Total .....			\$4162 26

Being an average per Sabbath of \$80.04, a total increase over 1886 of \$600.33, or an average weekly increase of \$11.54.

We have pleasure in stating that the envelope system of contribution is growing in favor with the congregation and is more perfect than heretofore. By this means, 227 contribute sums ranging from 5 cents to \$2.50 as follows:—

17 persons at 5 cents.....			\$ 0 85
29 " 10 " .....			\$ 2 90
19 " 15 " .....			2 85
20 " 20 " .....			4 00
81 " 25 " .....			20 25
17 " 30 " .....			5 10
5 " 35 " .....			1 75
6 " 40 " .....			2 40
1 " 45 " .....			0 45
19 " 50 " .....			9 50
2 " 60 " .....			1 20
2 " 75 " .....			1 50
5 " 1 00 " .....			5 00
1 " 1 50 " .....			1 50
2 " 2 00 " .....			4 00
1 " 2 50 " .....			2 50
			\$65 75
Total .....			\$65 75

The total current expenses including interest on debt amounts to about \$5,000.00, while the income is only \$4,162.00, thus showing a deficiency of \$838.00. This amount has necessarily been made good by applying part of the subscriptions to Building Fund to paying interest.



**Sittings.**

The church contains 1,068 sittings, as at present arranged. Ground floor contains 616, only 29 of these are vacant. Gallery contains 422, of which 270 are vacant.

Our committee will be glad to allocate sittings to the few friends who have not yet applied for them.

W. F. MITCHELL,

*Chairman.*

G. E. DALBY,

*Secretary.*

Financial statement, page 13.

**STATISTICS FROM 1874 TO 1888**

Date of Annual Meeting.	Members-hip.	Increase	Mission-ary Contri-butions.	Ordinary Revenue.	Revenue from all Sources.
1874	*33	33	\$ 43 41	§§380 22	\$ 948 40
1875	†100	67	.....	.....	.....
1876	185	85	‡67 80	1023 26	.....
1877	210	25	.....	1267 22	.....
1878	256	46	.....	1465 67	.....
1879	295	39	195 85	1480 52	2435 98
1880	321	26	217 19	1589 01	2078 85
1881	340	19	327 37	1666 04	2092 14
1882	385	45	244 61	1879 85	2997 35
1883	371	.....	315 90	2229 84	3851 44
1884	400	15	324 25	2270 98	3344 49
1885	429	29	330 04	2206 49	5378 22
1886	480	51	416 01	2858 61	5483 32
1887	600	120	495 82	3561 93	5545 85
1888	680	80	810 62	4162 26	7151 61

\* 24th Feb'y, 1874. † March, 1875. ‡ For 15 months. § Oct., 1874. || For 15 months.

Meetings in 1876 and all the years after were held in January.

We have not a full record of finance where blanks occur.

---

**BUILDING FUND**

In presenting the annual statement of the Building Fund the Treasurer desires to report that the total amount of subscriptions to date (including new subscriptions this year to the amount of \$346.75) has reached the sum of \$10,723.80, of which \$1,459.36 has been paid in during the year just past, making a total amount paid of \$5,746.98 during the years 1884 to 1887 inclusive, thus leaving a balance of \$4,976.82 unpaid. Although the sum of \$533.59 has been received during this over the preceding year, yet it has not reached the amount it should have when we take into consideration the efforts put forth by the Elders and Managers for the total extinction of the floating debt by a personal visit to the members and adherents of the congregation.

Those who have not yet subscribed but who wish to help along the good cause can do so by putting their amounts in an envelope and marking it "Building Fund," and placing it on the collection plate at either morning or evening service, or by addressing it to the undersigned treasurer of the Building Fund for the year 1888. Care should be taken to write your own name and address in full, and put inside of the envelope, so that no mistake may occur, and that the right parties may be credited with what they may send in.

As the sum of \$1,350.00 falls due on April 3rd, 1888, a good opportunity is thus afforded for reducing our indebtedness, and thus save a large amount of interest which has to be paid from time to time.

All of which is respectfully submitted.

C. R. PETERKIN,  
*Treasurer.*

5 Bellevue Place.

Financial statement, page 14.



# = FINANCIAL STATEMENT =

## Ordinary Revenue Account—GEORGE GALL, *Treasurer*.

To Balance from last year.....	\$ 12 12		
" Public School Board .....	180 00	By Insurance .....	\$ 30 00
" Thanksgiving Service .....	14 09	" Building Fund .....	770 87
" Open Collections.....	1,025 41	" Interest Account, per Rev. Dr. Reid.....	94 26
" Offerings in Envelopes.....	3,136 85	" Presbytery and Synod Fund .....	25 09
" Concert.....	61 30	" Walter Caddell.....	300 00
" Bible Class.....	30 00	" J. Alexander .....	200 00
" Seaton Village Mission.....	21 67	" Miss Torrance.....	100 00
		" Rev. A. Gilray .....	2,000 00
		" Pulpit Supply .....	23 00
		" Appropriation to Session .....	12 00
		" Gas, Fuel, and Water .....	311 19
		" Printing, Advertising, etc.....	59 95
		" Repairs and Sundries.....	154 76
		" Poor Fund.....	64 09
		" Hospital Fund .....	10 00
		" Sunday School Library.....	117 68
		" Seaton Village Mission.....	198 00
		" Cash on hand .....	10 64
			\$4,481 44
	\$4,481 44		

**Building Fund—C. R. PETERKIN, Treasurer.**

To Balance from last year.....	\$ 12 61	By paid Star Life Ass'n, 12 months' interest.....	\$1,401 60
" Cash received from Subscribers.....	1,459 36	" Interest.....	142 85
" Loan from Bible Class.....	11 05	" off portion of Floating Debt.....	850 00
" " Sabbath School Association.....	70 00	Balance.....	31 74
" " Treasurer General Revenue.....	770 87		
" " Ladies' Furnishing Fund.....	28 50		
" " Collections Anniversary Services.....	40 00		
" " Proceeds Dr. Cochran's Lecture.....	33 80		
	<u>\$2,426 19</u>		<u>\$2,426 19</u>

**Missionary Association—A. B. SMITH, Secretary-Treasurer.**

To Balance from last year.....	\$311 00	By Appropriated to various schemes.....	\$305 32
" Collection Missionary Anniversary.....	8 31	" paid for 325 copies of Record.....	81 25
" Special Contribution for Missions, anonymous.....	6 75	" Post Office Order remitting same.....	50
" " Mr. Goforth.....	1 25	" paid Mr. Hall.....	3 40
" " Mr. Hall, City Missionary.....	3 40	" Minute Book from Bain & Son.....	1 50
" Contributions, per Collectors.....	546 53	" Cash in Bank.....	483 22
" Interest.....	5 22	" Cash on hand.....	6 02
	<u>\$882 46</u>		<u>\$882 46</u>

**Sabbath School Association.** JAMES SALMOND, *Treasurer.*

To Balance from last year.....	\$313 62	By Loan to Building Fund.....	\$ 70 00
" Mission Fund.....	173 29	" Missions, per Dr. Reid.....	158 76
" Building Fund.....	74 61	" Books for Library, per J. Young.....	117 68
" Four Congregational Collections.....	38 11	" S. S. Association, per J. Woodhouse.....	8 00
" Balance from Pic-Nic.....	10 45	" Books, Papers and Cards.....	74 29
" Treasurer, General Revenue.....	117 68	" Cash in Bank.....	305 88
" Interest.....	7 00	" Cash on hand.....	15
	<hr/>		<hr/>
	\$734 76		\$734 76

**College St. Auxiliary W. F. M. S.—Miss T. B. PETERKIN, *Treasurer.***

To Subscriptions for one Life Membership.....	\$ 25 00	By Cash paid Miss Reid.....	\$ 25 00
" 7 Subscriptions Membership General Society.....	7 00	" " " on hand.....	86 33
" 37 " " " College St. Auxiliary.....	9 25		
" Thank offering in November.....	16 21		
" Collections, Mite Boxes.....	23 39		
" " " Envelopes.....	25 58		
" Literature.....	1 70		
" Proceeds from Wax Flowers.....	3 00		
	<hr/>		<hr/>
	\$111 33		\$111 33

**Bible Class.**—W. S. DALBY, *Treasurer.*

To Balance from last year.....	\$11 05	By Seaton Village Mission.....	\$30 00
" Collections.....	52 86	" Loan to Building Fund.....	11 05
		" Mission Schemes.....	10 00
		" Fund for furnishing Class Room.....	12 16
		" On hand.....	70
	<u>\$63 91</u>		<u>\$63 91</u>

**Seaton Village Mission.**—GEO. E. DALBY, *Treasurer.*

To Contribution Funds of Mission.....	\$ 15 81	By Thos. Logie.....	\$198 00
" Caretaker's Salary refunded.....	10 00	" Furnishing Stove, Chairs, etc.....	30 40
" Grant from Missionary Association.....	20 32	" Fuel and Sundries.....	7 14
" Congregational Collections at Mission.....	50 72	" Caretaker.....	10 00
" Sabbath School.....	33 61	" Rent.....	60 00
" General Treasurer.....	106 70	" Printing.....	1 25
" Bible Class.....	30 00	" Paid to General Treasurer.....	21 67
" Concert.....	61 30		
	<u>\$328 46</u>		<u>\$328 46</u>

Total Amount from all sources during the year..... **\$7,151 61**  
 R. A. C. DURNO, } *Auditors.*  
 J. S. BROWN, }

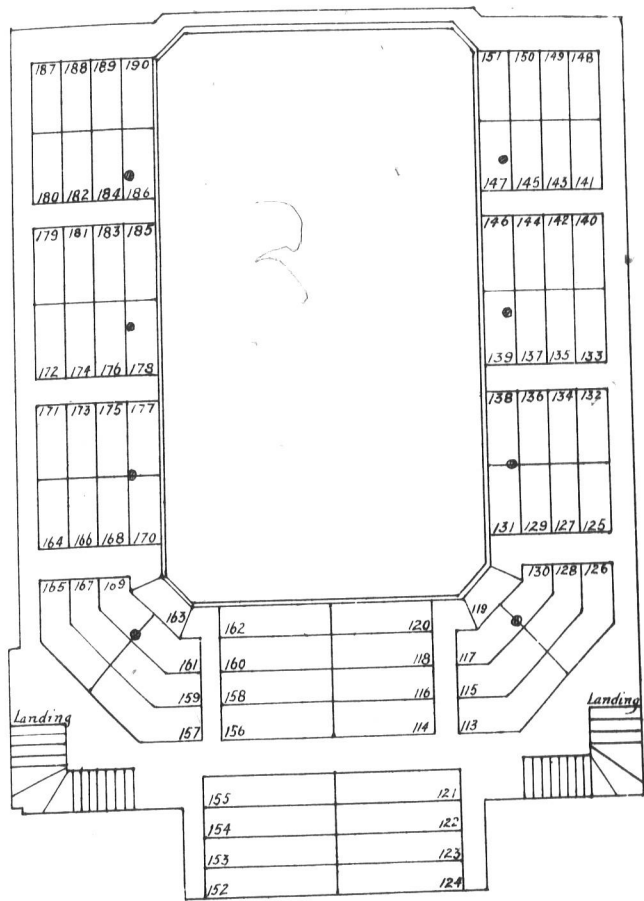

PLAN OF GALLERY.

*Plan of Ground Floor on inside of Front Cover.*