

PAUL JONES. Written by H. B. Farnie. Music by H. B. Farnie. New opera. Operatic vocal.

THE HARMONY CLUB. Of Gilbert and Sullivan's Comic Opera, 'THE PIRATES OF PENZANCE.'

Juch-Perotti FESTIVAL. The Greatest Musical Event in the History of Toronto.

GILMORE'S Mammoth Jubilee Festival. The Famous New York Band.

CONSERVATORY STRING QUARTET CLUB. Assisted by Miss Severn, Mrs. Dorset, Birkhead, and Mrs. F. C. D. D.

CALISTHENIC EXHIBITION. THREE ENTERTAINMENTS. In aid of the Building Fund of the Protestant Orphan Home.

WOODBINE Driving Club. SPRING MEETING, WEDNESDAY AND THURSDAY, MAY 19 AND 20.

WOODBINE Driving Club. PROGRAM: First day, Wednesday, June 15—First race, Woodbine.

Try Nasmith's. No. 100, King-street East.

PROPERTIES FOR SALE. BRATTLEBERRY RESERVE. 100 acres of land.

THE MORTGAGE SALE. BY OLIVER, COATE & CO. Auctioneers.

THE MORTGAGE SALE. BY OLIVER, COATE & CO. Auctioneers.

THE MORTGAGE SALE. BY OLIVER, COATE & CO. Auctioneers.

THE MORTGAGE SALE. BY OLIVER, COATE & CO. Auctioneers.

THE MORTGAGE SALE. BY OLIVER, COATE & CO. Auctioneers.

THE MORTGAGE SALE. BY OLIVER, COATE & CO. Auctioneers.

THE MORTGAGE SALE. BY OLIVER, COATE & CO. Auctioneers.

THE MORTGAGE SALE. BY OLIVER, COATE & CO. Auctioneers.

THE MORTGAGE SALE. BY OLIVER, COATE & CO. Auctioneers.

THE MORTGAGE SALE. BY OLIVER, COATE & CO. Auctioneers.

THE MORTGAGE SALE. BY OLIVER, COATE & CO. Auctioneers.

THE MORTGAGE SALE. BY OLIVER, COATE & CO. Auctioneers.

THE MORTGAGE SALE. BY OLIVER, COATE & CO. Auctioneers.

THE MORTGAGE SALE. BY OLIVER, COATE & CO. Auctioneers.

THE MORTGAGE SALE. BY OLIVER, COATE & CO. Auctioneers.

THE MORTGAGE SALE. BY OLIVER, COATE & CO. Auctioneers.

THE MORTGAGE SALE. BY OLIVER, COATE & CO. Auctioneers.

OLIVER, COATE & CO. ESTABLISHED 1834. AUCTIONEERS, VALUATORS, ARBITRATORS, REAL ESTATE AGENTS.

THE MORTGAGE SALE. BY OLIVER, COATE & CO. Auctioneers.

THE MORTGAGE SALE. BY OLIVER, COATE & CO. Auctioneers.

THE MORTGAGE SALE. BY OLIVER, COATE & CO. Auctioneers.

THE MORTGAGE SALE. BY OLIVER, COATE & CO. Auctioneers.

THE MORTGAGE SALE. BY OLIVER, COATE & CO. Auctioneers.

THE MORTGAGE SALE. BY OLIVER, COATE & CO. Auctioneers.

THE MORTGAGE SALE. BY OLIVER, COATE & CO. Auctioneers.

THE MORTGAGE SALE. BY OLIVER, COATE & CO. Auctioneers.

CHURCH SERVICES. BOND-STREET CHURCH. REV. JOS. WILD, D. D., PASTOR.

NOTICE TO CREDITORS. THE MATTER OF JOHN OWENS WOOD.

NOTICE TO CREDITORS. THE MATTER OF WILLIAM DEAN.

NOTICE TO CREDITORS. THE MATTER OF RICHARD W. HILL.

NOTICE TO CREDITORS. THE MATTER OF RICHARD W. HILL.

NOTICE TO CREDITORS. THE MATTER OF RICHARD W. HILL.

NOTICE TO CREDITORS. THE MATTER OF RICHARD W. HILL.

NOTICE TO CREDITORS. THE MATTER OF RICHARD W. HILL.

NOTICE TO CREDITORS. THE MATTER OF RICHARD W. HILL.

Bank of Montreal. NOTICE is hereby given that a dividend of five per cent.

IMPERIAL BANK OF CANADA. DIVIDEND TO BE PAID.

THE MANUFACTURERS' LIFE AND ACCIDENT INSURANCE COMPANY.

GLASGOW & LONDON INSURANCE COMPANY.

THE TRUSTS CORPORATION. OFFICES: 23 TORONTO STREET.

THE TORONTO GENERAL TRUSTS CO. 23 AND 25 WELLINGTON ST. EAST.

TORONTO HUMAN SOCIETY. OFFICE, 103 BAY ST. Telephone 1900.

THE TORONTO POSTAL GUIDE. DURING THE MONTH OF MAY, 1899.

THE TORONTO POSTAL GUIDE. DURING THE MONTH OF MAY, 1899.

WILLIAMS PIANOS. Endorsed by the best authorities in the world.

THE PARMELEE ROOFING AND PAVING CO. 143 YONGE STREET, TORONTO.

WILSON'S CELEBRATED ISLAND HOME MADE BREAD.

DERBY SWEEP. 171 ENTRIES.

THE GRENADIER ICE CO. 33 SCOTT STREET, TORONTO.

VIKARS & SMILY. Real Estate, Loan and Insurance Agents.

THE BUSSILL, OTTAWA. THE PALACE HOTEL.

ST. LAWRENCE HALL. 125 TO 129 St. James Street, Montreal.

Healing the Sick. BY THE "LAYING ON OF HANDS."

THESE NOBLE BUILDINGS.

THE CITIZENS WILL VOTE THE MONEY FOR THEIR REJECTION.

The Bylaw Will be Carried Beyond a Doubt...

The change in public opinion has been brought about by the considerations...

The spending of so much money among our shopkeepers and laboring classes...

A large number of leading men who declared recently against the bylaw...

Mr. John Y. Reid of Dunlop, Reid & Co. "I think it ought to be carried...

Mr. C. J. Holman of Messrs. Holman & Co. "I am very favorable indeed to the bylaw...

West York License Commissioner Morgan: "Of course I'll vote for it, and I'm sure that the vote in St. Albans' Ward will be 3 to 1 in favor of it..."

On call yesterday as the Board of Trade...

Mr. D. Barwick: "Will I vote for the bylaw? Of course I will, and work for it, too."

Mr. John Scully: "I have four votes for the bylaw, and I think I can fetch in a good many more..."

Mr. E. Ald. Piper: "You can put me down as a writer and a voter for the bylaw."

Mr. M. McConnell: "I have four votes and they will all go into the ballot box for the bylaw."

Mr. R. Hickson of the Adirondacs: "I will be there with three votes for the bylaw."

Editor World: Allow me to say a few words in favor of the new court house...

Probably thousands of people in this section of the country, and this section is no exception to any other...

Mr. H. H. Warner has placed in my possession the formulae of the several medicines manufactured and sold under the general designation of "Warner's Safe Remedies..."

Analyst of Foods and Medicines, New York State Board of Health, Professor of Chemistry in the Rochester, N. Y., University.

Chemical Laboratory, 100 North Second Street, Rochester, N. Y.

Mr. H. H. Warner has placed in my possession the formulae of the several medicines manufactured and sold under the general designation of "Warner's Safe Remedies..."

Analyst of Foods and Medicines, New York State Board of Health, Professor of Chemistry in the Rochester, N. Y., University.

Chemical Laboratory, 100 North Second Street, Rochester, N. Y.

Mr. H. H. Warner has placed in my possession the formulae of the several medicines manufactured and sold under the general designation of "Warner's Safe Remedies..."

Analyst of Foods and Medicines, New York State Board of Health, Professor of Chemistry in the Rochester, N. Y., University.

Chemical Laboratory, 100 North Second Street, Rochester, N. Y.

Mr. H. H. Warner has placed in my possession the formulae of the several medicines manufactured and sold under the general designation of "Warner's Safe Remedies..."

Analyst of Foods and Medicines, New York State Board of Health, Professor of Chemistry in the Rochester, N. Y., University.

Chemical Laboratory, 100 North Second Street, Rochester, N. Y.

Mr. H. H. Warner has placed in my possession the formulae of the several medicines manufactured and sold under the general designation of "Warner's Safe Remedies..."

Analyst of Foods and Medicines, New York State Board of Health, Professor of Chemistry in the Rochester, N. Y., University.

Chemical Laboratory, 100 North Second Street, Rochester, N. Y.

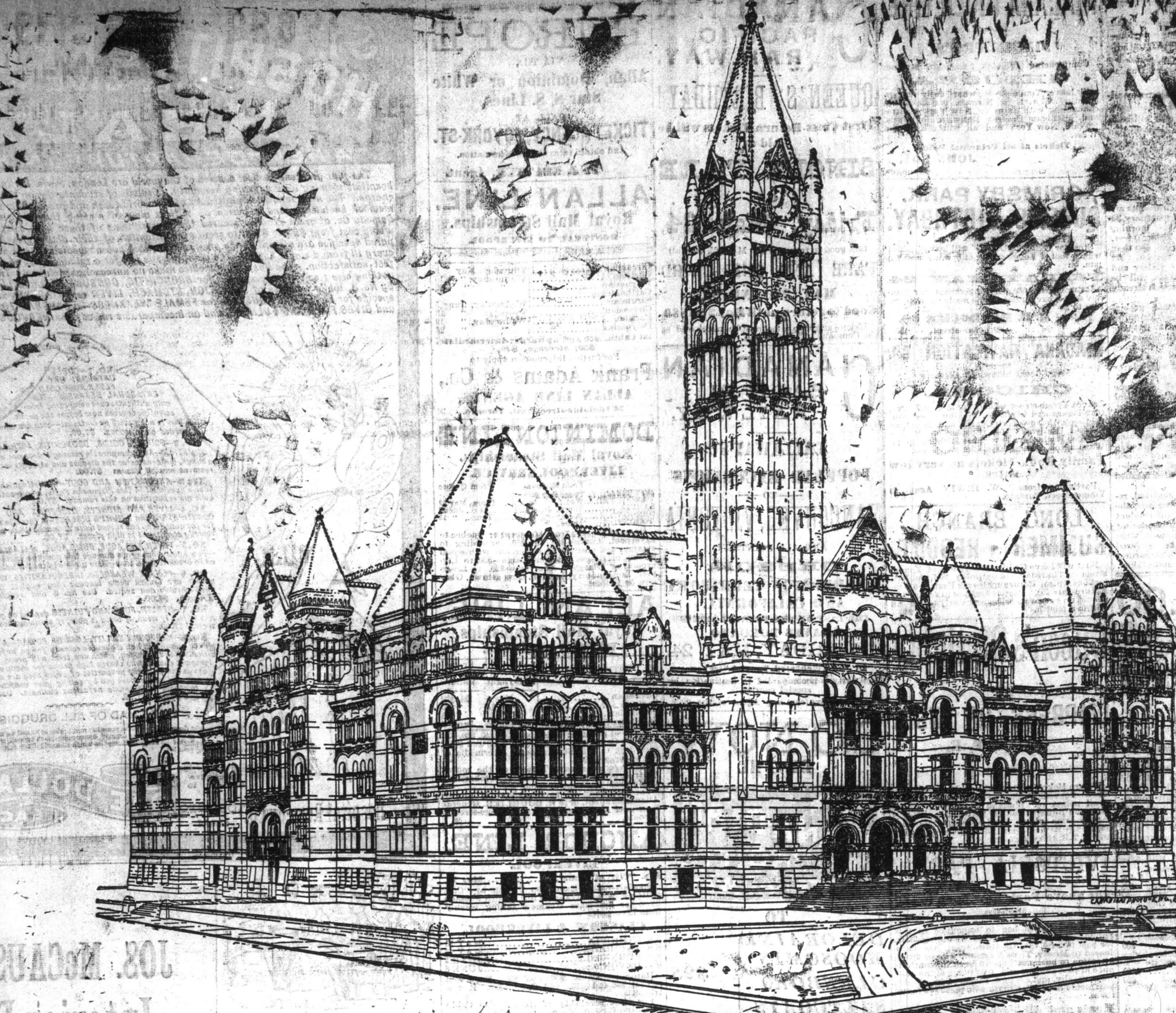

THE PROPOSED NEW COURT HOUSE AND CITY BUILDINGS. THE MONEY FOR WHICH THE RATEPAYERS WILL VOTE TO-DAY.

GAMBLING ON A GREEN SWARD.

The Upper Canada College Boys Have Their Annual Athletic Sports.

The annual sports of Upper Canada College were held yesterday afternoon, with the exception of half-a-dozen events...

The prizes were the Lieut. Colonel's, the Minister of Education, the Board of Trustees, and the Principal.

Great interest was manifested in the various events. The patrons were the Lieut. Colonel, the Minister of Education, the Board of Trustees, and the Principal.

A special prize presented by Miss Marjorie Campbell for the highest number of points in open competition was won by P. H. L.

The winners on Wednesday and yesterday were: Bowling cricket ball—W. P. Parker, 47; 100 yards dash—J. E. Pearson, 21.3; 200 yards dash—J. E. Pearson, 42.3; 400 yards dash—J. E. Pearson, 1.07.5; 800 yards dash—J. E. Pearson, 2.15.5; 1,600 yards dash—J. E. Pearson, 4.31.5; 3,200 yards dash—J. E. Pearson, 8.53.5; 6,400 yards dash—J. E. Pearson, 17.47.5; 12,800 yards dash—J. E. Pearson, 35.34.5; 25,600 yards dash—J. E. Pearson, 70.53.5; 51,200 yards dash—J. E. Pearson, 141.47.5; 102,400 yards dash—J. E. Pearson, 283.34.5; 204,800 yards dash—J. E. Pearson, 566.53.5; 409,600 yards dash—J. E. Pearson, 1133.47.5; 819,200 yards dash—J. E. Pearson, 2267.34.5; 1,638,400 yards dash—J. E. Pearson, 4534.53.5; 3,276,800 yards dash—J. E. Pearson, 9069.07.5; 6,553,600 yards dash—J. E. Pearson, 18138.14.5; 13,107,200 yards dash—J. E. Pearson, 36276.28.5; 26,214,400 yards dash—J. E. Pearson, 72552.57.5; 52,428,800 yards dash—J. E. Pearson, 145105.14.5; 104,857,600 yards dash—J. E. Pearson, 290210.28.5; 209,715,200 yards dash—J. E. Pearson, 580420.57.5; 419,430,400 yards dash—J. E. Pearson, 1160841.14.5; 838,860,800 yards dash—J. E. Pearson, 2321682.28.5; 1,677,721,600 yards dash—J. E. Pearson, 4643364.57.5; 3,355,443,200 yards dash—J. E. Pearson, 9286728.14.5; 6,710,886,400 yards dash—J. E. Pearson, 18573456.28.5; 13,421,772,800 yards dash—J. E. Pearson, 37146912.57.5; 26,843,545,600 yards dash—J. E. Pearson, 74293825.14.5; 53,687,091,200 yards dash—J. E. Pearson, 148587650.28.5; 107,374,182,400 yards dash—J. E. Pearson, 297175300.57.5; 214,748,364,800 yards dash—J. E. Pearson, 594350600.14.5; 429,496,729,600 yards dash—J. E. Pearson, 1188701200.28.5; 858,993,459,200 yards dash—J. E. Pearson, 2377402400.57.5; 1,717,986,918,400 yards dash—J. E. Pearson, 4754804800.14.5; 3,435,973,836,800 yards dash—J. E. Pearson, 9509609600.28.5; 6,871,947,673,600 yards dash—J. E. Pearson, 19019219200.57.5; 13,743,895,347,200 yards dash—J. E. Pearson, 38038438400.14.5; 27,487,786,694,400 yards dash—J. E. Pearson, 76076876800.28.5; 54,975,573,388,800 yards dash—J. E. Pearson, 152153753600.57.5; 109,951,146,777,600 yards dash—J. E. Pearson, 304307507200.14.5; 219,902,293,555,200 yards dash—J. E. Pearson, 608615014400.28.5; 439,804,587,110,400 yards dash—J. E. Pearson, 1217230028800.57.5; 879,609,174,220,800 yards dash—J. E. Pearson, 2434460057600.14.5; 1,759,218,348,441,600 yards dash—J. E. Pearson, 4868920115200.28.5; 3,518,436,696,883,200 yards dash—J. E. Pearson, 9737840230400.57.5; 7,036,873,393,766,400 yards dash—J. E. Pearson, 19475680460800.14.5; 14,073,746,787,532,800 yards dash—J. E. Pearson, 38951360921600.28.5; 28,147,493,575,065,600 yards dash—J. E. Pearson, 77902721843200.57.5; 56,294,987,150,131,200 yards dash—J. E. Pearson, 155805437686400.14.5; 112,589,974,300,262,400 yards dash—J. E. Pearson, 311610875372800.28.5; 225,179,948,600,524,800 yards dash—J. E. Pearson, 623221750745600.57.5; 450,359,897,201,049,600 yards dash—J. E. Pearson, 1246443501491200.14.5; 900,719,794,402,099,200 yards dash—J. E. Pearson, 2492887002982400.28.5; 1,801,439,588,804,198,400 yards dash—J. E. Pearson, 4985774005964800.57.5; 3,602,879,177,608,396,800 yards dash—J. E. Pearson, 9971548011929600.14.5; 7,205,758,355,216,793,600 yards dash—J. E. Pearson, 19943096023859200.28.5; 14,411,516,710,433,587,200 yards dash—J. E. Pearson, 39886192047718400.57.5; 28,823,033,420,867,174,400 yards dash—J. E. Pearson, 79772384095436800.14.5; 57,646,066,841,734,348,800 yards dash—J. E. Pearson, 159544768190873600.28.5; 115,292,133,683,468,697,600 yards dash—J. E. Pearson, 319089536381747200.57.5; 230,584,267,366,937,395,200 yards dash—J. E. Pearson, 638179072763494400.14.5; 461,168,534,733,874,790,400 yards dash—J. E. Pearson, 1276358145266988800.28.5; 922,337,069,467,749,580,800 yards dash—J. E. Pearson, 2552716290533977600.57.5; 1,844,674,138,935,499,161,600 yards dash—J. E. Pearson, 5105432581067955200.14.5; 3,689,348,277,870,998,323,200 yards dash—J. E. Pearson, 10210865162135110400.28.5; 7,378,696,555,741,996,646,400 yards dash—J. E. Pearson, 20421730324270220800.57.5; 14,757,393,111,483,993,292,800 yards dash—J. E. Pearson, 40843460648540441600.14.5; 29,514,782,222,967,986,585,600 yards dash—J. E. Pearson, 81686921297080883200.28.5; 59,029,564,445,935,973,171,200 yards dash—J. E. Pearson, 163373842594161766400.57.5; 118,059,128,891,871,946,342,400 yards dash—J. E. Pearson, 326747685188323532800.14.5; 236,118,257,783,743,892,684,800 yards dash—J. E. Pearson, 653495370376647065600.28.5; 472,236,515,567,487,787,369,600 yards dash—J. E. Pearson, 1306990740753294131200.57.5; 944,473,031,134,975,574,774,739,200 yards dash—J. E. Pearson, 2613981481506588262400.14.5; 1,888,946,062,269,951,149,549,548,468,800 yards dash—J. E. Pearson, 5227962963013176524800.28.5; 3,777,892,124,539,902,299,099,097,017,737,600 yards dash—J. E. Pearson, 10455925926026353049600.57.5; 7,555,784,249,079,804,598,198,198,434,435,200 yards dash—J. E. Pearson, 20911851852052706099200.14.5; 15,111,568,498,159,609,196,396,396,870,430,400 yards dash—J. E. Pearson, 41823703704105412198400.28.5; 30,223,136,996,319,219,392,792,792,740,860,800 yards dash—J. E. Pearson, 83647407408210824396800.57.5; 60,446,273,992,638,438,784,585,585,541,721,600 yards dash—J. E. Pearson, 16729481481642164793600.14.5; 120,892,547,985,276,877,577,171,171,083,443,200 yards dash—J. E. Pearson, 33458962963284329587200.28.5; 241,785,095,970,553,755,154,342,342,166,886,400 yards dash—J. E. Pearson, 66917925926568659174400.57.5; 483,570,191,941,107,510,308,688,688,333,772,800 yards dash—J. E. Pearson, 1338358518513731835200.14.5; 967,140,383,882,215,021,617,217,217,067,545,600 yards dash—J. E. Pearson, 2676717037027463670400.28.5; 1,934,280,767,764,430,434,434,434,134,615,200 yards dash—J. E. Pearson, 5353434074054927340800.57.5; 3,868,561,535,528,860,868,868,868,269,230,400 yards dash—J. E. Pearson, 10706868148109654681600.14.5; 7,737,123,071,057,721,737,721,737,538,460,800 yards dash—J. E. Pearson, 21413736296219309363200.28.5; 15,474,246,142,114,443,443,443,443,076,921,600 yards dash—J. E. Pearson, 42827472592438618726400.57.5; 30,948,492,284,288,886,886,886,886,153,843,200 yards dash—J. E. Pearson, 85654945184877237452800.14.5; 61,896,984,568,577,773,773,773,773,307,686,400 yards dash—J. E. Pearson, 171309890369754474905600.28.5; 123,793,969,137,155,546,546,546,546,615,372,800 yards dash—J. E. Pearson, 342619780739508949811200.57.5; 247,587,938,274,311,091,091,091,091,230,745,600 yards dash—J. E. Pearson, 685239561479017899622400.14.5; 495,175,876,548,622,182,182,182,182,461,491,200 yards dash—J. E. Pearson, 1370479122958035799244800.28.5; 990,351,753,097,244,364,364,364,364,922,982,400 yards dash—J. E. Pearson, 2740958255916071598489600.57.5; 1,980,703,506,488,728,728,728,728,184,594,800 yards dash—J. E. Pearson, 5481916511832143196979200.14.5; 3,961,407,012,977,457,457,457,457,369,189,600 yards dash—J. E. Pearson, 10963833023664286393958400.28.5; 7,922,814,025,954,914,914,914,914,738,379,200 yards dash—J. E. Pearson, 21927666047328572787916800.57.5; 15,845,628,051,909,829,829,829,829,476,758,400 yards dash—J. E. Pearson, 43855332094657145575833600.14.5; 31,691,256,103,819,659,659,659,659,953,516,800 yards dash—J. E. Pearson, 87710664189314291151667200.28.5; 63,382,512,207,639,319,319,319,319,190,703,600 yards dash—J. E. Pearson, 175421328378285823303334400.57.5; 126,765,024,415,278,638,638,638,638,381,407,200 yards dash—J. E. Pearson, 350842656756571646606668800.14.5; 253,530,048,830,557,277,277,277,277,762,814,400 yards dash—J. E. Pearson, 701685313513143293213337600.28.5; 507,060,097,661,114,554,554,554,554,152,562,800 yards dash—J. E. Pearson, 1403370627026286586426675200.57.5; 1,014,120,195,322,229,111,111,111,305,125,600 yards dash—J. E. Pearson, 2806741254052573172853350400.14.5; 2,028,240,390,644,458,222,222,222,222,610,251,200 yards dash—J. E. Pearson, 5613482508105146345666700800.28.5; 4,056,480,781,288,916,444,444,444,444,122,050,400 yards dash—J. E. Pearson, 11226965016210292691334141600.57.5; 8,112,961,562,577,832,888,888,888,888,244,100,800 yards dash—J. E. Pearson, 22453930032420585382668283200.14.5; 16,225,923,125,155,665,777,777,777,777,488,201,600 yards dash—J. E. Pearson, 44907860064841170765337166400.28.5; 32,451,846,250,311,331,555,555,555,555,976,403,200 yards dash—J. E. Pearson, 89815720129682341530664332800.57.5; 64,903,692,500,622,662,111,111,111,111,195,206,400 yards dash—J. E. Pearson, 17963144025936468301332665600.14.5; 129,807,385,001,245,324,222,222,222,222,390,412,800 yards dash—J. E. Pearson, 35926288051872936602665331200.28.5; 259,614,770,002,490,648,444,444,444,444,780,825,600 yards dash—J. E. Pearson, 718525761037458732053310662400.57.5; 519,229,540,004,981,291,291,291,291,291,156,165,1200 yards dash—J. E. Pearson, 1437051522074917440106621324800.14.5; 1,038,459,080,962,582,582,582,582,582,312,330,2400 yards dash—J. E. Pearson, 2874103044149834880213242649600.28.5; 2,076,918,161,925,165,165,165,165,165,624,660,4800 yards dash—J. E. Pearson, 5748206088299669760426452998400.57.5; 4,153,836,323,850,330,330,330,330,330,124,930,9600 yards dash—J. E. Pearson, 11496412176599339208529055996800.14.5; 8,307,672,647,700,660,660,660,660,660,249,860,19200 yards dash—J. E. Pearson, 22992824353198678417058111993600.28.5; 16,615,345,284,400,132,132,132,132,132,499,720,38400 yards dash—J. E. Pearson, 45985648706397356834116183987200.57.5; 33,230,690,568,800,264,264,264,264,264,999,440,76800 yards dash—J. E. Pearson, 91971297412794713668222375974400.14.5; 66,461,381,137,600,528,528,528,528,528,1998,880,153600 yards dash—J. E. Pearson, 183942594825589473364447519948800.28.5; 132,922,762,275,200,1056,1056,1056,1056,1056,3997,760,307200 yards dash—J. E. Pearson, 367885189651178946728895039897600.57.5; 265,845,524,550,400,2112,2112,2112,2112,2112,7995,520,614400 yards dash—J. E. Pearson, 735770379302357893457790079795200.14.5; 531,691,049,100,800,4224,4224,4224,4224,4224,15990,040,1228800 yards dash—J. E. Pearson, 147154075860471578691555159590400.28.5; 1,063,382,098,201,600,8448,8448,8448,8448,8448,31980,080,2457600 yards dash—J. E. Pearson, 2943081517209431573831111199180800.57.5; 2,126,764,196,403,203,6896,6896,6896,6896,6896,63960,160,4915200 yards dash—J. E. Pearson, 5886163034418863147662222398361600.14.5; 4,253,528,392,806,407,3792,3792,3792,3792,3792,127920,320,9830400 yards dash—J. E. Pearson, 11773526068837726295324444796723200.28.5; 8,507,056,785,612,814,7584,7584,7584,7584,7584,255840,640,19660800 yards dash—J. E. Pearson, 2354705213767545259064888959346400.57.5; 17,014,113,571,225,628,15168,15168,15168,15168,15168,511680,1280,39321600 yards dash—J. E. Pearson, 470941042753509051812977781876800.14.5; 34,028,227,142,451,257,30336,30336,30336,30336,30336,1023360,2560,78643200 yards dash—J. E. Pearson, 941882085507018103625955563753600.28.5; 68,056,454,284,902,514,60672,60672,60672,60672,60672,2046720,5120,157286400 yards dash—J. E. Pearson, 18837641710140362073191111751507200.57.5; 136,112,908,569,805,028,121344,121344,121344,121344,121344,4093440,10240,314572800 yards dash—J. E. Pearson, 3767528342028072414623822235030400.14.5; 272,225,817,139,610,056,242688,242688,242688,242688,242688,8186880,20480,629145600 yards dash—J. E. Pearson, 7535056684056144829247644470060800.28.5; 544,451,634,279,221,105,485776,485776,485776,485776,485776,16373760,40960,1258291200 yards dash—J. E. Pearson, 1507011336811228965849528940121600.57.5; 1,088,903,268,558,442,211,1715552,1715552,1715552,1715552,1715552,32747520,81920,2516582400 yards dash—J. E. Pearson, 3014022673622457931699057880243200.14.5; 2,177,806,537,116,884,422,3431104,3431104,3431104,3431104,3431104,6549504,163840,5033164800 yards dash—J. E. Pearson, 6028045347244914863398115760486400.28.5; 4,355,613,074,333,768,864,6862208,6862208,6862208,6862208,6862208,13099008,327680,10066329600 yards dash—J. E. Pearson, 1205609069448982972679623552092800.57.5; 8,711,226,148,667,537,728,13724416,13724416,13724416,13724416,13724416,26198016,655360,20132659200 yards dash—J. E. Pearson, 2411218138897965945359247104457600.14.5; 17,422,453,297,335,475,45448832,45448832,45448832,45448832,45448832,52396032,1310720,40265318400 yards dash—J. E. Pearson, 4822436277795931890718494208915200.28.5; 34,844,906,594,670,910,90897664,90897664,90897664,90897664,90897664,104792064,2621440,80530636800 yards dash—J. E. Pearson, 9644872555591863781437888417830400.57.5; 69,689,813,189,340,182195328,182195328,182195328,182195328,182195328,2

THE ANOTHER NEW CHURCH

St Helen's of Brockton Will Cost \$40,000.—The new portion of the city it has been found necessary to build a large Roman Catholic church in the place of the small one which has been destroyed by fire.

“LADIES’ JOURNAL” BIBLE COMPETITION

Advertising is the part of the paper that yields the greatest profit. When a large circulation is reached by a journal, advertisers soon find it out and naturally try to get into its columns.

Queen's Birthday

Retiring tickets will be sold on May 24 at a fare and one third, generally to get into all points on the Welland Division, Niagara Falls and Buffalo, etc.

VICTORIA PARK

The above Park now open to the Public. The management beg to announce to the public that the restaurant has been leased to Messrs. T. J. and C. J. Smith.

CONSOLATION REWARDS

For those who do not win for any of the above rewards the following special rewards are offered to the two hundred and forty-one persons whose names come in last.

Special to the World Subscribers

I will give every subscriber of the World who will send me Fifty Cents for six months subscription to The Ladies' Journal, together with answers to the above Bible questions.

GRATEFUL-COMFORTING EPPS'S COCOA

By a thorough knowledge of the natural laws which govern the operations of digestion and nutrition, we have prepared Epps's Cocoa.

NIAGARA RIVER LINE

SINGLE TRIP. Commencing Monday, 20th inst., steamer CHIOORA will leave Toronto daily (except Sunday) at 7 a. m.

GRIMSBY PARK. QUEEN'S BIRTHDAY

Steamer "GREYHOUND" will leave Goddard's wharf, foot of Yonge-street, at 8 a. m. and 2 p. m.

NIAGARA NAVIGATION CO. CHIOORA

Leaves Toronto daily, Toronto, at 7 a. m. for Niagara and Lewiston, making close connection with New York Central and Erie Central Railways for Suspension Bridge, Buffalo, Rochester, New York, Philadelphia, Washington, Boston, Erie, Cleveland, etc.

LONG BRANCH SUMMER-RESORT

Boat will leave Goddard's wharf foot of Yonge-street on Thursday and Saturday, 19th and 21st inst. at 7 p. m.

Queen's Birthday

Retiring tickets will be sold on May 24 at a fare and one third, generally to get into all points on the Welland Division, Niagara Falls and Buffalo, etc.

EMPRESS OF INDIA AND G. T. R.

Retiring tickets will be sold on May 24 at a fare and one third, generally to get into all points on the Welland Division, Niagara Falls and Buffalo, etc.

TORONTO AND

Hamilton Steamer QUEEN'S BIRTHDAY The Palace Steamer Macassar

ATLANTIC EXPRESS SERVICE

Steamers leave Toronto, Wednesday, May 24, 1899, for New York to Glasgow and London.

Intercolonial Railway OF CANADA

The Royal Mail, Passenger and Freight Route between Canada and Great Britain, and direct routes between the west and all points on the Lower St. Lawrence and the Gulf of St. Lawrence.

SUPERIOR ELEVATOR, WAREHOUSE & DOCK ACCOMMODATION

at Halifax for shipment of grain and general merchandise. We have now handling a magnificent reproduction of this picture which surpasses anything ever offered in this line.

GRATEFUL-COMFORTING EPPS'S COCOA

By a thorough knowledge of the natural laws which govern the operations of digestion and nutrition, we have prepared Epps's Cocoa.

CANADIAN PACIFIC RAILWAY

QUEEN'S BIRTHDAY! First-Class Return Tickets will be sold at SINGLE FARE

ON FRIDAY, MAY 24, 1899, good to return until MAY 25 (and at FARE AND ONE THIRD

CANADIAN PACIFIC RAILWAY

CALLAWAY'S POPULAR EXCURSIONS TO VANCOUVER, VICTORIA AND ALL POINTS IN OREGON, WASHINGTON TERRITORY AND CALIFORNIA.

GO NOW BY THE CANADIAN PACIFIC RAILWAY

TO DELORAIN MOOSOMI GLENBORO SALTCOATS CALGARY AND RETURN.

CANADIAN PACIFIC RAILWAY

Change of Time On May 10, Trains will leave Union Station, North Side, as under

CANADIAN PACIFIC RAILWAY

On May 10, Trains will leave Union Station, North Side, as under

CANADIAN PACIFIC RAILWAY

On May 10, Trains will leave Union Station, North Side, as under

CANADIAN PACIFIC RAILWAY

On May 10, Trains will leave Union Station, North Side, as under

CANADIAN PACIFIC RAILWAY

On May 10, Trains will leave Union Station, North Side, as under

CANADIAN PACIFIC RAILWAY

On May 10, Trains will leave Union Station, North Side, as under

CANADIAN PACIFIC RAILWAY

On May 10, Trains will leave Union Station, North Side, as under

EUROPE

FOR TICKETS TO OR FROM EUROPE VIA THE Allan, Dominion or White Star S. S. Lines,

ALLAN LINE

Royal Mail Steamships. MONTREAL TO LIVERPOOL. STEAMERS: From Montreal, Thursday, May 18, 1899.

DOMINION LINE

Royal Mail Steamships. LIVERPOOL SERVICE. MONTREAL TO LIVERPOOL. STEAMERS: From Montreal, Thursday, May 18, 1899.

ALLAN LINE

Royal Mail Steamships. WINTER SAILINGS. STEAMERS: From Montreal, Thursday, May 18, 1899.

ANCHOR LINE

LIVERPOOL. S. S. "City of Rome" May 23. Special-Saloon Excursion Tickets by "City of Rome" will be available for Return Passage to Liverpool.

ALLAN LINE

Royal Mail Steamships. FOR LONDON DIRECT. The steamer "SERRANUS", 4000 tons, will leave Montreal on Thursday, May 23, for London.

WHITE STAR LINE

ROYAL MAIL STEAMERS. NEW YORK TO LIVERPOOL, EVERY WEDNESDAY. May 15, 4 p. m. Celtic, 22, noon.

GUNARD S. S. LINE

NOTED FOR SAFETY, ELEGANCE and SPEED. Tri-Weekly between NEW YORK, BOSTON and QUEENS-TOWN and LIVERPOOL.

ANCHOR LINE

LIVERPOOL. S. S. "City of Rome" May 23. Glasgow and Liverpool.

STATES S. LINE

TORONTO TO GLASGOW. 1st CABIN \$46.10 Single. 1st CABIN \$87.20 Return.

PARIS EXCURSION

INCLUDING EVERYTHING. LONDON, PARIS \$165. Ocean Travel, Railway Fares, Hotel Bills, Carriage Hire—\$3-days' Tour from TORONTO.

DEBRODIE'S \$1 HOSPITAL REMEDIES. WILL GIVE YOU HEALTH! A NEW DEPARTURE IN MEDICINE

The four greatest medical centres of the world are London, Paris, Berlin and Vienna. These cities have immense hospitals teeming with suffering humanity.



TO BE HAD OF ALL DRUGGISTS. If you doubt the efficacy of these remedies, send for a trial bottle.

JOS. McCAUSLAND & SON, Interior Decorators

Are showing a Highly Select-Assortment of WALL AND CEILING PAPERS AT ALL PRICES.

M. STAUNTON & CO., Fine Wall Papers

GEILING DECORATIONS! We are now showing an Entirely New and Complete Line of -WALL HANGINGS-

SEEDS

W. BAKER & CO.'S Breakfast Cocoa. It is absolutely pure and contains no chemicals.

WHITE & PETTER

Low Lines Swiss Check Muslins, Black and White Brussels Nets, White, Black and Colored Illusions, Black Chantilly Veilings.

WHITE & PETTER

FOR MEN ONLY! POSITIVE FOR LOSS OF HAIR, WEAKNESS OF BODY AND MIND.

STORAGE

GOOD CLEAN FLAT FOR FURNITURE. Charges Moderate. R. CARRIE, 27 FRONT-ST. EAST.

THE TORONTO WORLD

Advertisements in this paper are placed at the rate of 10 cents per line per week.

UPHOLSTERY

At prices to suit the house in.

CURTAINS

At prices to suit the house in.

WATER

At prices to suit the house in.

TAKE THE GRAN

At prices to suit the house in.

HATS, HATS

At prices to suit the house in.

WORTHY OF BROW

At prices to suit the house in.

HAMILTON SEWER

At prices to suit the house in.

HAMILTON

At prices to suit the house in.

WARTY

At prices to suit the house in.

DR. M

At prices to suit the house in.

DEER PARK PROPERTY,
MERTON & BALLIOL-STS.
ABOUT A DOZEN EXCELLENT LOTS LEFT.
Eight Dollars a Foot.
EASY TERMS. ONLY \$1 A FOOT DOWN.

We have arranged with the American Rattan Co. of Toronto for the sale of their goods in the West End, and they are making for us exclusively a few lines which we lead at very close prices.

CARPETS,
Curtains, Etc.
At prices equal to any house in the city.

467-471 QUEEN-ST. WEST.
Telephone 1195.

MUSIC
AT 5 CTS. A COPY.
5000 Pieces of Sheet Music
Reduced to 5c. a Copy.
300 Waltzes by Strauss, W. & J. Strauss, etc.
1500 Piano Solos by the best composers.
100 Songs by Mollay, Sullivan, Adams, etc.
Call early and make selections.
5 pieces for 25c., 12 for 50c., and 25 for \$1.
BUTLAND'S MUSIC STORE,
27 King-street West. 248

PAPER WAREHOUSE.
FULL STOCK,
ALL KINDS,
NEW LINES.
EXTRA GOOD VALUE.
WORTHY OF SPECIAL NOTICE
BROWN BROS.,
61 to 63 King-street East, Toronto.

HAMILTON and TORONTO
SEWER PIPE COMPANY.
Manufacturers Steam Pressed, Salt-Glazed
Highly Verified Sewer Pipes. 248
HEAD OFFICE:
HAMILTON, CANADA.
A. E. CARPENTER, J. H. NEW, HENRY NEW,
Pres. Vice-Pres. Sec. Treas.

WARTY CANCER



DR. McCULLY.

This out represents Mrs. White of 27 McCull-street, Toronto. She was troubled by the dear old wart on her forehead. It was in her way and she had to have it removed. She was told to have it removed by the use of the knife, but she was told that it would be a long and painful process. She was told that it would be a long and painful process. She was told that it would be a long and painful process.

DR. McCULLY,
285 JARVIS-ST., TORONTO

INJECTION HYDRASTIS
EMULSION WHITE SANDAL OIL
ALL DRUGGISTS

THE SIGNAL OF SUCCESS.
BELL
25 YEARS IN BUSINESS.
50,000 INSTRUMENTS IN USE.
Upright Pianos
Cabinet Organs
ARE ACKNOWLEDGED BY LEADING MUSICIANS
TO BE STRICTLY FIRST-CLASS.
Our Large Pedal Organs and Chapel Styles
Are better for medium and small-sized churches than Pipe Organs or Vocalions and at half the cost. They contain Scribner's Qualifying Tubes, of which patent we have been the sole owners for 15 years past, and the patent having lapsed has now become public property.

All intending purchasers should see our instruments and get prices. Catalog free.
W. BELL & CO.,
GUELPH, ONTARIO.

BRANCH WAREHOUSES:
19 King-st. West, Toronto, Ont.
44 James-st. North, Hamilton, Ont.
321 Talbot-st., St. Thomas, Ont.

Corset
The Perfection of Shape, Finish and Durability, and approved by the whole polite world.
OVER 5,000,000 ALREADY SOLD. To be had of all dealers throughout Canada.
W. S. THOMSON & CO. Ltd., London, Manufacturers.
See that every Corset is marked "THOMSON'S GLOVE-FITTING" and bears our Trade Mark, the Crown.
WHITE & WHITE, Wholesale Agents, TORONTO.

Confederation Life
TORONTO.
THE HOME COMPANY.
OVER \$3,500,000 ASSETS
AND CAPITAL.
SIR W. F. HOWLAND, President.
W. M. ELLIOT, Vice-President.
J. E. MACDONALD, Managing Director.

North American Life Assurance Co.
INCORPORATED BY SPECIAL ACT OF DOMINION PARLIAMENT.
HEAD OFFICE, TORONTO, ONT.
PRESIDENT—Hon. A. Mackenzie, M.P., Ex-Prime Minister of Canada.
VICE-PRESIDENTS—Hon. A. Morris, John L. Blackie.
MANAGING DIRECTOR, William McCabe, F.L.A., Eng.

The North American Life Assurance Company issues an Investment Policy, which in the event of death guarantees the return of all Premiums paid, in addition to the full amount of the Policy, at a Lower Rate than any other Company.

BRYCE'S PAVEMENT
Is the Best and Cheapest Pavement now in existence for SIDEWALKS, CELLARS, GARDEN WALKS, STABLES AND BREWERY FLOORS.
We will be pleased to receive your orders at an early date. For particulars apply to
BRYCE BROS.
HEAD OFFICE—280 KING-ST. EAST, TORONTO.

WINDOW SHADES.
MACFARLANE, McKINLAY & CO.
—HEADQUARTERS FOR—
PLAID STORE SHADES, SPRING ROLLERS,
SHADE FRINGES, SHADE TASSELS.
Forty Colorings of Shade Cloth, 37 to 90 in. 300 Handsome Patterns Decorated shades.
Patentees of the Wyant Shade Fastener. No tacks required.
OFFICE AND FACTORY, 31 and 33 WELLESLEY-STREET WEST.

M'COLL BROS. & CO., TORONTO
Manufacturers of and Wholesale Dealers in the Following Specials
Lardine | Wool | OILS.
Cylinder | Bolt Cutting | OILS.
Red Engine | Eureka

Try Our Lardine Machine and You Will Use No Other.
M'COLL BROS. & CO., TORONTO, ONT.

DR. HODDER'S
Special Remedy
—FOR—
Female Weaknesses
A safe and reliable remedy for all these weaknesses and complaints peculiar to females. Cures all diseases of the Kidneys and Urinary Organs. For sale by all Druggists. Price 50c.
HODDER MEDICINE COMPANY, PROPRIETORS, TORONTO.

THE CHAS. ROGERS & SONS Co.
LIMITED
LATE OF R. HAY & CO.
MANUFACTURERS OF
FINE FURNITURE.
NEW DESIGNS
Drawing Room Suites, Dining Room
Suites, Bedroom Suites, also some
Specially Fine Hall Stands.
WAREHOUSES 95 & 97 YONGE-ST., TORONTO

THE CANADA SUGAR REFINING COMPANY,
(Limited) MONTREAL.
OFFER FOR SALE ALL GRADES OF REFINED SUGARS AND SYRUPS OF THE WELL-KNOWN BRAND OF
Redpath
CERTIFICATES OF STRENGTH AND PURITY.
OFFICE OF THE PUBLIC ANALYST, MONTREAL, September 9th, 1892.
To the Canada Sugar Refining Co., Montreal.
Gentlemen—I have personally taken samples from a large stock of your "Redpath" Sugar, and have analyzed them by the Polariscopes, and I find them to be as pure as to be as near to absolute purity as can be obtained by any process of Sugar Refining.
The test by the Polariscopes showed in Toronto that the yield was 98.30 per cent. of Pure Cane Sugar, which may be considered commercially as ABSOLUTELY PURE SUGAR.
JOHN BAKER EDWARDS,
F.L.S., D.C.L., F.C.S.,
Public Analyst for the District of Montreal, and Professor of Chemistry.

DYEING AND CLEANING.
Lace Curtains dyed or cleaned, Gent's Hosiery Overdyeing and Suits dyed or cleaned, Ladies' Dresses, Jackets, &c., dyed or cleaned, at the best in the city.
STOCKWELL, KENNEDY & BLAKE
103 King-street West. All work done on the premises.
TELEPHONE 1295.

M. Y. Lubon's Specific No. 3
A POSITIVE CURE. A PAINFUL CURE.
The Patent Age of New Invention.
FACTS FOR MEN OF ALL AGES
DISEASES OF MAN I
The great Health Restorer, Marvel of Healing and Reliance of Medication.
It cures Gonorrhoea, Syphilis, and all other Venereal Diseases, and restores the system to its normal condition.
CURES
YOUNG, MIDDLE-AGED & OLD MEN
Who are Broken Down from the Effects of Abuse, will find in No. 3 a Relief from their Venereal Disease, Gonorrhoea, Syphilis, etc. Send your Address and get an Answer for Free in Plain English on Demand of High Quality. M. Y. LUBON, 27 Wellington St. E. Toronto, Ont. A man without venereal disease is a healthy man. A PREVENTIVE CURE. ONE TRIAL IS A PAINFUL CURE.

MIMICO
WE ARE STILL OFFERING
LOTS FOR SALE
IN SMALL OR LARGE PARCELS IN THE
MOONEY ESTATE
—AT THE—
ORIGINAL PRICES.
Since placing this property on the market two months ago we have sold nearly eight thousand feet, mostly in small parcels. A lot will cost
\$300.00,
One-quarter Cash, Balance at 6 per cent.

Our Mr. Minkler has just returned from a tour through the principal cities lying between Toronto and the Pacific Coast and after a careful examination of the values of
SUBURBAN TOWNS
Of other cities we venture the prediction that a three hundred dollar lot purchased from us now will produce one thousand dollars within 5 years.

TORRENS TITLE.
A. E. Minkler & Co.
4 KING-ST. EAST.

THE BARBER & ELLIS COMPY,
BOOKBINDERS.
ACCOUNT BOOKS
MADE TO ORDER.
Merchants, Bankers, Insurance Companies, &c., requiring Books for the New Year should Order Now. Paper of the Best Quality. Workmanship Unsurpassed. Apply to
Nos. 43, 45, 47 AND 49 BAY-STREET, TORONTO, ONT.

MEN'S FURNISHINGS DEPARTMENT.
LARGE SHIPMENTS
OF
NEW SCARFS AND TIES.
BEING PASSED INTO STOCK.
SAMSON, KENNEDY & CO.,
44 Scott and 19 Colborne-sts., Toronto, 25 Old Change, London, Eng.

CONGER COAL CO.
FIRST CLASS
Wilkesbarre and Scranton Coal
BEST QUALITY HARD AND PINE WOOD
AT LOWEST PRICES.
OFFICES: 6 King-street East, DOCKS: (Esplanade-st. West, Foot of Lorne-street, 674 Yonge-street.

Villa Lots for Sale.
Hotel Summer Cottages
Pleasant Camping To Rent
Grounds
LONG BRANCH
SUMMER RESORT.
SPECIAL advantages in the location of cottages for the coming season can be secured by parties purchasing at once.

DUNLAP & COMPANY'S SILK AND FELT HATS!

W. & D. DINEEN, TORONTO, SOLE AGTS. FOR ONT.

Now opened up and IN STOCK all the NEW STYLES for the Spring and Summer. Heath's West End London Hats —we are also sole agents in Canada. Tress & Co., Woodrow & Sons, Carrington & Co., and Christy Co. high standard English Hats are also kept in large quantities. Ladies' Silk and Felt Riding Hats, Boating Caps, Deerstalkers, Tennis Caps and Hats, English and American Straw Hats for Ladies and Gentlemen. The Regulation Yacht Club Cap just received,—members should select sizes now. Children's Sailor Hats, in Plain and Fancy Straw, imported direct from the Makers in England. Over One Hundred Dozen of Fancy Caps (one peak) for Ladies, Gentlemen and Children, in plain tweeds, checks, chevots, heather mixtures, plain white, navy blue, cardinal and other flannels. Cricket Caps in all the Club Colors. The public should note that we are the largest Retail Importers of Hats in this city, and our buying power places us in a position to purchase from first hands. Our customers get this advantage—Goods are marked Retail as low as they can be bought Wholesale in Toronto or Montreal. Goods delivered to any part of the City and Suburbs. One Price and Cash Only.

W. & D. DINEEN, COR. KING AND YONGE-STREETS, TORONTO.

THE MILLS ESTATE.

CHOICE BUILDING LOTS ON
PAPE-AVE., IN THE WARD OF ST. MATTHEW

This plan represents a valuable piece of property situated at the head of Pape-avenue in the Ward of St. Matthew, beautifully located and overlooking the city and lake. It is one of the driest and most healthy districts of Toronto, having a perfect and natural drainage, being situated about two hundred feet above the level of the lake.

Pape-avenue has already become one of the leading streets of our fast growing city and is now the best street east of Sherbourne. It is within ten minutes ride of St. Lawrence Market, and forms the leading thoroughfare of the Northern portion of the County of York into the city.

The Grand Trunk suburban train, which runs twelve trips daily between Weston and East Toronto, stops at Pape-avenue, while the Toronto Street Railway passes along Queen-street every ten minutes, and the rails are now being laid by the Toronto Street Car Co. for the extension of their tracks across the bridge and along Gerard-street to Pape-avenue, thus giving the residents the facility of reaching any part of the city.

Pape-avenue is already sewered and block paved, water and gas is now laid on beyond the railway and will be extended through to Bloor without delay.

No troublesome or expensive searches are required as to the title of this property, there being only four or five transfers from the Crown to the present owner.

We beg to direct the attention of intending purchasers to this property and request them to examine it and get terms and price list before purchasing elsewhere, for without doubt this property will double itself in value within the next three months.

Special terms will be given to purchasers about to build. For plans, prices and all other particulars apply to

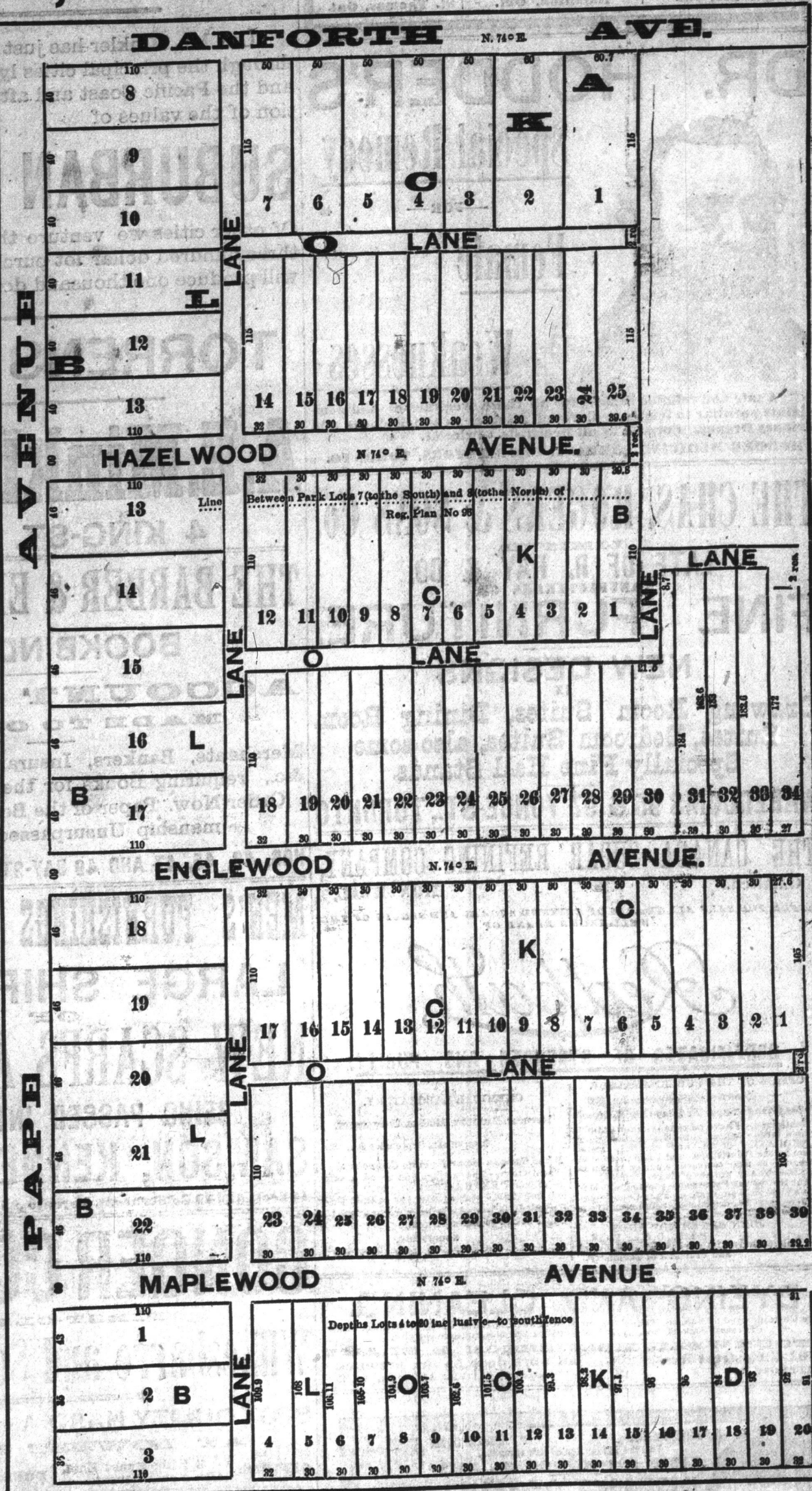

PETLEY & CO.,

55 AND 57 ADELAIDE-STREET EAST,
SOLE AGENTS FOR THIS PROPERTY. TELEPHONE 783.



GENTLEMEN'S SUMMER TIES

THREE HUNDRED DOZEN
SAILOR KNOTS AND NEGLIGE SCARFS,
THE BONNIEST, BRIGHTEST, MOST TASTEFUL COLLECTION

Of Summer Scarfs and Ties that have ever found shelf room. In passing our store glance in the glass cases on either side the main door.

AND NATURAL WOOL UNDERWEAR,
Light as Balbriggan and Impervious to cold. A large stock of these goods. Fine French Balbriggan, natural wool color—Best Goods Made, 65c the garment, \$1.20 the suit.

ALSO FINE CAMBRIC SHIRTS.
Different colored patterns, Men's and Boys', 2 collars 75c; Cricket and Tennis Shirts, Boys' Ceylon Tennis Shirts, Collar attached, 90c, Straw hats by the hundred; every size, quality, make and price.

R. WALKER & SONS, KING-STREET EAST.

J.H. ROGERS
105 KING & CHURCH

HATS.

J.H. ROGERS
296 MAIN STREET

We have the Latest Novelties in Stiff and Soft Felt Hats from the best English and American Manufacturers. Lincoln & Bennett's Silk Hats, satin finish, are the best imported hats brought into this market for durability, style or finish they can not be excelled. Christy's Felt Hats are as popular as ever; for durability and retaining their color they have no equal. Boys' Knockabout Felt Hats at all prices. Our \$4.00 Silk Hat is as popular as ever.

James H. Rogers,

CORNER KING AND CHURCH-STRS.

Fishing Tackle Department.

NOVELTIES FOR SEASON 1889.

We have the entire control of these Patent Baits for the Canadian Market. Our Stock of Fishing Tackle is well assorted and Prices very low consistent with quality.

ALCOCK, LAIGHT & WESTWOOD, 6 Wellington-st West, and Redditch, England.

W.M. CROFT & SONS,

ESTABLISHED 1855.

TACKLE

MANUFACTURERS AND IMPORTERS OF
FINE FISHING TACKLE

We have a full line of English, American and Canadian Rods in Wababa, Greenherry, Bethahara, Biss Maloo, Lancowood, Hickory, A-h and Ironwood. Also, Spliced Oars and Split Bamboo Rods, with English and Spanish joints. We have 12,000 Bamboo Poles still in stock which we are offering at one price. Our tools of Bait are large and includes spoons, Minnow, Gauze, Bass Tackle, etc., to suit all seasons. Also all sizes of the Patent Cork Spoon Bait, Enamelled Silk, Flax, Lala Thread, Oiled Silk, Linen, Raw Silk, Hair, Bone and Cotton Lines. Orders receive prompt attention.

TELEPHONE 1223. 57 COLBORNE-STREET, TORONTO.