

# PORCUPINE RAND

WEST RAND EAST RAND

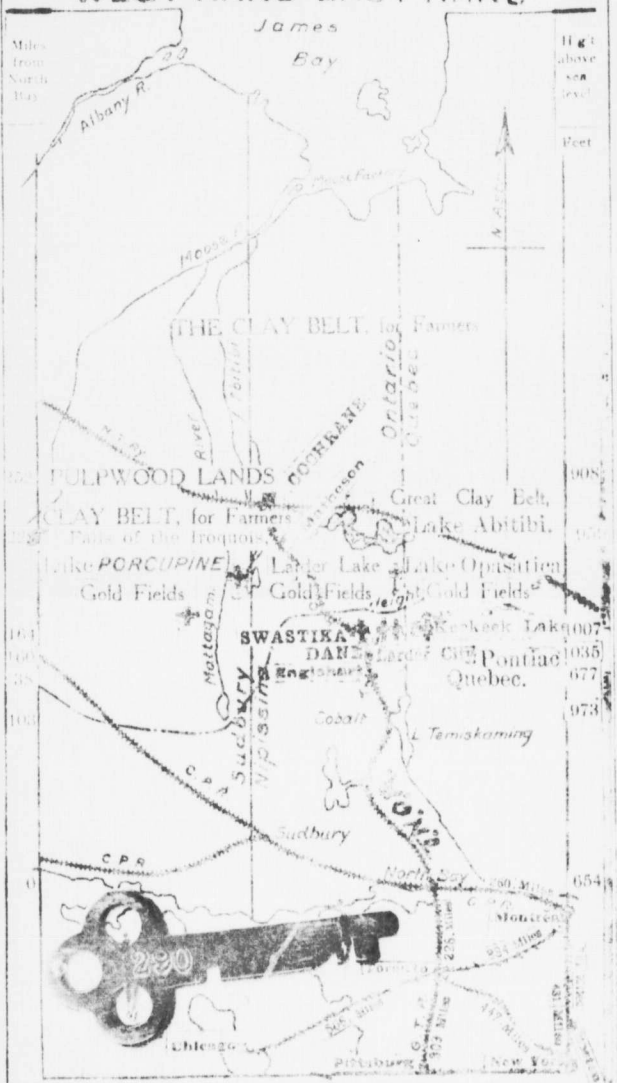

**KEY PLAN**  
 showing relative position of the  
**PORCUPINE-LARDER-PONTIAC**  
**ONTARIO & QUEBEC.**  
**GOLD FIELDS.**

**IROQUOIS FALLS** trains shall start for *Porcupine* *Lake*  
**DANE** stage connections to and from Larder City **Keekeek Lake**  
 and Lake Opasatica, County of Pontiac, Quebec.

Copyright Canada, United States and British Isles, 1911, by James H. Tait

# PORCUPINE RAND

WEST RAND EAST RAND

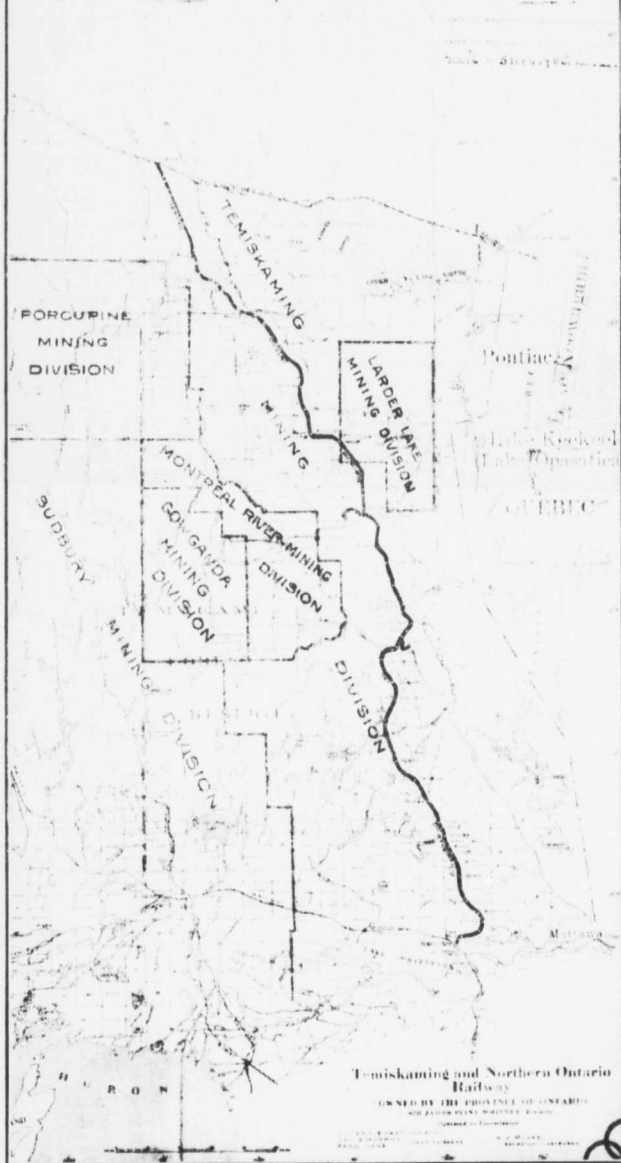

PORCUPINE RAND

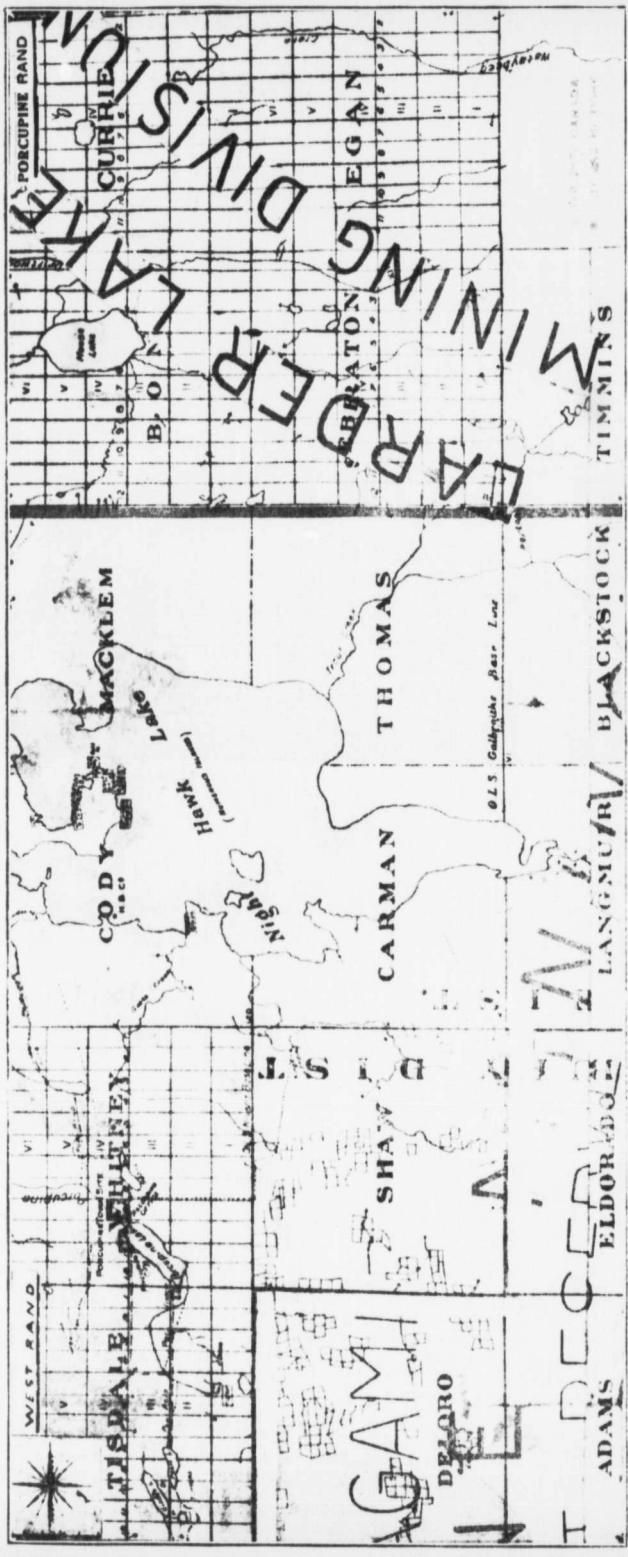

## PORCUPINE RAND

DANE STATION, T. & N. O. RAILWAY,  
June 16, 1911.

*Mr. J. L. Englehart, Chairman T. & N. O. Railway;  
Mr. R. S. Gourlay, President Toronto Board of Trade, and  
The Members of the Toronto Board of Trade.*

GENTLEMEN:

I will cut out the usual compliments paid on these occasions to distinguished visitors and get to business talk.

Railroad building is my vogue. I appreciate the onward movement of the T. & N.O. Railway, especially when it proved itself a lucky prospector and stubbed its toe on Silver Rock in Cobalt, but I do not appreciate constructing it as if it were a fishing rod, with all the "goods" to be got at the end of the line. I compare a railroad to the physical frame of a man—you must feed the brute to sustain him and make him do useful work.

With that object, a few days ago, I wrote L. O. Armstrong, C.P.R. Industrial Agent, Montreal, for an interview re reported survey of a line from Mattawa on the C.P.R. to the T.C. Railway in Pontiac Nord, Que. I got it. Mr. Armstrong stated that a railroad would have been built long ago north along Temiskaming Lake shore to Ville Marie, but for physical difficulties which were now being countered by locating a more easterly route, north to the Quinze Falls, to take care of the trade of the budding Mining Camps at Opasatica and Keekee Lakes, Que., and Larder Lake, Ont. He mentioned that the line from Mattawa would go on sure this time—that a line would also go on sure from Sudbury to Porcupine Lake via Gowganda; he said: I think the C.N.O. Ry. were the constructors of the latter line—that I should see Mr. M. J. O'Brien, who had charge of the survey, that he could give me details. I interviewed Mr. M. J. O'Brien at the Queen's Hotel, Montreal, after satisfying himself that my pass was vided by Mr. Armstrong. He said, in part, that at this period he was not at liberty to speak, but by putting two and two together, I learned from him that a Montreal Company had got a Dominion Charter for railroad construction with running rights to New Liskeard, that the line would strike the T.C.R. Ry. east of Abitita Lake upper, serving en route through the physical nature of the country it traversed. Larder and Opasatica Lakes first,—Keekee and Keewagama Lakes next, and at the end of the fishing rod the clay belt of the Transcontinental Road—thus putting a ring fence round the known mineralized zone, with the T.C.R. and C.P.R. enclosing it on the north and south sides, and the Mattawa and Sudbury lines on the east and west sides, respectively, with the T. & N.O. Railway running up the centre dividing the spoils, which you should fish for by sending out feeders to the Mining Camps to sustain it—therefore I suggest to you who declare you want the trade for Toronto, to harness the water power at Englehart or Wendigo Lake, which I have seen; start an electric railroad from Swastika, admitted to be the third best mine on the Porcupine Rand, although in the Larder Lake area; run it due east S.E. four miles to Dane on the T. & N.O. tracks, then take the Ontario Government Road to Larder Lake, eighteen miles long by one and a half chains wide, built at a cost of \$40,000 three years ago, now in A1 condition—thanks to the Minister of Public Works. Lay your tracks on it, York Radial style, to Larder City, then fourteen miles along the north side of Larder Lake to Opasatica Lake, which is six miles east of the Ontario-Quebec boundary—run it six miles further due east to Keekee Lake, Que., and then ten miles further E. N.E. to Keewagama Lake and another ten miles further to the T.C. Ry. This Electric Line could, with advantage, be run due west of Swastika, to tap the C.N.O. running north from Sudbury, near Musgrove, and other townships that are making gold discoveries due west of Larder Lake.

Why not let this projected Electric Road by contract for construction, giving the contractor the steel and say two years to hand over the line?—West Australian Government style, who got the 200-mile line from Freemantle to Kalgourlie built on above terms for half its prime cost. The Contractors trebled the contract amount by pushing the head of the line twenty miles at a time and carrying machinery, freight and passengers up to the Goldfields, though there was no freight to be carried out—an armed escort took out the gold. Water for the use of the engines had to be carried from the base.

JAMES H. TIGHE,

Member Toronto Board of Trade.

## ONTARIO & QUEBEC. GOLD FIELDS.



J. L. ENGLEHART  
CHAIRMAN OF T. & N. O.  
COMMISSION

The World.

### Resources of Country

Taking the various sections of the new country separately, Mr. Englehart dealt in detail with the great and varied resources of each. From North Bay to Temagami was the great Temagami forest reserve, fifty miles in length, which was a great asset. The country was also abounding in iron ores. From Temagami to Latchford the Gowganda district was passed, the Montreal River provided transportation by water for six or seven months of the year. Speaking of the Cobalt district, which had yielded so much wealth, he said that many people had lost money in it, but that was due to the wild-cat schemes of promoters, and was no reflection on the country. "It behooves a man," he said, "to know the company he is in."

### The Great Clay Belt.

At Halleybury the great clay belt was entered. Clay soil, he said, retained its richness the longest of any. The clay soil of this belt was as much superior to that of other parts of the Province as clay was to other soil. That fact had been demonstrated and proven. Although there were frosts in nearly every month of the year, this did not prevent the land from yielding bountifully. Proceeding farther north, the Larder Lake district was penetrated. Although a region of low-grade ores it had great possibilities. Around Matheson and Monteith copper and gold abounded, and there were great opportunities for the pulp industry. In Porcupine, the latest gold-mining region, which it was prophesied would be equal to the Rand, the prospect was equally bright for agricultural and timber industries. The Globe.

# PORCUPINE RAND

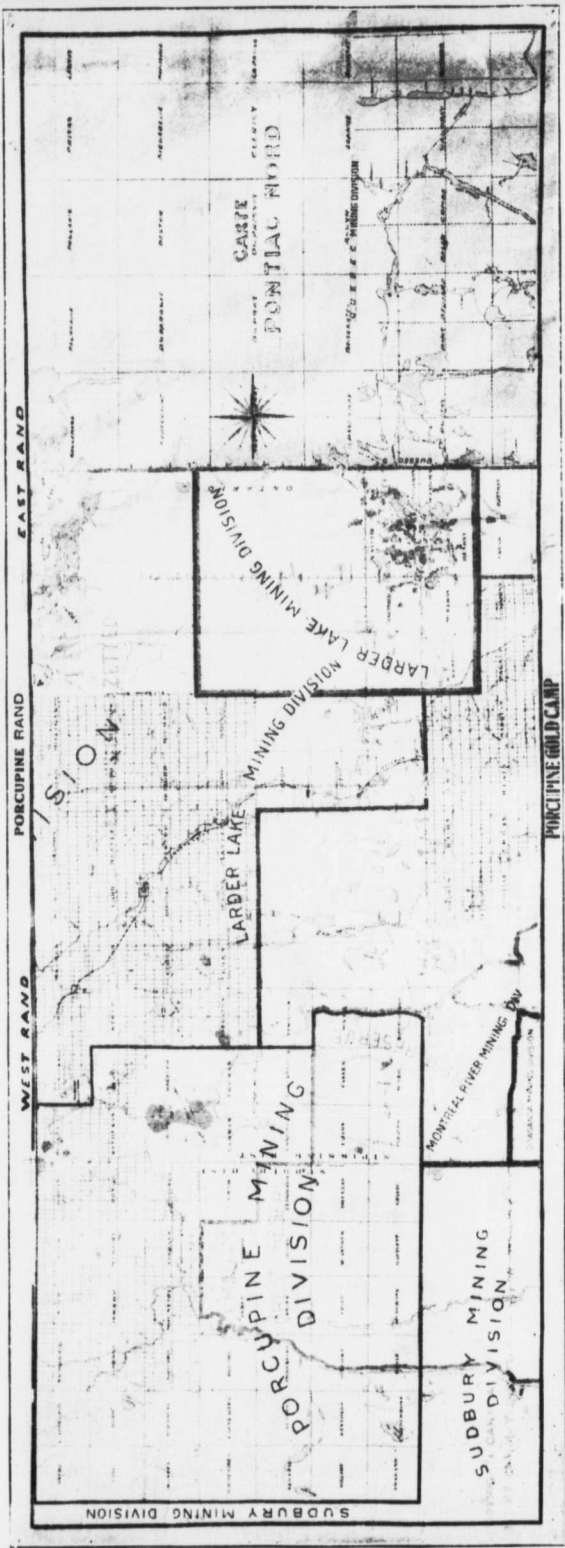

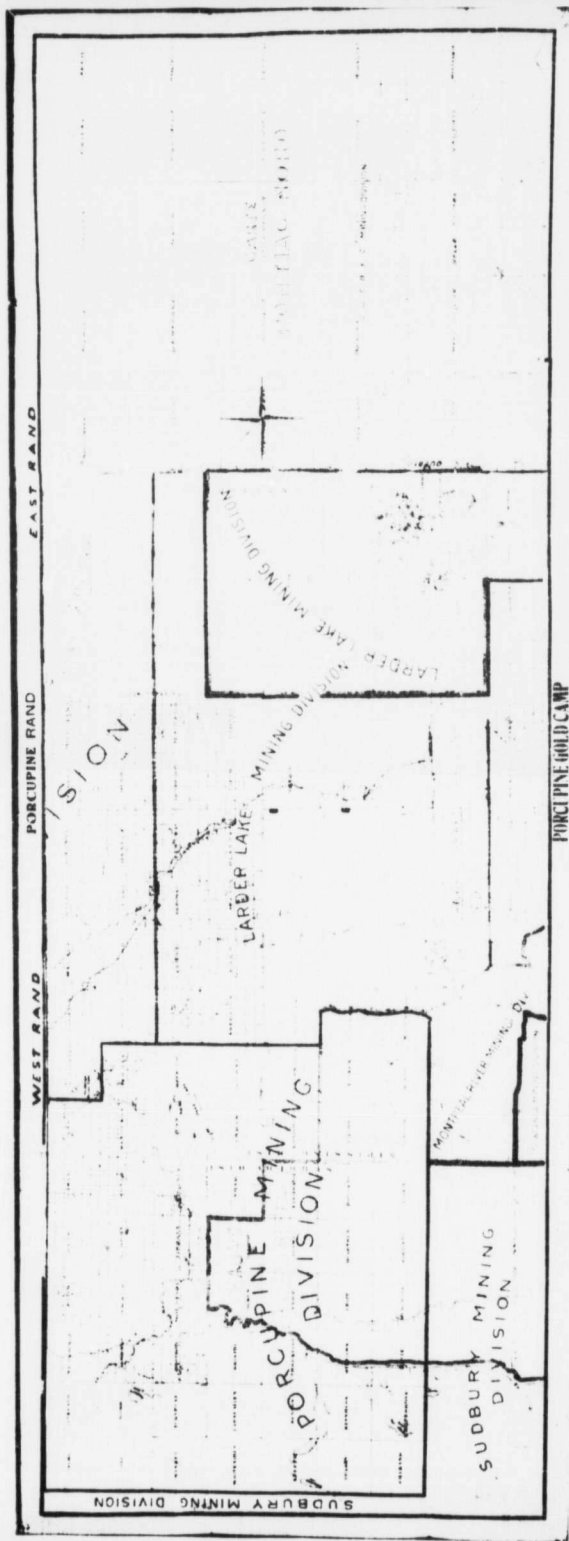

PORCUPINE GOLD CAMP

SUBBURY MINING DIVISION

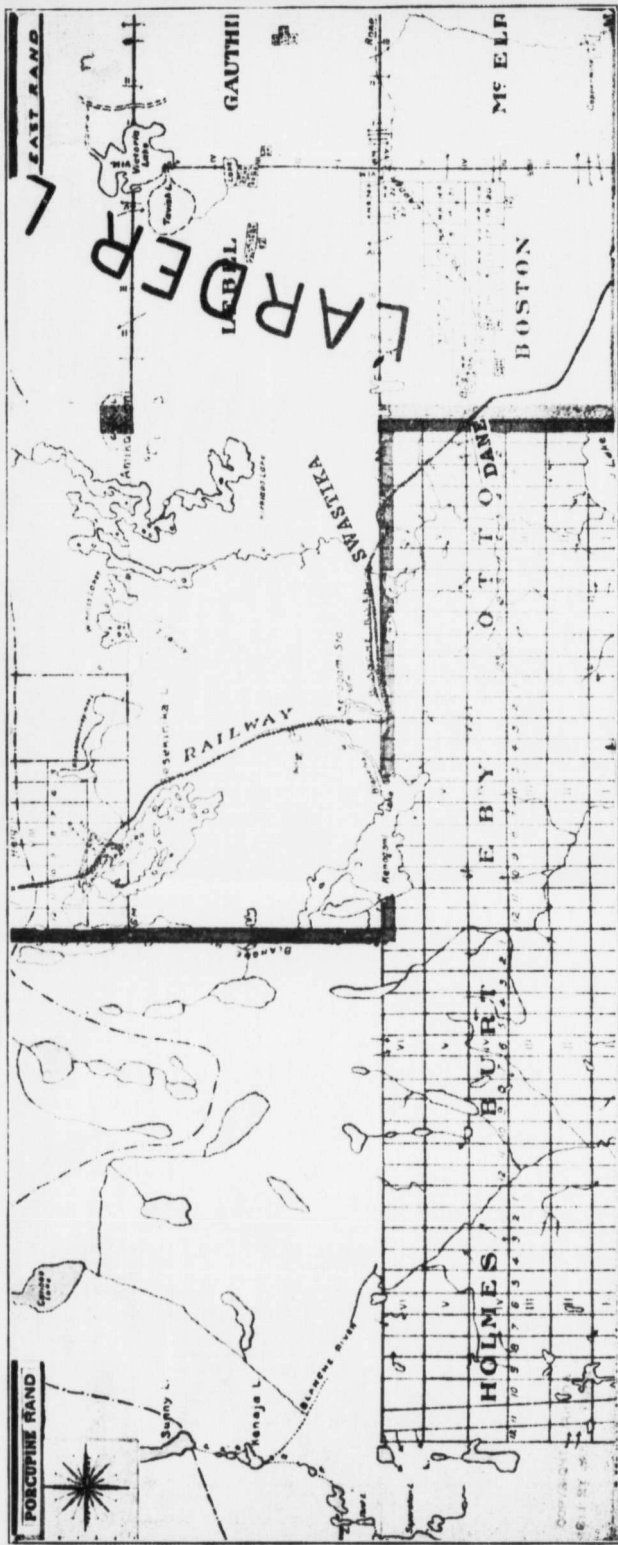



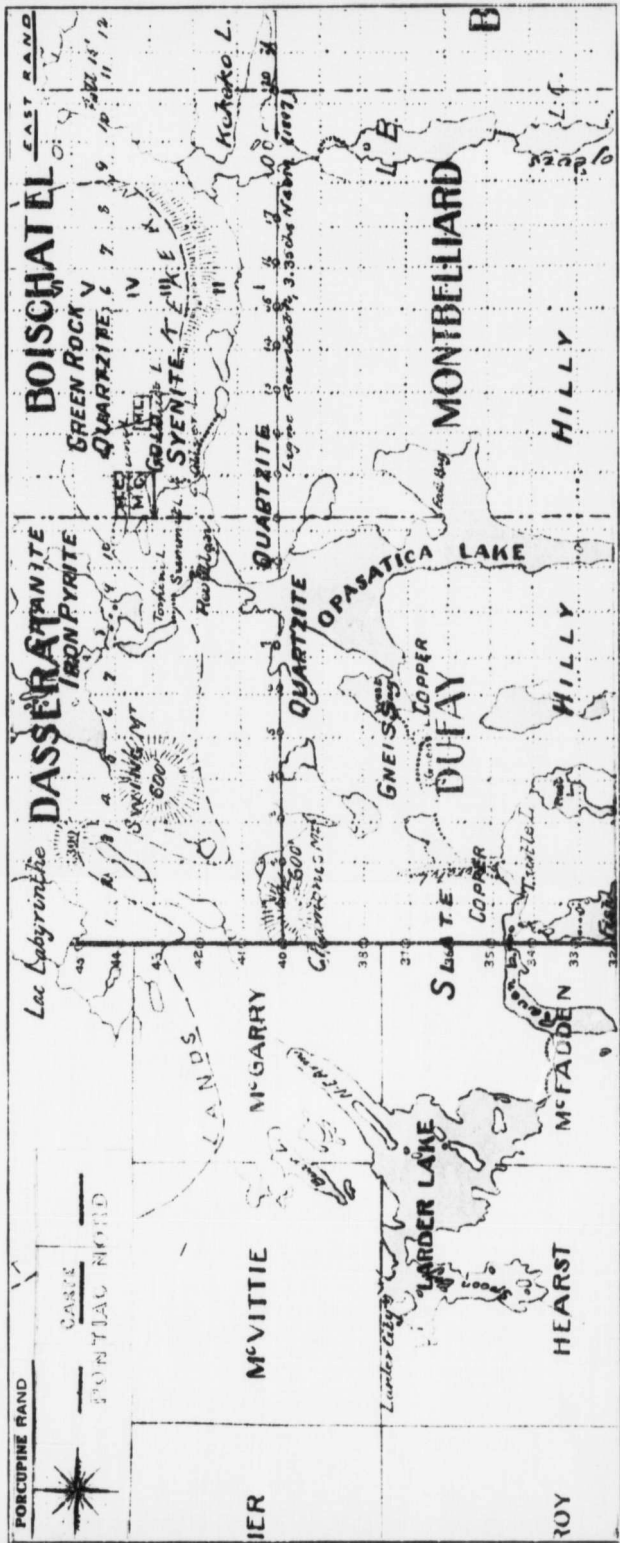



# Minister of Mines Gets the 3rd Degree

From Miner's Right K306.  
The Writer of "The Crime of the Century."

---

1.—What was the motive of the Minister of Mines in removing the Recorder's Office from Larder City and by doing so depreciating the value of his, the Crown's deceased partner's estate and also the one-third interest of the Crown at the same time in the Government Townsite of Larder City?

2.—Was it by his authority and with his acquiescence that a certain statement was made about January 15th, 1911, at a supper in Matheson, that the Recorder's Office in Larder City was to be removed to Matheson, so that it could have the collection of the revenue of the Larder Lake Mining Division by its extension due north in place of due west, as demanded by the Miners—so as to include Matheson in the Division?

Was the price for this concession 500 votes, swung by one man? Was a Hotel Keeper's License also a consideration in the price? Was the License to be issued to the swinger of the votes, or must he transfer his interest to a Crown Nominee and at the Crown's valuation?

3.—Were special privileges extra on the Mines Act granted to the Hollinger Mine Bunch—Timmins, McMartin and Dunlop, the brother-in-law of the Minister of Mines (who took one year and nine months with a two-stamp Nissen Mill to prove a prospect to be a \$50.00 Mine), while the newspapers reported assays from nothing to \$5.00 one day, and \$5.00 to 0c. the next day?

Where there is equal rights to all,  
Special privileges to none should prevail.

4.—Why was Matheson side-tracked as the Junction point for the Porcupine Railroad? Was a Muskeg in the Clay Belt, through which the T. & N.O. Railway Engineers could not build a railroad, due West, the cause of the case of appendicitis developing at Iroquois Falls, twenty-five miles due north of Matheson, where the steel to Porcupine "volte face" and runs 25 miles south again.

5.—Why did the Minister of Mines, knowing, as he must have, that 104 Mining Claims were patented in the old Larder Mining Division and that Larder had the goods—low grade (but not so d— low grade) as admitted and publicly stated by the Chairman of the T. & N.O. Railway, and only awaited railway facilities from Dane or Swastika East to Larder Lake, and on to Oposatic Lake and Keekee Lake, Que., to make good as well as secure the trade of those Camps to Toronto—ignore the petition of February 22nd, 1911, to construct that road and, like the dog in the manger, oppose Charters being granted in Ontario by the Dominion Government, for such railroads.

Was it because he was requested to withdraw a patent issued (for ground, the Crown did not own, the property of his deceased partner which the Minister of Mines had requested the Owner, his deceased partner, to put a price on, which he refused to do), to the members of a firm in which a political supporter has or had a big interest.

6.—Will the Honorable the Minister of Mines immediately prescribe a vomit for his Miracle Workers, the Jonahs of Larder Lake who cannot digest the whale of Abitibi Lake. It already stinks at the head, and the stench is intollerable and the carcass must be ejected from their stomachs as the miracle is not Biblical, and gazette the Larder Lake Mining Division Extension, as requested by the Miners with Rights.

# PLAN OF THE TOWN-SITE LARDER CITY

BEING A DIVISION OF THE LARDER CITY BLOCK,  
TOWNSHIPS OF HEARST AND MITCHELL DISTRICT OF  
NORTHWEST TERRITORIES

Scale: 1 inch = 100 feet

Note: The plan is intended to show the general layout of the town-site and is not a guarantee of the exact boundaries of the lots or blocks. The plan is subject to change without notice. The plan is not a guarantee of the exact boundaries of the lots or blocks. The plan is subject to change without notice.

Sandy gravel ridge  
Surface for  
HAULING TRACK & ATHLETIC  
GROUND

Government road from  
Quebec

Suitable Site  
for  
Proposed Smelter

Separate schools  
Public Schools  
Suitable Site  
for

Proposed  
Concentrator  
Mill

Lake  
Kildiney

Penny  
Park  
Block

## TOWN-SITE LOT PRICES

Subject to change without notice  
Timber and mining rights reserved

LOTS: North of Broadway Ave.  
West of Lake Kildiney  
South of 17th Avenue

LOTS: 5th Avenue  
West of Commissioner St

LOTS: Broadway Avenue  
1st Avenue  
2nd Avenue  
3rd Avenue  
4th Avenue  
West of Commissioner St

LOTS: Commissioner St  
2nd Avenue east of Commissioner St

LOTS: 2nd Avenue  
3rd Avenue  
4th Avenue  
East of Commissioner St  
with building conditions

LOTS: Market St  
Copeland St

Corner Lots: Market St and Copeland St

LOTS: Lake Shore Road, price on application

Terms: Cash

Lots reserved & marked

Note: Sites marked on map  
as suitable for  
schools, church, hospital  
are reserved for that purpose

Suitable site for  
Reduction  
Plant

For particulars  
Apply to

OTTAWA TRUSTEE SAVINGS DEPT. LIMITED  
CONFIDENTIAL LIFE BLDG  
TORONTO.

# PORCUPINE- LARDER LAKE GOLD FIELDS.

NEW ONTARIO  
CANADA

SURVEYED BY C.M. FULLERTON O.L.S.

27th NOVEMBER 1907

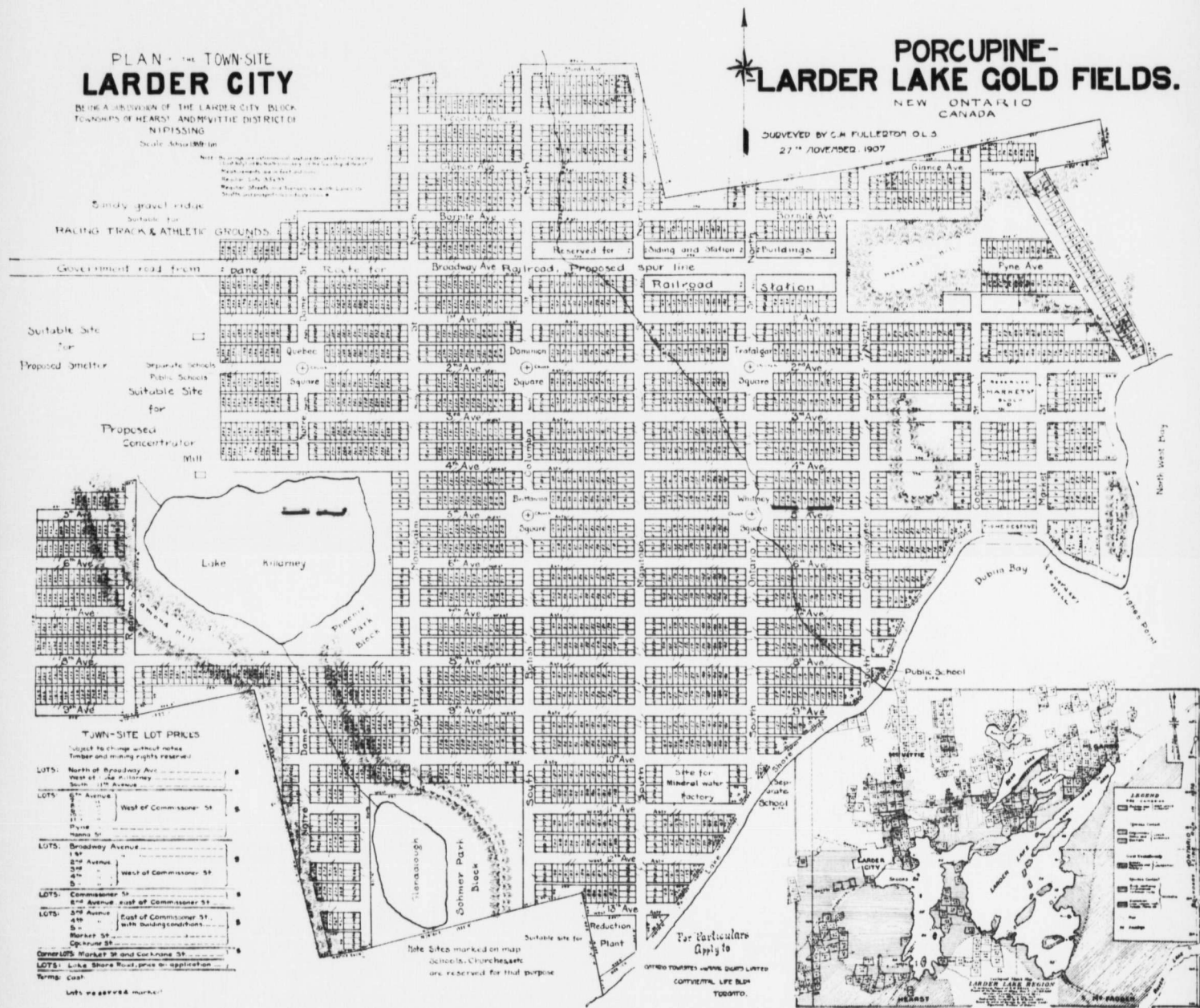

1	Proposed Smelter
2	Proposed Concentrator Mill
3	Suitable Site for Smelter
4	Suitable Site for Concentrator Mill
5	Suitable Site for Schools
6	Suitable Site for Church
7	Suitable Site for Hospital
8	Proposed Railway Station
9	Proposed Railway Spur Line
10	Proposed Railway Buildings
11	Proposed Railway Goods Yard
12	Proposed Railway Water Tower
13	Proposed Railway Engine House
14	Proposed Railway Coal Shed
15	Proposed Railway Office
16	Proposed Railway Warehouse
17	Proposed Railway Workshop
18	Proposed Railway Blacksmith Shop
19	Proposed Railway Carriage Shop
20	Proposed Railway Engine Room
21	Proposed Railway Water Tank
22	Proposed Railway Signal Box
23	Proposed Railway Telegraph Office
24	Proposed Railway Station Master's Office
25	Proposed Railway Ticket Office
26	Proposed Railway Refreshment Room
27	Proposed Railway Waiting Room
28	Proposed Railway Goods Platform
29	Proposed Railway Goods Shed
30	Proposed Railway Goods Yard
31	Proposed Railway Engine House
32	Proposed Railway Coal Shed
33	Proposed Railway Office
34	Proposed Railway Warehouse
35	Proposed Railway Workshop
36	Proposed Railway Blacksmith Shop
37	Proposed Railway Carriage Shop
38	Proposed Railway Engine Room
39	Proposed Railway Water Tank
40	Proposed Railway Signal Box
41	Proposed Railway Telegraph Office
42	Proposed Railway Station Master's Office
43	Proposed Railway Ticket Office
44	Proposed Railway Refreshment Room
45	Proposed Railway Waiting Room
46	Proposed Railway Goods Platform
47	Proposed Railway Goods Shed
48	Proposed Railway Goods Yard
49	Proposed Railway Engine House
50	Proposed Railway Coal Shed
51	Proposed Railway Office
52	Proposed Railway Warehouse
53	Proposed Railway Workshop
54	Proposed Railway Blacksmith Shop
55	Proposed Railway Carriage Shop
56	Proposed Railway Engine Room
57	Proposed Railway Water Tank
58	Proposed Railway Signal Box
59	Proposed Railway Telegraph Office
60	Proposed Railway Station Master's Office
61	Proposed Railway Ticket Office
62	Proposed Railway Refreshment Room
63	Proposed Railway Waiting Room
64	Proposed Railway Goods Platform
65	Proposed Railway Goods Shed
66	Proposed Railway Goods Yard
67	Proposed Railway Engine House
68	Proposed Railway Coal Shed
69	Proposed Railway Office
70	Proposed Railway Warehouse
71	Proposed Railway Workshop
72	Proposed Railway Blacksmith Shop
73	Proposed Railway Carriage Shop
74	Proposed Railway Engine Room
75	Proposed Railway Water Tank
76	Proposed Railway Signal Box
77	Proposed Railway Telegraph Office
78	Proposed Railway Station Master's Office
79	Proposed Railway Ticket Office
80	Proposed Railway Refreshment Room
81	Proposed Railway Waiting Room
82	Proposed Railway Goods Platform
83	Proposed Railway Goods Shed
84	Proposed Railway Goods Yard
85	Proposed Railway Engine House
86	Proposed Railway Coal Shed
87	Proposed Railway Office
88	Proposed Railway Warehouse
89	Proposed Railway Workshop
90	Proposed Railway Blacksmith Shop
91	Proposed Railway Carriage Shop
92	Proposed Railway Engine Room
93	Proposed Railway Water Tank
94	Proposed Railway Signal Box
95	Proposed Railway Telegraph Office
96	Proposed Railway Station Master's Office
97	Proposed Railway Ticket Office
98	Proposed Railway Refreshment Room
99	Proposed Railway Waiting Room
100	Proposed Railway Goods Platform

# *The Land Titles Act*

---

## **Certificate of Ownership.**

*(Ores and Minerals reserved in Patent)*

*granted to*

*Parcel*

*in the Register for*

*Nipissing*

*Dated*

*day of*

*19*

---

Buyers of Lots must receive this Certificate of Ownership as their receipt for their 1st payment, or they have no title that will be recognized.

## ONTARIO & QUEBEC. GOLD FIELDS.

# PORCUPINE RAND

### Strenuous Kick from Larder Lake

petition is being circulated in the Larder Lake territory and among people interested in that camp, asking that the Recorder's Office be moved back from Matheson to Larder City. The prime mover in the circulation of the petition is Mr. Jas. H. Tighe of the Tighe Syndicate, one of the original exploiters of the country and a man who has never lost his faith in the future of the mining camp even in the time of its darkest adversity.

On Monday Mr. Tighe called at the Herald Office with an explanation of his case. He says that in the early days the Government located a Recorder's Office on the Tighe Syndicate's property and that as a result of the presence of the Office very largely he and his associates surveyed out a townsite. The private parties interested paid all the costs in connection with this work including between \$2,000 and \$3,000 in surveyors fees, and secured the ground for the purpose in the ordinary course of staking, but the Government refused to permit the registration of the plans of the proposed town unless it was given a share of the private property. Mr. Tighe says that the Department of Lands and Mines held him up for one third of the Townsite at the price of allowing him to proceed with the project. A schedule was accordingly drawn out allotting the Government a third of the territory but the department objected, saying that the Government had not been given a sufficient number of corner lots. There schedules were drawn up until a division was arrived at under which the Government got a carefully selected third of the property.

Under these circumstances Mr. Tighe argues that it was most unfair to have the Recorder's Office moved to Larder City. He says that the Government has captured all the advantages it could lay hands on in the proposed town both in expense and is now taking steps to kill it.

Mr. Tighe has interesting views on his proposition as showing the bright prospects ahead of the Larder Camp. He has a private letter from the recorder, Mr. J. Atwell Hough in which the Government official states on the authority of an eminent engineer that the Harris Maxwell has 3,000,000 tons of ore in sight to the water line, which runs on an average of over \$4 to the ton and that the cost of milling would be something under \$2.

When the Harris Maxwell law suit is completed, Mr. Tighe expects to see the Larder country staked far and wide and he says that it is unfair to the prospector that he should be required to travel 63 miles to the new location. It takes three days to do the trip. He likens the trips of the prospectors to the pilgrimages of the worshippers to Mecca.

Mr. Tighe advocates a new division of the territory in which the Matheson Office would be given the country lying north of the Lyons survey line and an office would be re-established at Larder for the country lying south of that line and west to the Railroad, or probably west to the present Porcupine Mining Division.

### Further Activity At Swastika

Mr. Neil R. McDonald will superintend the commencement of operations on four claims adjoining the Swastika, which have been taken over by a New York syndicate. After that he is proceeding to Porcupine to start active operations in Langmuir Township and adjoining the south west corner of Carman. It is evident that the Swastika is not the only mine in the district, although it has been working successfully for some two years without any further discoveries being made. However, it now seems as if further prospecting has opened up other good ground in the vicinity and this is interesting as tending to prove the existence of the gold bearing belt from Porcupine right through to Larder Lake, Swastika being the apex.

THE TEMISKAMING HERALD, MAY 20, 1911 THE PORCUPINE NUGGET

ONTARIO  
Townsites & Mining Rights,  
Limited.



## Department of Colonization, Mines and Fisheries

PROVINCE OF QUEBEC

ROBERT HARVIE, Jr.

MINING GEOLOGIST

### ECONOMIC GEOLOGY OF THE OPASATICA DISTRICT in part

The geologically most favorable portion of the district is situated in the vicinity of the height of land, around the north end of Lake Opasatica. The rocks of this area extend westward, past the north side of Larder Lake. The first discoveries of gold were made near two small lakes (Fortune and Renault) three miles northeast of McDonald's trading post, at the north end of Lake Opasatica or about forty-five miles in a direction slightly east of north from the north end of Lake Temiskaming.

*Published by authority of the Honorable C. R. Devlin  
Minister of Colonization, Mines and Fisheries.*

The claim on which gold was first discovered is now the property of the Pontiac-Abitibi Mining Co., and up to date the only development work of any consequence in the district has been done here.

The gold is associated with quartz-ankerite veins cutting the Keewatin porphyryite and the Huronian breccia and associated dyke. The largest vein seen averaged about two and a half feet wide in an exposure of one chain in length, and it may be said that all of them seem to hold their width well. During the examination only one specimen was found having visible gold, but comparison of this with material collected by others from various veins, showed it to be quite representative. The quartz is partly massive, partly in free crystals, in both cases being commonly banded with *ankerite* and carrying sericite, iron pyrites and copper pyrites. The gold occurs both free and in combination with silver as the telluride *sylvanite*, in which mineral there is 21% of gold and 13% silver. The sylvanite was introduced later than the quartz and ankerite, being found in fractures in these minerals. The gold is chiefly in seams in the sylvanite.

QUEBEC, DECEMBER, 1910

# PORCUPINE RAND

## FREE GOLD DISCOVERIES IN QUEBEC PROVINCE

**Great Rush of Prospectors from Northern Ontario —  
Generous Policy of Quebec Government Lures  
the Free Lances to the North.**

(Special Despatch to The Globe)

Cobalt, April 4.—They are off again, the free lances of the north, and this time it is to the Province of Quebec. Sixty miles northeast of Halleybury about 60,000 acres of territory has been staked out and several good free gold lands are chronicled. There is every indication that the main prospecting activity in the north this year will be not at Porcupine which is now staked solid for dozens of miles, but in the Keekeek country.

### Sam Le Roy to the Front.

Sam Le Roy was the first man in there. He is one of the finest pioneer prospectors in the north country. Last summer he got sick of Gowganda, where he had made a good stake anyway and had a lake named after him, and took advantage of the easier Quebec laws to go into the Quinze country. He put his canoe into the waters of Lake Temiskaming and paddled up the Quinze, skirted Lake Expense (a sheet of water which will be quite navigable when the Quinze dam is finished) and so to Keewanna or Turnback Lake, so called because there he picked up the formation he was looking for and turned west to explore it.

### Great Deposit of Molybdenite

On the peninsulas at Turnback Lake there is a great deposit of molybdenite which, it is reported, belongs to Mr. M. J. O'Brien and the Hon. Clifford Sifton. There is an immense exposure of it, and it is stated that a German syndicate have bought it for half a million dollars, the molybdenite to be used for toughening steel. This may or may not be true but men have been working on the property for some time now and a gang went back before the break-up to continue stripping.

### A Find of Quartz

Le Roy turned back, however, molybdenite not interesting him, and he followed the formation to a small lake, four miles long by half a mile wide which the Indians call Keekeek Lake or being interpreted Night Hawk. Here he made his find of quartz, solid

for twenty feet, and carrying very fine grained gold. Le Roy stayed in the country until he had staked all he could then he got licenses at Ville Marie the nearest recording station for his relatives, and finally passed the word on to his friends. By this time winter had come the canoe route was frozen up and the travel was overland by Klock's farm and Crooked Lake. Mr. C. A. Foster the man who made a fortune by selling the Foster mine at Halleybury to Lucky Scott and the Foster mine at Porcupine to Augustus Heinze heard of this new country in northern Quebec. The ex-Mayor of Halleybury has made his fortune by taking just such chances as these, and he outfitted an expedition and his name with that of his brother-in-law Reamsbottom, figures very prominently on the chart of the north.

### Quebec Government Canny

If half the virtue that is claimed for this new field is proven, the prospecting interest this summer will be diverted from Porcupine in Ontario to Keekeek in Quebec. And that is precisely what the Quebec Government is striving for. Realizing what an asset these thousands of hardy men, trained to the trail and the finding of mineral, is to a country the mines branch of Quebec has deliberately planned a campaign to draw the free lances out of Ontario into Quebec. And Keekeek is the first fruits of their labors. Each man on his license can stake 200 acres and not a cent does he have to pay to record. That staking and recording will hold his claims for a year when he must do twenty-five days' work and pay fifty cents an acre. It is rumored that the rental will be cut down to ten cents per acre shortly. All information is given with the open hand and gladly.

### Extent of Good Country

The "good country" extends from Lake Opasatika where the Quebec Government has gone on record to finding tellurium to Lake Missinable close to the Transcontinental line and it is twenty miles wide. Two thousand licenses have been issued to prospectors at Ville Marie and 6,000 claims have been recorded. No discovery is required so that prospecting will no more than commence when the ice goes off the Quinze and Lake Expense, and men can travel by canoe.

BEN HUGHES

**ONTARIO  
Townsites & Mining Rights  
Limited.**



**PORCUPINE  
RAND  
WEST RAND EAST RAND**

No 23178

WESTERN



AUSTRALIA.

157-  
~~Five One Pound~~

EAST COOLGARDIE. Goldfield.

**MINNER'S RIGHT.**

Issued to James Henry Lyhe  
under the provisions of "The Goldfields Act, 1886;" to be in force until  
8-1-1897.

Date of issue 9-1-96 Ear Smith Warden.  
[Not Transferable.] MR

POREUPINE BRAND



CITY & COUNTY  
CONSERVATIVE CLUB  
DUBLIN

No 1799

MEMBER'S TICKET  
FOR TEENS LEAGUE  
for year ending  
31st day of December 1902

THE SAC. H. LIGHE Esq  
465 St. Ann's Lane R. 1  
Wm. Faiganhans Sec

This Card must be produced to Officers  
of the Club for examination when required

No. *a* 8854 Residential District *"a" Div*

**SPECIAL PASS.**

Name *Mrs. H. L. Lighe*  
Address *186 Market St*

has permission to reside in the Johannesburg District, and to ride, drive, and bicycle ~~at all hours, and to be out at all hours,~~ within the District, and to travel by rail within the District on payment of the usual fare.

*[Signature]*  
Signature of Issuer.

ASSISTANT COMMISSIONER  
"A" DIVISION.  
\* JUL 1902 \*  
JOHANNESBURG.

Signature of Holder.

Date

# Porcupine Rand East Rand — West Rand

HON FRANK COCHRANE,  
MINISTER OF MINES.

Allandale, Ont.,  
17th of Ireland.



Hon. Sir—The compliments of the day  
we celebrate from the surviving mem-  
bers of the Tighe Larder Lake Syndicate.

LICENSE No. K189.

UNUS ABEST.

To-day we drink a silent toast to keep  
our partner's memory green. In the  
midst of Life we are in Death.

JAS. H. TIGHE,  
Agent and Ex.



## UN VOX DE CIELO

When St. Paul of Matheson Clay Belt  
coveted St. Peter's pence Larder City Gold  
Belt. Le vox dixit. Get thee behind me,  
Satan, it is written. Matheson shall not  
live by Peter's pence, but by the sweat of  
her brow, reaping when she sows, selling  
pulpwood if she cuts it.

Revised edition, "Resurgam," Larder City,

—By JAS. H. TIGHE.

## IN MEMORIAM

TIGHE.—Robert R. Tighe, was accidentally killed in  
Toronto, March 30th, 1909, by asphyxiation.  
He held control of an undivided two-third in-  
terest with the Crown in the ownership of Lar-  
der City townsite, the seat of the Mining Re-  
corder's office for the Larder Lake Mining  
Division, by agreement and purchase with and  
from the Crown. He also owned the mining  
rights under Larder City Townsite.



P. M.  
75  
Ireland

—BROTHER JAMES.

# PORCUPINE RAND

## THE CRIME OF THE CENTURY

LAST PETITION.

LARDER CITY, 1911.

To the Hon. Frank Cochrane,  
Minister of Lands and Mines,  
Parliament Buildings,  
Toronto, Ont.

The undersigned petitioner begs leave to submit as follows:

That your action in removing the Recorder's Office from Larder City to Matheson, a clay belt dorp in the Gazetted Larder Lake Mining Division Extension, in spite of the cogent and truthful statements put forward in the last petition to prevent your committing "political suicide," is unwarranted and against the best interest of the miners, whose interests are your first charge as a servant of the Crown, to which your own political interests and that of your party must be subjected.

The farce of putting Lake Abbitibi in the Larder Lake Mining Division is a case of Jonah swallowing the whale, instead of the *vice versa* Biblical version.

Your action is the crime of the century, which we will now prove to demonstration:

The old Fox-pro prospector that broke cover three years ago in the old Larder Lake Mining Division is working back again to cover where he started.

The moment the litigation re the Harris-Maxwell Mine, the real Dome, is terminated, the North Side of Larder Lake in the Old Mining Division will be re-staked solid from Swastika to Opatatica Lake, Que.

By the iniquitous removal of the Recorder's Office from the Government Townsite of Larder City it will cost a miner \$25.00 prime cost to record a claim in excess of its lawful cost, namely:

Staking .....	\$10.25
Stage return from Larder Lake to Dane .....	5.00
T. & N.O. Railway from Dane to Matheson .....	2.25
Hotel Bill 2 nights and 1 day, prime cost, as the only train arrives too late for Recorder's Office and leaves too early (9.45) to transact business .....	3.50
3 days Miner's time wasted .....	9.00
1 day's dissipation locating Blind Pigs and Pool Rooms, a very modest day .....	5.00
	<hr/>
	\$35.00

This is but one of 36 transactions with the Recorder in connection with a Mining Claim, and for which he collects his fixed fee. See Schedule Mines Act, Ont.

That your petitioner humbly presents the above facts and prays for the revocation of the Order-in-Council removing Recorder's Office from its lawful and proper place in Larder City to the Northerly Extension of the Larder Lake Mining Division, which has the map of inconsistency stamped upon its face by ignoring the logical extension due west and north to Whitney and Tisdale Townships, as shown by a map in "*Toronto Globe*" April 6th, and asked for by the men that know—the miners, the voters.

Signed:

JAMES H. TIGHE,  
Miner's Right,

K 306.

## PORCUPINE RAND

THE MINISTER OF MINES MEETS HIS WATERLOO AT  
A GAME OF CHESS.

PLAYERS—An Ex-Pile Driver from the Port of Dublin, Jas. H. Tighe, and Ex River-Driver, the Hon. The Minister of Mines, Ont.

STAKES.—The confiscated and spoliated estate of the deceased partner of the Crown, the late Robt. R. Tighe, viz., the Mining Rights of six Mining Claims under Larder City Townsite, on which Noah's Ark will never rest, while the Dove in her aerial flights collects the options from the frozen-out, for some Bunch to exercise.



Hon. Frank Cochran, Minister of Mines,  
HON. SIR: *but not of Miners' Rights.*

I wish to pay you the highest compliment in the land we live in, i.e., Compare you and your actions to Lord Milner and his actions—that of the prancing pro Consul (his S. African sobriquet), who represented the Crown in S. Africa before the Boer War, which he is credited with Engineering, in the historical words:

"Shake hands, Paul; all I want is your Ran't' now—barring the hand-shake.

You can have the Porcupine Ran't' and such interests in it as the Crown's deceased Partner—my brother—held by virtue of Miner's Right K189 and 216B, of which estate I am the Executor, on easier terms than Kruger gave Milner, viz., Let us wash our own dirty linen ourselves and decide it by a game of chess. If you have a good drop of Scotch in you, either blood or whiskey, you will play the game. I concede to you the white men and *ipso facto* the first move, in consequence of your "blurred" vision *re meum et tuum*—the game to be played at Asunción, Paraguay, S. America, at the head of the Parana River, where the birds that forsake the Northern lights when the snow flies, together with the lucky miners, will congregate under the Southern Cross around the Arena of a Bull Ring—at the termination of the Bull Fight, the chess board to be placed "*sobre el toro caído*," before its removal.

I will wager my "Rand," if you have not already mated me, that I will mate you in the first move with my trusty Kaffir (boys), failing which—yours it will be "to drink Café Négo with the Señoras of Paraguay, and to smoke Puros Tabbaeas with the Señoritas.

Mine it will be to cross the River Styx on Charon's boat to the accompaniment of a travesty on the "Corunna March," not a drum was heard or a funeral note as the "Subject" to the Rampart we carried. We buried him sure at the dead of night with his pile-driver's boots on his feet.

With falling cadence  
The muffled bands will strike up  
God d—— the Minister of Mines.

*Vice Versa.*

If the Kaffir boy mates the white man  
The subject will wear the river-driver's boots  
And the band will strike up  
England's National Anthem,  
God Save the King.

JAMES H. TIGHE. Miner's Right, K 306.

# Porcupine Rand West Rand — East Rand

Copyright Canada, U.S.A., British Isles.

Vol. 2 not yet published—dedicated to the men of the Porcupine Rand—the holders of Mining Licenses and Miners' Rights will contain stirring tales of a Gold-field in the Making, by Jas. H. Tighe, MINER'S RIGHT K306.

## TALE I.

Sacra Fames Auri.

2.

Race for a Townsite, the new Johannesburg.

## ENTRIES.

The Crown v. The Miner's Right.

3.

The Crime of the Century.

The King can Do No Wrong

4.

The Crown for a Mining Partner?

Take Punch's Advice to Those About to Marry,

Don't.

5

Concession granted for the Townsite of Larder City—the future Johannesburg of the Porcupine Rand.

The decision formed from a perusal of this Chapter, devoted to mercantile transactions with the Crown, even when confirmed with legal documents, will, by all Investors and Mining men from over sea, contemplating becoming interested in the Gold Belt of New Ontario and Quebec, be unfavorable and against having dealings with a Minister of Mines who treats so lightly a Miner's Right against his partner.

Photo engravings of all agreements and correspondence, with the arms of England emblazoned on the paper between the Crown's representative, the Hon. the Minister of Mines' and the Crown's deceased partner and his Executor, demonstrating the Minister of Mines' methods of interpreting his contracts and obligations with a License of a Miner's Right.

6.

RAILROAD EXTENSIONS—Feeders to the T. & N.O. Railway advocated to expand it laterally with the Miner's fees and develop the low-grade camps (not so low grade), and leave the exploitation of Peary-Cooksville in the Arctic Circle for the next generation—railroad building in other mining camps. A suggestion.

7.

The Royal Sport of Pig Sticking.

Colonial style "Blind"

for revenue purposes.

A Satire on the License Act.

Why run a Blind Pig and not a Wine and Beer License?

Whiskey to be sold by the Crown Land Agent—one glass sample bottles advocated.

8.

Sanitary arrangements, none.

Mining Camp Hotels and their Latrine accommodation, South African and South American Systems advocated.

9.

In Memoriam, Toast to the Fallen.

A Mining Partner's Mate.

How was it drank?

The Enigma of the Sphinx.

# Ontario Townsites and Mining Rights

Limited

Rooms 516-519 Continental Life Building  
Cor. Bay and Richmond Streets  
Toronto

---

---

SOLICITORS  
CORLEY, PRICE & CO.  
Crown Attorney's Office  
Toronto

---

---

JAS. H. TIGHE  
Mining Broker  
Larder City  
(Charter Member of the Cobalt Exchange)  
Continental Life Building  
Toronto  
193 Eighth Avenue  
New York



---

---

Promoters and Mining Companies apply for use of this  
Copyright Folder, on a royalty basis, to  
W. J. George, 12-14 Sheppard Street, Toronto.  
Advertisements and other Township Maps may be sub-  
stituted for any matter you desire to eliminate.