

BEAMSVILLE HIGH SCHOOL.

W. W. LACHANCE, ARCHITECT.

## A Well Equipped High School at Beamsville

*Basement Above Grade Line—Assembly Room  
on First Floor—Laboratories on Second Floor*

By W. W. LaChance, Grimsby Beach, Ontario.

WHEN one begins to make plans for a high school building, certain definite and peculiar demands stare him in the face. He sees at once that every high school building ought, in addition to ordinary class rooms, to contain laboratories for the sciences, rooms for manual training, drawing, art, library, office, and especially an assembly hall. If he is more ambitious, he will try to include a room for cooking and serving lunches, bathrooms and gymnasium.

It is a fact that these latter demands are growing ones, and that in the near future they will take their place as rightful and helpful agencies in every well-equipped high school. At present, however, not every community can supply these, and it becomes necessary to offer some plans which will include only the bare necessities.

Recent construction of school buildings at various points give increased evidence that the school authorities,

acting for and with the people, have foreseen and prepared for the enlarged utilization of public school facilities which will, in the future, be demanded by citizens and tax payers every-

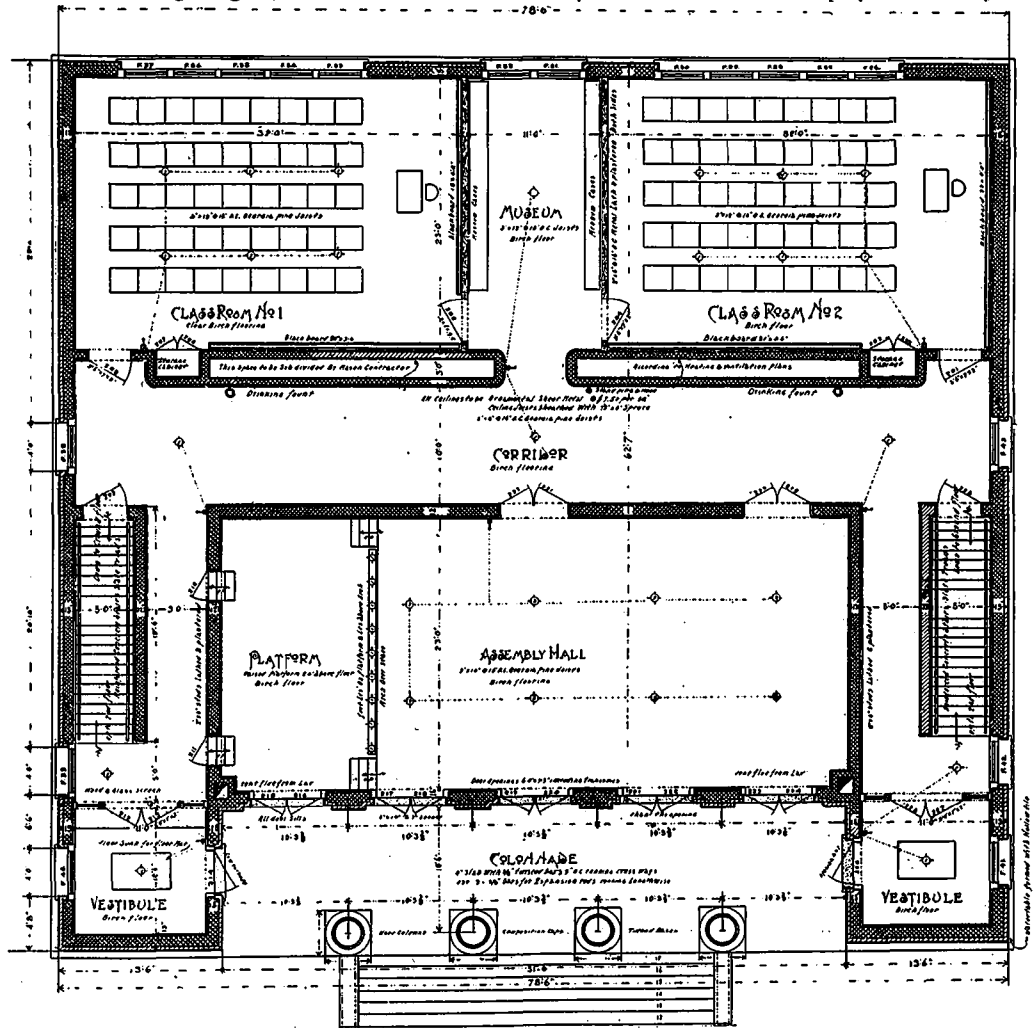

FIRST FLOOR PLAN, BEAMSVILLE HIGH SCHOOL.