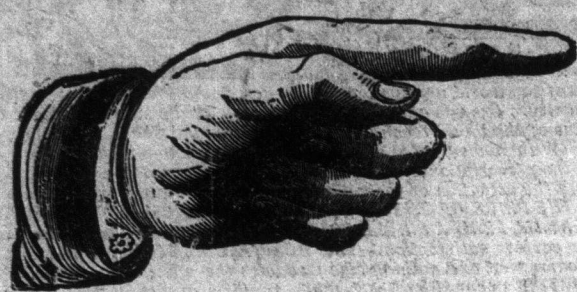
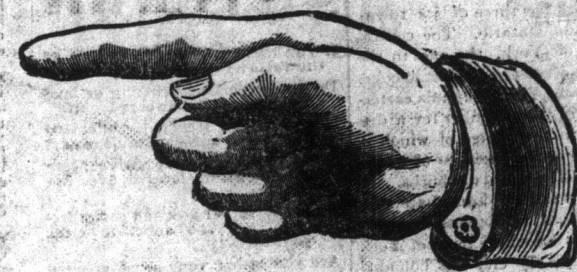

**A. E. MINKLER & CO.****MOORE PARK.****THE COMING RESIDENCE CENTRE OF TORONTO'S BEST CITIZENS.**

A HIGH AND COMMANDING PLATEAU, lying between Rosedale and Deer Park, now presents itself to our people of taste and refinement as a suitable location for elegant homes and charming villas.

THREE MINUTES' WALK FROM YONGE-STREET, along Rose Hill-avenue---which passes Reservoir Park, North Toronto, brings you to the entrance of Moore Park. Formerly a road, winding down, and then up the dell, was the best access. Now, after two years of persevering effort, a handsome high-level Steel Bridge spans this dell, which is designated "Vale of Avoca," and thus at a stroke Toronto is given what is destined to be her most distinguished accession.

"THE FINEST HIGHWAY VIADUCT IN CANADA"---Is the opinion of an eminent engineer concerning this bridge. Purposely it has been built far stronger and heavier than needful; so as to more than provide for the great traffic of the future. In its construction provision has been made for laying thereon a double line of Street Railway Tracks, which is contemplated at an early day, thus giving Yonge-street connection by Street Railway with the Eastern Junction of the Canadian Pacific Railway, which is only a few minutes' walk east of Moore Park.

IT ADJOINS RESERVOIR PARK with its miniature lakes, hanging gardens and terraced walks; and overlooks the entire city and lake front from Scarborough Heights to Mimico. The immediate surroundings are Rosedale, Chestnut Park and Summerhill to the South; the "Vale of Avoca" and Deer Park on the west and north, and then with Spring Valley on the east you have a rare setting for a home. Beauty all around and a wide prospect.

THIS PROPERTY, SO HEALTHFUL AND PICTURESQUE in its situation---has been subdivided into choice building lots, with broad streets and avenues. The aim is to make this district conspicuous for well-kept roadways, perfected systems of drainage and water supply, as well as the latest improvements in electric lighting; so that in doors and out, it will be the best lighted locality in our city. The well-known energy of the owner (J. T. Moore, Esq.) justifies the prediction that he will make it the pride of Toronto.

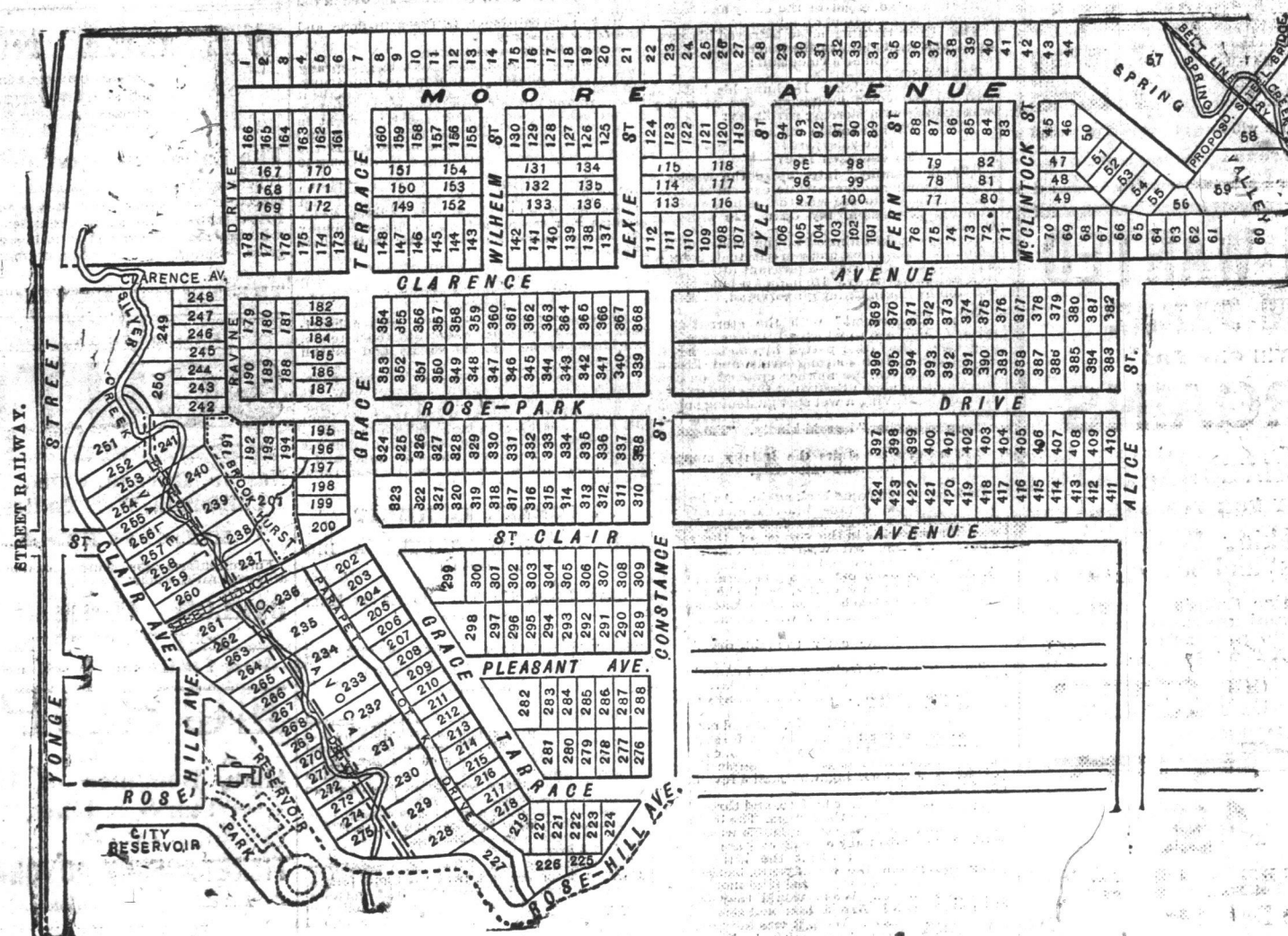
**MOORE PARK:**

THE PROJECTED SUBURBAN BELT LINE RAILWAY passes up Spring Valley through this property, promising rapid transit at an early day, which means that residents of Moore Park will reach, by luxurious cars, their places of business in less than half the time required from present up-town streets; and thus revolutionize residential ideas. Time saved and solid comfort! fifteen minutes from your breakfast table to your office!

THE CENTRAL AND CONVENIENT SITUATION of Moore Park will be obvious when it is stated that the Metropolitan Street Cars and Omnibus Lines on Yonge-st. are distant only 3 minutes' walk; while 5 minutes' walk down Yonge-st. reaches the Toronto Street Cars, or the Canadian Pacific North Toronto Station. Then to the east, 8 minutes' walk brings one to the new Canadian Pacific Eastern Junction; while two or three minutes will suffice to take one from his own door to the station of the Suburban Belt Line Railway when erected in Spring Valley.

THE NEW UPPER CANADA COLLEGE BUILDINGS having now been placed under contract, their completion is confidently expected before the end of the year. They will be in full view from Moore Park, being only ten minutes' walk distant. The Public School Trustees of a new section embracing Moore Park and Deer Park have just secured a beautiful site fronting on St. Clair-avenue, immediately adjoining this property and overlooking the "Vale of Avoca," where commodious buildings are to be erected, and a school of the highest excellence is to be established at once. This school will draw scholars from a superior neighborhood. Therefore Moore Park will be unsurpassed for the facilities it will afford its residents to obtain for their children the very best educational advantages---both ordinary and academic---and that at their very doors.

THAT THE PROPOSED SYSTEM OF BOULEVARDS and Park Drives enters Moore Park from the Reservoir Grounds on the south and threads its way through the "Vale of Avoca" may be an interesting feature to some. Others might be glad to lay out some of the nicely wooded lots in park-like surroundings for their homes, affording retired and restful retreats. Visit the place and see for yourself.

WE WISH TO SAY RIGHT HERE that this offering is a real opportunity. Those who grasp the combination of favorable conditions and foresee the certain issue, will do well to act promptly. The possibilities are sufficiently obvious. Nature has done her part well, and soon art and enterprise and architecture will also have done theirs. We repeat, that Moore Park challenges attention by reason of its attractiveness, healthfulness, prominence and accessibility, and we predict that values here will rapidly advance abreast of, and in a little while, beyond those which now prevail in fashionable residential quarters.

**MAKE A NOTE OF THIS!**

THAT A SUBURBAN BELT SYSTEM OF RAPID TRANSIT WILL BRING IN TORONTO, AS IT HAS DONE ELSEWHERE, A PERFECT REVOLUTION IN RESIDENTIAL NOTIONS. REASONABLE BUILDING RESTRICTIONS WILL BE IMPOSED TO SECURE A GOOD CLASS OF DWELLINGS.

THE TITLE TO MOORE PARK IS INDISPUTABLE, BEING A QUIETED TITLE.

For Plans, Prices, Terms and all particulars apply to the Vendor's Agents:

**A. E. MINKLER & CO.,**

4 KING-STREET EAST.

TELEPHONE 558.