

# Women Honor Indian Chief's White Spouse

**Monument Near Peru, Ind. Keeps Alive Memory of Captive's Romance—Stolen by Reds As Child.**

WASHINGTON, Jan. 15.—On the bank of the Mississippi River, near Peru, Ind., is a monument erected by the women of that country to the memory of Frances Slocum, a white woman who spent almost her entire life as the wife of an Indian chief, and whose story is full of romance and adventure.

In 1777 Wilkesbarre, Pa., was a struggling settlement made up of the cabins of a half dozen or more Quaker families. Among the families was one named Slocum, consisting of father and mother and four or five small children, one of whom, Frances, was then some six or seven years of age. One evening in the summer of 1777, while Frances and two or three of her playmates were amusing themselves in front of the cabin, on the edge of a forest, several Indians suddenly sprang upon them, killed one of the girls and carried Frances and another girl away into captivity. A sister and brother of Frances escaped, and gave the alarm, but nothing could be heard of the captives. The years rolled away, one after another, and the father and mother of Frances went down to their graves mourning the unknown fate of their little ones. Her brother and sisters grew up and became aged and gray-haired men and women, and still no tidings were received until three score years had slipped into the past. Sixty years after her capture the first information concerning her reached her aged relatives.

**Married Delaware Chief.**  
In 1824-5 George W. Ewing, United

States agent among the Miamis, then claiming nearly all the northern half of Indiana, visited the Indian village on the banks of the Mississippi, not far from where the city of Peru now stands. He stopped at the cabin of Sha-pah-can-nah, head of the tribe, and was received by the aged wife of the chief. In her movements about the wigwam she exhibited some parts of her body, and when Mr. Ewing became satisfied that she was not an Indian, but a white woman, he questioned her. She told him she was white, and that she had been stolen when a little child by some members of the Delaware tribe. She could not remember her name nor where her home had been, but believed her father's name was Slocum, and that he had lived somewhere on the banks of the Susquehanna. She had been adopted into the tribe of the Delawares and moved with them from place to place until she became a grown woman. She married a Delaware chief, who was killed in battle, and after a few years of widowhood had become the wife of Sha-pah-can-nah.

**An Undelivered Letter.**  
The Indian agent, who naturally was much interested in what he considered a strange and remarkable discovery of a captive, conceived the idea of using the newspapers as a medium for clearing up the mystery. He did not know whom to address, but sent the story to "The Editor of Any Newspaper" in Lancaster, Pa. No paper was published at the time in Lancaster, and the postmaster, not knowing to whom to deliver the letter, threw it upon a shelf in his office, where it remained for several years, until John W. Forney started a newspaper there. Then the postmaster, finding the letter one day, turned it over to Mr. Forney, who published it.

It was copied in several newspapers thru Pennsylvania, and in 1857 came under the notice of Isaac Slocum, a man nearly fourscore years of age. He recalled the incident of his childhood, and immediately prepared to

visit Indiana, taking with him another sister who had escaped the massacre. He told the Indian agent upon reaching the settlement that if the woman was his sister she would have upon one of the fingers of her left hand a scar made by him with a hammer. Brother and sisters met, but neither could recognize the other. The captive carried the scar, however, and when questioned, told the agent how it was caused, which corresponded with the statement Mr. Slocum had made. There was no longer any doubt of her identity, but having lived with the Indians for sixty years, she did not wish to leave them, and declined to return to Pennsylvania with her brother. She remained at the Indian village, where she died a few years later. She had several children, and quite a number of her descendants still live near Peru. One of her daughters married the son of a boy who had been stolen from his home in Kentucky.

**A Marble Shaft.**  
At the summit of a high knoll overlooking the Wabash River is a marble shaft erected to the memory of Pa-lonz-wa, chief of the Miami Indians, better known as Francis Godfrey, who was celebrated in his time.

The Miami, or Twightwees, as they were sometimes called, became a strong organization and proved to be the main enemies of the settlers in Kentucky. They had several noted chiefs, among them being Me-che-kan-nah-quah, or Little Turtle, Buck-ong-a-he-las, and Pa-lonz-wa, or Francis Godfrey. Little Turtle was entitled to rank among the greatest Indian chiefs in the country. As a general he was the superior of Oaccola, King Philip or Pontiac, and as a statesman he outranked all others. He commanded the Indians at the time of St. Clair's defeat, and in the two disastrous defeats of General Harmar.

The headquarters of the Miamis was near where Fort Wayne, Ind., now stands, and it was from there the orders went out for incursions into Kentucky, or to assemble for battle with

the armies of the whites. Little Turtle trained his warriors in the art of battle, which gave him absolute control of their movements; they advanced, fell back, moved to the right or left flank, with as much precision as the veteran troops of a civilized army. When he commanded he never suffered a defeat. He was present and took part in the battle of Fallen Timbers, where General Anthony Wayne overthrew the Shawnee, carried the day for a fight, and Little Turtle relinquished the command to him.

Little Turtle ruled the Miamis for 40 years and no chief ever wielded a more absolute influence than did he during all those years. After the defeat of the Indians by General Wayne, Little Turtle made peace and from that time until his death remained a steadfast friend of the whites. He kept the Miamis from taking the part of the British during the war of 1812. Unfortunately for the Americans he died just as that war was assuming serious proportions.

**Grave Overlooks Wabash.**  
Little Turtle was ever the advocate of up-right living among the tribes, discouraging drunkenness and all he civilized vices. In 1897 he visited President Washington at Philadelphia and was the recipient of marked attention. He met many distinguished foreigners who were sojourning in America at that time. Washington presented him a magnificent sword and caused his portrait to be painted by Gilbert Stuart. General Kosciuszko presented him a pair of handsomely mounted pistols. The exact location of his grave has been lost, but accounts of the great funeral accorded him are still on record. He was interred with all his adornments, the sword presented him by Washington and the silver medal carrying a portrait of President Washington. He was buried by the whites with great pomp, but no monument was erected to mark his grave.

The last two chiefs of the Miami died and were buried near Peru, Ind. The last great war chief was Pa-lonz-wa, or Francis Godfrey. He was a man of daring and courage, magnificent physique and persuasive eloquence, the son of a French father and an Indian mother. During nearly all the period of his chieftainship he was a firm friend of the whites. As early as 1822 he employed civilized workmen and built a large house on the Wabash, where he dispensed lavish hospitality to both whites and Indians. When the Miamis ceded their lands in Indiana to the government four sections were reserved on the Mississippi for Pa-lonz-wa. On this land he erected a trading post and became a prosperous merchant. He died in 1849 and is buried on a high knoll which overlooks the Wabash. His funeral was attended by whites from a hundred miles around and the ceremonies were conducted in a military manner.

**Example of High Virtues.**  
Over his grave a marble shaft was erected by contributions from the whites. On one side of the shaft is his white name, "Francis Godfrey," and on the other side is the following inscription:

Late Principal Chief of the Miami Nation Indians.  
Distinguished for Courage, Humanity, Benevolence and Honor.  
He lived in his native forests. An illustration of the nobleness of his race. Enjoying the confidence of his tribe and beloved by his American neighbors.  
He died as he lived.  
Without Fear or Reproach.

Wa-pa-pin-sha, a noted Indian orator of his tribe, delivered the principal address at the funeral and it is an excellent specimen of Indian oratory. He said:

"Brothers, the Great Spirit has taken to Himself another of our once powerful and happy but now declining nation. The time has been when these forests were densely populated by red

men, but the same hand whose blighting touch withered the majestic frame before us and caused the noble spirit by which it was animated to seek another home, had dealt in a like manner with his and our fathers. In a like manner will He deal with us. Death, of late, has been common among us, so much so that a recurrence of it scarcely elicits our notice. But when the brave, generous and patriotic, and as a tribute to his merit and a reward for his goodness, the tears, not only of his own people, but of many white men, who are here assembled to witness his funeral rites, freely flow.

"At this scene the poor of his people weep, because at his table they were wont to feast and rejoice. The weak mourn his death, because his authority was ever directed for their protection. But he has left the earth—the place of vexation and contention—and is now participating with Pocahontas and Lo-Lo in those joys prepared by the Great Spirit for such as well and faithfully discharge their duties here. Brothers, let us emulate his example and practice his virtues."

William E. Curtis.

"Our women students and our men too would receive greater benefit from the University could they gain the personal friendly aid of their instructors. It may suffice for the men to preach to both men and staff their duty in the matter. For the women the first step must be the creation of a larger staff of women instructors or the enlistment by the University of the women graduates of the city in this work."

"Questions have been asked and left unanswered. Each reader will doubtless answer them for himself, but it is hoped that in many cases this will involve earnest thought. The problems suggested can be solved, if we will."

## REIGN OF "KING" DRAWS TO CLOSE

**Power of Pataud Is Rapidly on Descent—Odd Story.**

PARIS, Jan. 15.—Absurd reports to the effect that the Duke of Orleans attempted to make a secret entry into Paris during the Christmas fete and that his surprise visit was to have been the signal for the strike of the electricians have greatly amused the notorious "King" Pataud. He professes to despise M. Lepine, who, after the Prime Minister, is the most powerful official in Paris. Still more amusing, M. Pataud openly scoffs at M. Briand. "Clemenceau did not terrify me, and as for his successor, I laugh at him," the great strike organizer declares. In reality, however, the reign of "King" Pataud is fast drawing to a close.

"M. Briand requests me to tell you that he has had enough of your threats, and to give you solemn warning that you will get into trouble if they are repeated," said M. Tissier, the Premier's chief secretary, when Pataud called at the Ministry of the Interior the other night. As the intruder protested, M. Tissier showed him the door, and Pataud left the premises crestfallen and humiliated. His power is gone. No longer can he plunge the electric light into darkness, for the Government has caused emergency electric cables to be laid down through the length and breadth of Paris, which, if connected with the power stations of the Metropolitan Railway, would secure a sufficient supply of electric light in the event of a strike. The Metropolitan Railway electricians are, as I have said in former messages, dead against M. Pataud, and so are a great number of the trade unionists whom he is supposed to represent.

"The Little Damsel" was transferred in its entirety from Wyndham's Theatre to the Prince of Wales's on Boxing Night. The success of Mr. Monckton Hoffe's brilliant comedy is undeniable, and it is playing to excellent business. On Monday Mr. Fred Terry and Miss Julia Neilson re-opened at the New with Henry of Navarre.

# THE PLAN OF NEW LISKEARD

which I promised in a previous advertisement appears to-day. This plan shows the whole lay-out of New Liskeard, the darkened portions being those sections in which I am offering choice lots.

It will be noticed that these sections are in the most desirable portions of the town.

As I have already pointed out New Liskeard must grow, by reason of the fact that it is the gateway to one of Ontario's greatest farming areas.

The new gold discoveries of the north will help New Liskeard, and my advice to prospective purchasers is—make your selection early if you want a choice location.

Already a number of lots have been sold and in a short time the best bargains will be gone.

Full particulars from

**GEORGE WEAVER**  
THE BUSINESS EXCHANGE  
(POST OFFICE BLOCK)  
NEW LISKEARD, - ONT.

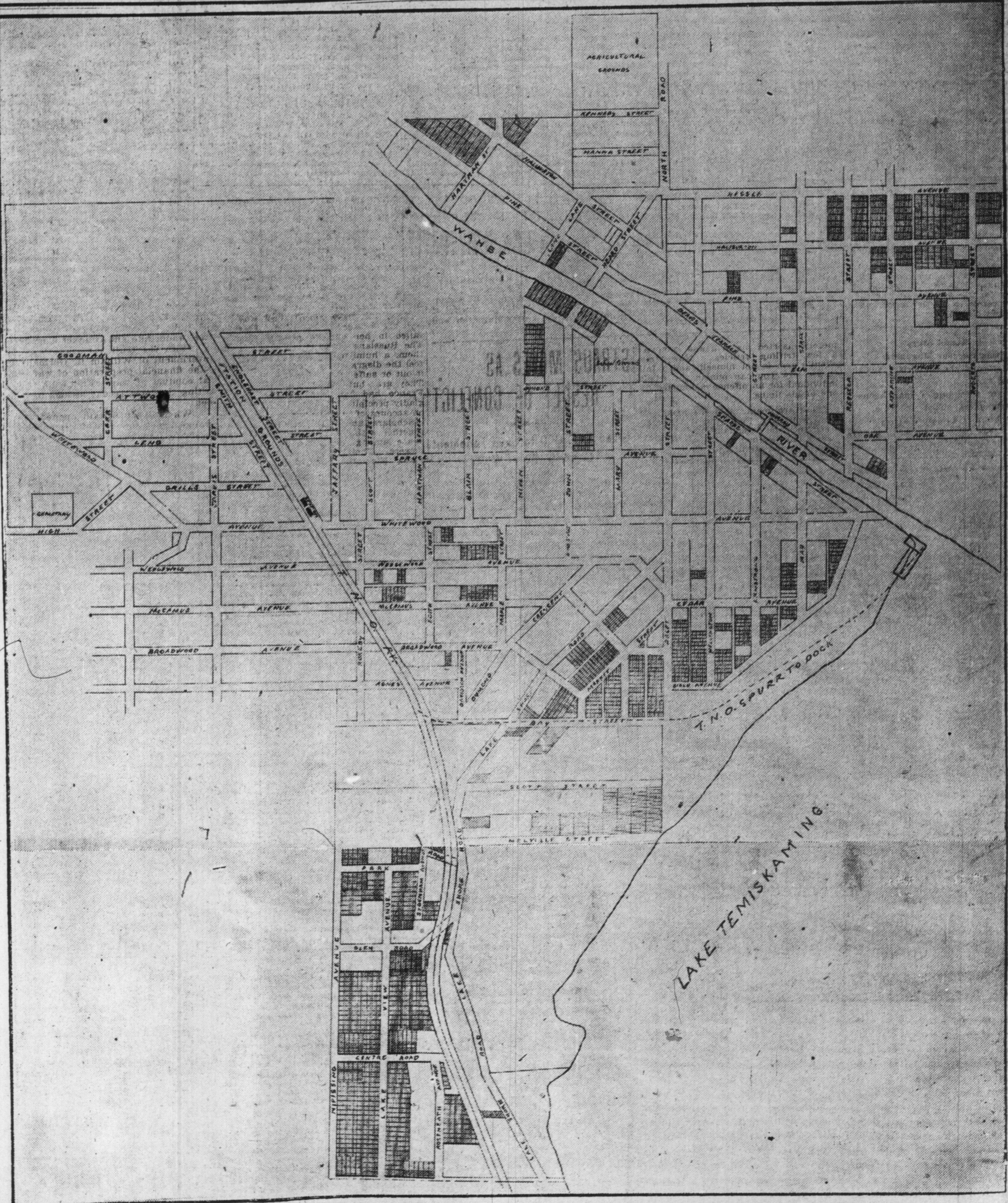

Plan of the Town of New Liskeard, the darkened portions being the sections in which I am offering lots and terms at reasonable price.

## Panic of Analy

**Depression Reduces Marriages in England**

**How Panic Affects Rate in**

Following is a table comparing with the number of marriages in 1904-5 to 1908-9, the first on the basis upon the number

1904-5	1000
1905-6	1000
1906-7	1000
1907-8	1000
1908-9	1000

The statistics for the year 1 to September 1909 show that the rate was not great effect on the number of

NEW YORK, Jan. 15.—The rate of increase in births during 1909 was given as the cause of the panic, as he reviewed the statistics for the past year by the health department.

"Altho the financial depression in the fall of 1907," he reported, "it was not generally the industrial and commercial depression of 1908. Every one expected a recovery in 1909, and the immediate effect of the depression of 1908 was a decrease of marriages. Darlington's figures show a number of marriages were to 44,839 in 1908, an increase of 1907, but this is not due to any increase of marriage, but to who delayed weddings times should get better. Now, this decrease of marriages in 1909 is approximately the decrease of marriages in 1908 is approximately the decrease of marriages in 1907 is approximately the decrease of marriages in 1906 is approximately the decrease of marriages in 1905 is approximately the decrease of marriages in 1904 is approximately the decrease of marriages in 1903 is approximately the decrease of marriages in 1902 is approximately the decrease of marriages in 1901 is approximately the decrease of marriages in 1900 is approximately the decrease of marriages in 1899 is approximately the decrease of marriages in 1898 is approximately the decrease of marriages in 1897 is approximately the decrease of marriages in 1896 is approximately the decrease of marriages in 1895 is approximately the decrease of marriages in 1894 is approximately the decrease of marriages in 1893 is approximately the decrease of marriages in 1892 is approximately the decrease of marriages in 1891 is approximately the decrease of marriages in 1890 is approximately the decrease of marriages in 1889 is approximately the decrease of marriages in 1888 is approximately the decrease of marriages in 1887 is approximately the decrease of marriages in 1886 is approximately the decrease of marriages in 1885 is approximately the decrease of marriages in 1884 is approximately the decrease of marriages in 1883 is approximately the decrease of marriages in 1882 is approximately the decrease of marriages in 1881 is approximately the decrease of marriages in 1880 is approximately the decrease of marriages in 1879 is approximately the decrease of marriages in 1878 is approximately the decrease of marriages in 1877 is approximately the decrease of marriages in 1876 is approximately the decrease of marriages in 1875 is approximately the decrease of marriages in 1874 is approximately the decrease of marriages in 1873 is approximately the decrease of marriages in 1872 is approximately the decrease of marriages in 1871 is approximately the decrease of marriages in 1870 is approximately the decrease of marriages in 1869 is approximately the decrease of marriages in 1868 is approximately the decrease of marriages in 1867 is approximately the decrease of marriages in 1866 is approximately the decrease of marriages in 1865 is approximately the decrease of marriages in 1864 is approximately the decrease of marriages in 1863 is approximately the decrease of marriages in 1862 is approximately the decrease of marriages in 1861 is approximately the decrease of marriages in 1860 is approximately the decrease of marriages in 1859 is approximately the decrease of marriages in 1858 is approximately the decrease of marriages in 1857 is approximately the decrease of marriages in 1856 is approximately the decrease of marriages in 1855 is approximately the decrease of marriages in 1854 is approximately the decrease of marriages in 1853 is approximately the decrease of marriages in 1852 is approximately the decrease of marriages in 1851 is approximately the decrease of marriages in 1850 is approximately the decrease of marriages in 1849 is approximately the decrease of marriages in 1848 is approximately the decrease of marriages in 1847 is approximately the decrease of marriages in 1846 is approximately the decrease of marriages in 1845 is approximately the decrease of marriages in 1844 is approximately the decrease of marriages in 1843 is approximately the decrease of marriages in 1842 is approximately the decrease of marriages in 1841 is approximately the decrease of marriages in 1840 is approximately the decrease of marriages in 1839 is approximately the decrease of marriages in 1838 is approximately the decrease of marriages in 1837 is approximately the decrease of marriages in 1836 is approximately the decrease of marriages in 1835 is approximately the decrease of marriages in 1834 is approximately the decrease of marriages in 1833 is approximately the decrease of marriages in 1832 is approximately the decrease of marriages in 1831 is approximately the decrease of marriages in 1830 is approximately the decrease of marriages in 1829 is approximately the decrease of marriages in 1828 is approximately the decrease of marriages in 1827 is approximately the decrease of marriages in 1826 is approximately the decrease of marriages in 1825 is approximately the decrease of marriages in 1824 is approximately the decrease of marriages in 1823 is approximately the decrease of marriages in 1822 is approximately the decrease of marriages in 1821 is approximately the decrease of marriages in 1820 is approximately the decrease of marriages in 1819 is approximately the decrease of marriages in 1818 is approximately the decrease of marriages in 1817 is approximately the decrease of marriages in 1816 is approximately the decrease of marriages in 1815 is approximately the decrease of marriages in 1814 is approximately the decrease of marriages in 1813 is approximately the decrease of marriages in 1812 is approximately the decrease of marriages in 1811 is approximately the decrease of marriages in 1810 is approximately the decrease of marriages in 1809 is approximately the decrease of marriages in 1808 is approximately the decrease of marriages in 1807 is approximately the decrease of marriages in 1806 is approximately the decrease of marriages in 1805 is approximately the decrease of marriages in 1804 is approximately the decrease of marriages in 1803 is approximately the decrease of marriages in 1802 is approximately the decrease of marriages in 1801 is approximately the decrease of marriages in 1800 is approximately the decrease of marriages in 1799 is approximately the decrease of marriages in 1798 is approximately the decrease of marriages in 1797 is approximately the decrease of marriages in 1796 is approximately the decrease of marriages in 1795 is approximately the decrease of marriages in 1794 is approximately the decrease of marriages in 1793 is approximately the decrease of marriages in 1792 is approximately the decrease of marriages in 1791 is approximately the decrease of marriages in 1790 is approximately the decrease of marriages in 1789 is approximately the decrease of marriages in 1788 is approximately the decrease of marriages in 1787 is approximately the decrease of marriages in 1786 is approximately the decrease of marriages in 1785 is approximately the decrease of marriages in 1784 is approximately the decrease of marriages in 1783 is approximately the decrease of marriages in 1782 is approximately the decrease of marriages in 1781 is approximately the decrease of marriages in 1780 is approximately the decrease of marriages in 1779 is approximately the decrease of marriages in 1778 is approximately the decrease of marriages in 1777 is approximately the decrease of marriages in 1776 is approximately the decrease of marriages in 1775 is approximately the decrease of marriages in 1774 is approximately the decrease of marriages in 1773 is approximately the decrease of marriages in 1772 is approximately the decrease of marriages in 1771 is approximately the decrease of marriages in 1770 is approximately the decrease of marriages in 1769 is approximately the decrease of marriages in 1768 is approximately the decrease of marriages in 1767 is approximately the decrease of marriages in 1766 is approximately the decrease of marriages in 1765 is approximately the decrease of marriages in 1764 is approximately the decrease of marriages in 1763 is approximately the decrease of marriages in 1762 is approximately the decrease of marriages in 1761 is approximately the decrease of marriages in 1760 is approximately the decrease of marriages in 1759 is approximately the decrease of marriages in 1758 is approximately the decrease of marriages in 1757 is approximately the decrease of marriages in 1756 is approximately the decrease of marriages in 1755 is approximately the decrease of marriages in 1754 is approximately the decrease of marriages in 1753 is approximately the decrease of marriages in 1752 is approximately the decrease of marriages in 1751 is approximately the decrease of marriages in 1750 is approximately the decrease of marriages in 1749 is approximately the decrease of marriages in 1748 is approximately the decrease of marriages in 1747 is approximately the decrease of marriages in 1746 is approximately the decrease of marriages in 1745 is approximately the decrease of marriages in 1744 is approximately the decrease of marriages in 1743 is approximately the decrease of marriages in 1742 is approximately the decrease of marriages in 1741 is approximately the decrease of marriages in 1740 is approximately the decrease of marriages in 1739 is approximately the decrease of marriages in 1738 is approximately the decrease of marriages in 1737 is approximately the decrease of marriages in 1736 is approximately the decrease of marriages in 1735 is approximately the decrease of marriages in 1734 is approximately the decrease of marriages in 1733 is approximately the decrease of marriages in 1732 is approximately the decrease of marriages in 1731 is approximately the decrease of marriages in 1730 is approximately the decrease of marriages in 1729 is approximately the decrease of marriages in 1728 is approximately the decrease of marriages in 1727 is approximately the decrease of marriages in 1726 is approximately the decrease of marriages in 1725 is approximately the decrease of marriages in 1724 is approximately the decrease of marriages in 1723 is approximately the decrease of marriages in 1722 is approximately the decrease of marriages in 1721 is approximately the decrease of marriages in 1720 is approximately the decrease of marriages in 1719 is approximately the decrease of marriages in 1718 is approximately the decrease of marriages in 1717 is approximately the decrease of marriages in 1716 is approximately the decrease of marriages in 1715 is approximately the decrease of marriages in 1714 is approximately the decrease of marriages in 1713 is approximately the decrease of marriages in 1712 is approximately the decrease of marriages in 1711 is approximately the decrease of marriages in 1710 is approximately the decrease of marriages in 1709 is approximately the decrease of marriages in 1708 is approximately the decrease of marriages in 1707 is approximately the decrease of marriages in 1706 is approximately the decrease of marriages in 1705 is approximately the decrease of marriages in 1704 is approximately the decrease of marriages in 1703 is approximately the decrease of marriages in 1702 is approximately the decrease of marriages in 1701 is approximately the decrease of marriages in 1700 is approximately the decrease of marriages in 1699 is approximately the decrease of marriages in 1698 is approximately the decrease of marriages in 1697 is approximately the decrease of marriages in 1696 is approximately the decrease of marriages in 1695 is approximately the decrease of marriages in 1694 is approximately the decrease of marriages in 1693 is approximately the decrease of marriages in 1692 is approximately the decrease of marriages in 1691 is approximately the decrease of marriages in 1690 is approximately the decrease of marriages in 1689 is approximately the decrease of marriages in 1688 is approximately the decrease of marriages in 1687 is approximately the decrease of marriages in 1686 is approximately the decrease of marriages in 1685 is approximately the decrease of marriages in 1684 is approximately the decrease of marriages in 1683 is approximately the decrease of marriages in 1682 is approximately the decrease of marriages in 1681 is approximately the decrease of marriages in 1680 is approximately the decrease of marriages in 1679 is approximately the decrease of marriages in 1678 is approximately the decrease of marriages in 1677 is approximately the decrease of marriages in 1676 is approximately the decrease of marriages in 1675 is approximately the decrease of marriages in 1674 is approximately the decrease of marriages in 1673 is approximately the decrease of marriages in 1672 is approximately the decrease of marriages in 1671 is approximately the decrease of marriages in 1670 is approximately the decrease of marriages in 1669 is approximately the decrease of marriages in 1668 is approximately the decrease of marriages in 1667 is approximately the decrease of marriages in 1666 is approximately the decrease of marriages in 1665 is approximately the decrease of marriages in 1664 is approximately the decrease of marriages in 1663 is approximately the decrease of marriages in 1662 is approximately the decrease of marriages in 1661 is approximately the decrease of marriages in 1660 is approximately the decrease of marriages in 1659 is approximately the decrease of marriages in 1658 is approximately the decrease of marriages in 1657 is approximately the decrease of marriages in 1656 is approximately the decrease of marriages in 1655 is approximately the decrease of marriages in 1654 is approximately the decrease of marriages in 1653 is approximately the decrease of marriages in 1652 is approximately the decrease of marriages in 1651 is approximately the decrease of marriages in 1650 is approximately the decrease of marriages in 1649 is approximately the decrease of marriages in 1648 is approximately the decrease of marriages in 1647 is approximately the decrease of marriages in 1646 is approximately the decrease of marriages in 1645 is approximately the decrease of marriages in 1644 is approximately the decrease of marriages in 1643 is approximately the decrease of marriages in 1642 is approximately the decrease of marriages in 1641 is approximately the decrease of marriages in 1640 is approximately the decrease of marriages in 1639 is approximately the decrease of marriages in 1638 is approximately the decrease of marriages in 1637 is approximately the decrease of marriages in 1636 is approximately the decrease of marriages in 1635 is approximately the decrease of marriages in 1634 is approximately the decrease of marriages in 1633 is approximately the decrease of marriages in 1632 is approximately the decrease of marriages in 1631 is approximately the decrease of marriages in 1630 is approximately the decrease of marriages in 1629 is approximately the decrease of marriages in 1628 is approximately the decrease of marriages in 1627 is approximately the decrease of marriages in 1626 is approximately the decrease of marriages in 1625 is approximately the decrease of marriages in 1624 is approximately the decrease of marriages in 1623 is approximately the decrease of marriages in 1622 is approximately the decrease of marriages in 1621 is approximately the decrease of marriages in 1620 is approximately the decrease of marriages in 1619 is approximately the decrease of marriages in 1618 is approximately the decrease of marriages in 1617 is approximately the decrease of marriages in 1616 is approximately the decrease of marriages in 1615 is approximately the decrease of marriages in 1614 is approximately the decrease of marriages in 1613 is approximately the decrease of marriages in 1612 is approximately the decrease of marriages in 1611 is approximately the decrease of marriages in 1610 is approximately the decrease of marriages in 1609 is approximately the decrease of marriages in 1608 is approximately the decrease of marriages in 1607 is approximately the decrease of marriages in 1606 is approximately the decrease of marriages in 1605 is approximately the decrease of marriages in 1604 is approximately the decrease of marriages in 1603 is approximately the decrease of marriages in 1602 is approximately the decrease of marriages in 1601 is approximately the decrease of marriages in 1600 is approximately the decrease of marriages in 1599 is approximately the decrease of marriages in 1598 is approximately the decrease of marriages in 1597 is approximately the decrease of marriages in 1596 is approximately the decrease of marriages in 1595 is approximately the decrease of marriages in 1594 is approximately the decrease of marriages in 1593 is approximately the decrease of marriages in 1592 is approximately the decrease of marriages in 1591 is approximately the decrease of marriages in 1590 is approximately the decrease of marriages in 1589 is approximately the decrease of marriages in 1588 is approximately the decrease of marriages in 1587 is approximately the decrease of marriages in 1586 is approximately the decrease of marriages in 1585 is approximately the decrease of marriages in 1584 is approximately the decrease of marriages in 1583 is approximately the decrease of marriages in 1582 is approximately the decrease of marriages in 1581 is approximately the decrease of marriages in 1580 is approximately the decrease of marriages in 1579 is approximately the decrease of marriages in 1578 is approximately the decrease of marriages in 1577 is approximately the decrease of marriages in 1576 is approximately the decrease of marriages in 1575 is approximately the decrease of marriages in 1574 is approximately the decrease of marriages in 1573 is approximately the decrease of marriages in 1572 is approximately the decrease of marriages in 1571 is approximately the decrease of marriages in 1570 is approximately the decrease of marriages in 1569 is approximately the decrease of marriages in 1568 is approximately the decrease of marriages in 1567 is approximately the decrease of marriages in 1566 is approximately the decrease of marriages in 1565 is approximately the decrease of marriages in 1564 is approximately the decrease of marriages in 1563 is approximately the decrease of marriages in 1562 is approximately the decrease of marriages in 1561 is approximately the decrease of marriages in 1560 is approximately the decrease of marriages in 1559 is approximately the decrease of marriages in 1558 is approximately the decrease of marriages in 1557 is approximately the decrease of marriages in 1556 is approximately the decrease of marriages in 1555 is approximately the decrease of marriages in 1554 is approximately the decrease of marriages in 1553 is approximately the decrease of marriages in 1552 is approximately the decrease of marriages in 1551 is approximately the decrease of marriages in 1550 is approximately the decrease of marriages in 1549 is approximately the decrease of marriages in 1548 is approximately the decrease of marriages in 1547 is approximately the decrease of marriages in 1546 is approximately the decrease of marriages in 1545 is approximately the decrease of marriages in 1544 is approximately the decrease of marriages in 1543 is approximately the decrease of marriages in 1542 is approximately the decrease of marriages in 1541 is approximately the decrease of marriages in 1540 is approximately the decrease of marriages in 1539 is approximately the decrease of marriages in 1538 is approximately the decrease of marriages in 1537 is approximately the decrease of marriages in 1536 is approximately the decrease of marriages in 1535 is approximately the decrease of marriages in 1534 is approximately the decrease of marriages in 1533 is approximately the decrease of marriages in 1532 is approximately the decrease of marriages in 1531 is approximately the decrease of marriages in 1530 is approximately the decrease of marriages in 1529 is approximately the decrease of marriages in 1528 is approximately the decrease of marriages in 1527 is approximately the decrease of marriages in 1526 is approximately the decrease of marriages in 1525 is approximately the decrease of marriages in 1524 is approximately the decrease of marriages in 1523 is approximately the decrease of marriages in 1522 is approximately the decrease of marriages in 1521 is approximately the decrease of marriages in 1520 is approximately the decrease of marriages in 1519 is approximately the decrease of marriages in 1518 is approximately the decrease of marriages in 1517 is approximately the decrease of marriages in 1516 is approximately the decrease of marriages in 1515 is approximately the decrease of marriages in 1514 is approximately the decrease of marriages in 1513 is approximately the decrease of marriages in 1512 is approximately the decrease of marriages in 1511 is approximately the decrease of marriages in 1510 is approximately the decrease of marriages in 1509 is approximately the decrease of marriages in 1508 is approximately the decrease of marriages in 1507 is approximately the decrease of marriages in 1506 is approximately the decrease of marriages in 1505 is approximately the decrease of marriages in 1504 is approximately the decrease of marriages in 1503 is approximately the decrease of marriages in 1502 is approximately the decrease of marriages in 1501 is approximately the decrease of marriages in 1500 is approximately the decrease of marriages in 1499 is approximately the decrease of marriages in 1498 is approximately the decrease of marriages in 1497 is approximately the decrease of marriages in 1496 is approximately the decrease of marriages in 1495 is approximately the decrease of marriages in 1494 is approximately the decrease of marriages in 1493 is approximately the decrease of marriages in 1492 is approximately the decrease of marriages in 1491 is approximately the decrease of marriages in 1490 is approximately the decrease of marriages in 1489 is approximately the decrease of marriages in 1488 is approximately the decrease of marriages in 1487 is approximately the decrease of marriages in 1486 is approximately the decrease of marriages in 1485 is approximately the decrease of marriages in 1484 is approximately the decrease of marriages in 1483 is approximately the decrease of marriages in 1482 is approximately the decrease of marriages in 1481 is approximately the decrease of marriages in 1480 is approximately the decrease of marriages in 1479 is approximately the decrease of marriages in 1478 is approximately the decrease of marriages in 1477 is approximately the decrease of marriages in 1476 is approximately the decrease of marriages in 1475 is approximately the decrease of marriages in 1474 is approximately the decrease of marriages in 1473 is approximately the decrease of marriages in 1472 is approximately the decrease of marriages in 1471 is approximately the decrease of marriages in 1470 is approximately the decrease of marriages in 1469 is approximately the decrease of marriages in 1468 is approximately the decrease of marriages in 1467 is approximately the decrease of marriages in 1466 is approximately the decrease of marriages in 1465 is approximately the decrease of marriages in 1464 is approximately the decrease of marriages in 1463 is approximately the decrease of marriages in 1462 is approximately the decrease of marriages in 1461 is approximately the decrease of marriages in 1460 is approximately the decrease of marriages in 1459 is approximately the decrease of marriages in 1458 is approximately the decrease of marriages in 1457 is approximately the decrease of marriages in 1456 is approximately the decrease of marriages in 1455 is approximately the decrease of marriages in 1454 is approximately the decrease of marriages in 1453 is approximately the decrease of marriages in 1452 is approximately the decrease of marriages in 1451 is approximately the decrease of marriages in 1450 is approximately the decrease of marriages in 1449 is approximately the decrease of marriages in 1448 is approximately the decrease of marriages in 1447 is approximately the decrease of marriages in 1446 is approximately the decrease of marriages in 1445 is approximately the decrease of marriages in 1444 is approximately the decrease of marriages in 1443 is approximately the decrease of marriages in 1442 is approximately the decrease of marriages in 1441 is approximately the decrease of marriages in 1440 is approximately the decrease of marriages in 1439 is approximately the decrease of marriages in 1438 is approximately the decrease of marriages in 1437 is approximately the decrease of marriages in 1436 is approximately the decrease of marriages in 1435 is approximately the decrease of marriages in 1434 is approximately the decrease of marriages in 1433 is approximately the decrease of marriages in 1432 is approximately the decrease of marriages in 1431 is approximately the decrease of marriages in 1430 is approximately the decrease of marriages in 1429 is approximately the decrease of marriages in 1428 is approximately the decrease of marriages in 1427 is approximately the decrease of marriages in 1426 is approximately the decrease of marriages in 1425 is approximately the decrease of marriages in 1424 is approximately the decrease of marriages in 1423 is approximately the decrease of marriages in 1422 is approximately the decrease of marriages in 1421 is approximately the decrease of marriages in 1420 is approximately the decrease of marriages in 1419 is approximately the decrease of marriages in 1418 is approximately the decrease of marriages in 1417 is approximately the decrease of marriages in 1416 is approximately the decrease of marriages in 1415 is approximately the decrease of marriages in 1414 is approximately the decrease of marriages in 1413 is approximately the decrease of marriages in 1412 is approximately the decrease of marriages in 1411 is approximately the decrease of marriages in 1410 is approximately the decrease of marriages in 1409 is approximately the decrease of marriages in 1408 is approximately the decrease of marriages in 1407 is approximately the decrease of marriages in 1406 is approximately the decrease of marriages in 1405 is approximately the decrease of marriages in 1404 is approximately the decrease of marriages in 1403 is approximately the decrease of marriages in 1402 is approximately the decrease of marriages in 1401 is approximately the decrease of marriages in 1400 is approximately the decrease of marriages in 1399 is approximately the decrease of marriages in 1398 is approximately the decrease of marriages in 1397 is approximately the decrease of marriages in 1396 is approximately the decrease of marriages in 1395 is approximately the decrease of marriages in 1394 is approximately the decrease of marriages in 1393 is approximately the decrease of marriages in 1392 is approximately the decrease of marriages in 1391 is approximately the decrease of marriages in 1390 is approximately the decrease of marriages in 1389 is approximately the decrease of marriages in 1388 is approximately the decrease of marriages in 1387 is approximately the decrease of marriages in 1386 is approximately the decrease of marriages in 1385 is approximately the decrease of marriages in 1384 is approximately the decrease of marriages in 1383 is approximately the decrease of marriages in 1382 is approximately the decrease of marriages in 1381 is approximately the decrease of marriages in 1380 is approximately the decrease of marriages in 1379 is approximately the decrease of marriages in 1378 is approximately the decrease of marriages in 1377 is approximately the decrease of marriages in 1376 is approximately the decrease of marriages in 1375 is approximately the decrease of marriages in 1374 is approximately the decrease of marriages in 1373 is approximately the decrease of marriages in 1372 is approximately the decrease of marriages in 1371 is approximately the decrease of marriages in 1370 is approximately the decrease of marriages in 1369 is approximately the decrease of marriages in 1368 is approximately the decrease of marriages in 1367 is approximately the decrease of marriages in 1366 is approximately the decrease of marriages in 1365 is approximately the decrease of marriages in 1364 is approximately the decrease of marriages in 1363 is approximately the decrease of marriages in 1362 is approximately the decrease of marriages in 1361 is approximately the decrease of marriages in 1360 is approximately the decrease of marriages in 1359 is approximately the decrease of marriages in 1358 is approximately the decrease of marriages in 1357 is approximately the decrease of marriages in 1356 is approximately the decrease of marriages in 1355 is approximately the decrease of marriages in 1354 is approximately the decrease of marriages in 1353 is approximately the decrease of marriages in 1352 is approximately the decrease of marriages in 1351 is approximately the decrease of marriages in 1350 is approximately the decrease of marriages in 1349 is approximately the decrease of marriages in 1348 is approximately the decrease of marriages in 1347 is approximately the decrease of marriages in 1346 is approximately the decrease of marriages in 1345 is approximately the decrease of marriages in 1344 is approximately the decrease of marriages in 1343 is approximately the decrease of marriages in 1342 is approximately the decrease of marriages in 1341 is approximately the decrease of marriages in 1340 is approximately the decrease of marriages in 1339 is approximately the decrease of marriages in 1338 is approximately the decrease of marriages in 1337 is approximately the decrease of marriages in 1336 is approximately the decrease of marriages in 1335 is approximately the decrease of marriages in 1334 is approximately the decrease of marriages in 1333 is approximately the decrease of marriages in 1332 is approximately the decrease of marriages in 1331 is approximately the decrease of marriages in 1330 is approximately the decrease of marriages in 1329 is approximately the decrease of marriages in 1328 is approximately the decrease of marriages in 1327 is approximately the decrease of marriages in 1326 is approximately the decrease of marriages in 1325 is approximately the decrease of marriages in 1324 is approximately the decrease of marriages in 1323 is approximately the decrease of marriages in