

THE CANADIAN ARCHITECT AND BUILDER

Vol. XIX.—No. 2.

TORONTO, MONTREAL — FEBRUARY, 1906 — WINNIPEG, VANCOUVER

PRICE 20 CENTS
\$2.00 PER YEAR

TILES MOSAICS PAIENCE GRAVEN, DUNNILL & CO., LIMITED

JACKFIELD, E. S. O., SHROPSHIRE.
SHOWROOMS—
London: 37, Maddox St., Regent St., W.
Birmingham: 174, Corporation Street.
Manchester: 64, Bridge St., Deansgate.

ENAMELS LUSTRES WALLS

ARCHITECTS

Call or Send for Details and Catalog of our
FIREPROOF METAL WINDOWS

Manufacturers and Contractors
FOR SKYLIGHTS, CORRUGATED IRON, METAL CEILINGS, COR-
NICES, ALSO WILSON'S ROLLER STEEL CURTAINS, FIREPROOF
DOORS, ETC., Recommended by Fire Underwriters.

A. B. ORMSBY, LIMITED, Felt, Slate and Gravel Roofers
Factories: Cor. Queen and George, Toronto, 677-9 Notre Dame Ave. W., Winnipeg

OTIS-FENSOM ELEVATOR CO., Limited

MANUFACTURERS OF "OTIS STANDARD ELEVATORS"

HEAD OFFICE:
CONFEDERATION LIFE BLDG.,
TORONTO.

MONTREAL OFFICE
423 ST. JAMES ST.

WINNIPEG OFFICE
44 CANADA LIFE BUILDING.

"MADE IN CANADA"

Bent Glass

Made in all Kinds of Glass
on Short Notice.

Large Bent Plate Glass for
Shop Fronts a Specialty.

Toronto Plate
Glass Importing Co.

(HILL & RUTHERFORD)
135-143 Victoria Street

BENDING WORKS:
209-213 Victoria Street
TORONTO

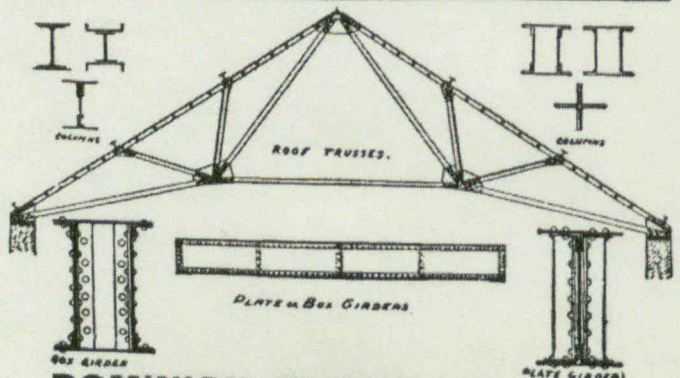

DOMINION BRIDGE CO. (LIMITED)

WE BUILD { Bridges of all designs in both Iron and Steel, Roofs, Telephone
Poles, House Girders and all kinds of Structural Iron Work.

OUR STOCK IN
HAND COMPRISES { Steel Beams, Angles, Tees, Channels, Plates, Rolled Edged
Flats, Bars, Rivets, Rounds, &c. Iron Beams, Bars,
Squares, Turnbuckles, Rivets, &c.

Estimates furnished for Structural Iron Work delivered at building or erected

GEORGE E. EVANS,
Ontario Agency: Room 35, Canada Life
Building, Toronto. Telephone Main 2164

Post Office Address:
DOMINION BRIDGE CO., Ltd., Montreal, P. Q.
Works at Lachine Locks, P. Q.

TURNBULL ELEVATORS

SEE AD. PAGE VIII

The Turnbull Elevator Mfg. Co. Toronto

ELEVATORS

For all purposes. Satisfaction guaranteed.
Write for prices and references

THE PARKIN ELEVATOR WORKS
258 Catherine Street North,
HAMILTON, ONT.