

ornithology, mineralogy and entomology

The Curator's private room and general office are easily accessible to visitors, next the records room, thus concentrating the administration of the building in one portion. In the lobby, giving access to the general offices, is located the cases for photographs, etc., thus if necessary being in

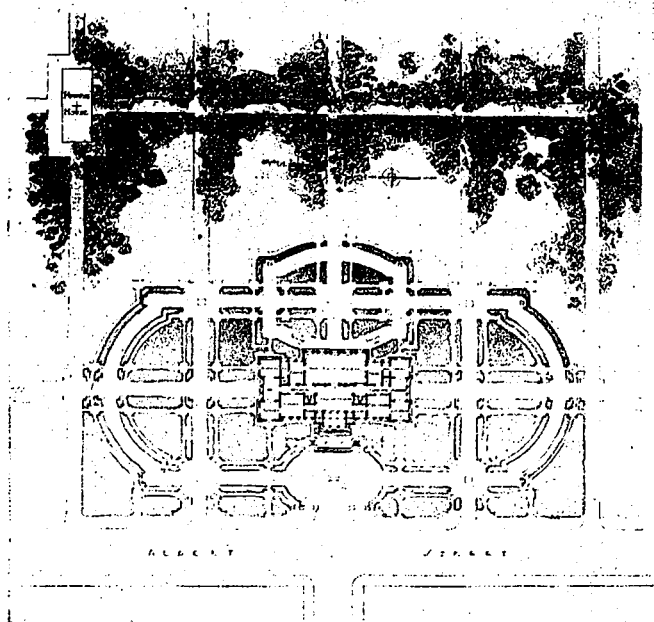

BLOCK PLAN.

the care of one of the assistants employed therein.

Two staircases giving approaches to the lower floor, a spacious goods hoist, a coat room, and a private lavatory occupy the remaining space on this, the principal floor.

The lower floor contains a receiving, unpack-

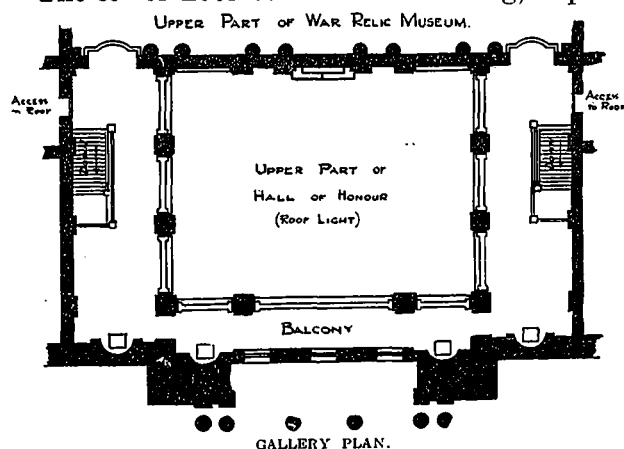

COMPETITIVE DESIGN, WAR MEMORIAL MUSEUM, REGINA, SASK.

DAVID WEBSTER, ARCHITECT.

ing and storage room for exhibits, close to the goods hoist, with a separate entrance, a repair room, ample rooms for spare collections and stores, while public lavatories are provided for both sexes. The approach for vehicles to the receiving room is on an inclined drive, thus de-

livering goods to the lower floor level. Provision has also been made for the delivery of large exhibits to the Museum Hall at the rear of the building, where an inclined roadway leading up to a special entrance is provided.

The cubical contents work out to a total of 496,327 cubic feet, allowance having been made for all foundations with a sufficient spread of footing to a depth of 12 feet below the mean level of the site, as well as for all parapets, dome and other features extending above the roof. At the unit of price of 80 cents per cubic foot mentioned in the conditions, the cost of the building would amount to \$397,061.60.

COMPETITIVE DESIGN: STOREY AND VAN EGMOND.

As the importance and interest of the building is the Hall of Honor and War Relics Museum, these have been placed in a central location. The Hall of Honor, being accepted as the more important room, is placed on the major and minor axis of the building. Both extend from the main floor to roof, or twice the height of the secondary exhibit rooms.

The entrance is through three arched portals into small storm vestibules which have been introduced owing to the extreme climatic conditions and thence into the main vestibule which has cloak room and photo room adjoining.

From the vestibule a comprehensive and interesting vista is afforded through the Hall of Honor and into the War Relics Museum to which one is naturally drawn through a succession of monumental rooms. The Hall of Honor has received careful monumental treatment with vaulted ceiling and side galleries, which afford recurring and different views as a circuit is made in the building. Provision has been made in the room for bronze tablets on which to record the names of men who fell in the war.

The War Relics Museum is lighted from High windows and a skylight, and in the simple treatment of walls and ceilings an interesting room is secured without elaborate detail, which would tend to detract from the exhibits to be placed in the room. At the extreme end a circular recess has been introduced to receive one of the large guns which the Province will have allotted to it. Adjoining this room is the small room required for records.

Through a careful study of the space required for Provincial Museum, it was concluded that the quite apparent subdivision of space would be to allocate the main exhibit rooms to the ground and first floors and place the spare collections, stores, repair and work rooms in the basement.

The stairs, although naturally located near the entrance to secure the desired circulation of the public, have been made to a certain extent secondary, as they lead only to rooms of the