

LEGEND - LÉGENDE

Table with two columns: English and French descriptions of map symbols. Symbols include roads, railways, bridges, buildings, and various terrain features like lakes and rivers.

GLOSSARY - GLOSSAIRE

RAISED BEACHES PLAGES SURÉLEVÉES

PHOTOGRAPHY PHOTOGRAPHIE

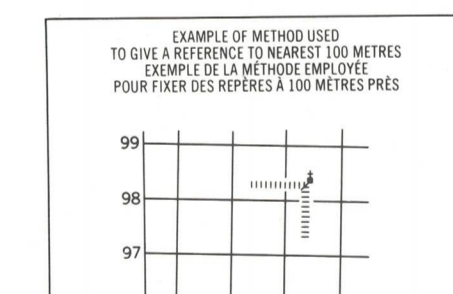
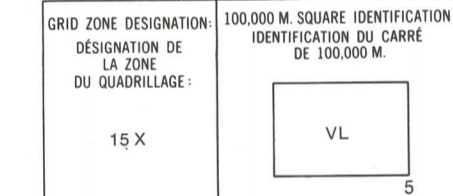
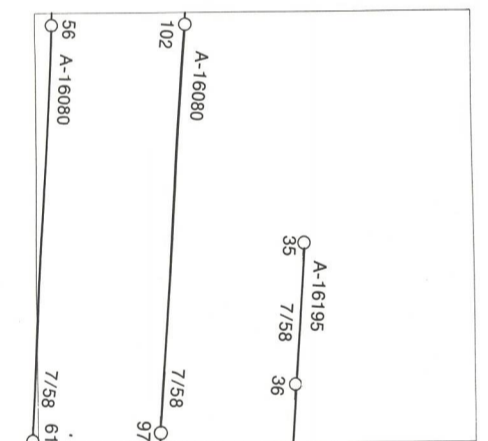

REFERENCE POINT CHURCH - EGLISE (in above or below)
EASTING: Read number on grid line immediately to left of point.
NORTHING: Read number on grid line immediately below point.

ONE THOUSAND METRE UNIVERSAL TRANSVERSE MERCATOR GRID ZONE 15

Grid of map sheet identifiers: 58 B/14, 58 B/15, 58 B/16, 58 B/11, 58 B/10, 58 B/9, 58 B/6, 58 B/7, 58 B/8.

The 1979 MAGNETIC BEARING is 42°17' (752 mils) WEST OF GRID NORTH.
ANNUAL CHANGE DECREASING 7.1'
GRID NORTH is 0°29' (58 mils) WEST OF TRUE NORTH for centre of map.

THE MAGNETIC COMPASS IS LIKELY TO BE USELESS IN THIS AREA.
LA BOUSOLE SERA PROBABLEMENT INUTILE DANS CETTE RÉGION.

PRODUCED BY THE SURVEYS AND MAPPING BRANCH, DEPARTMENT OF ENERGY, MINES AND RESOURCES, OTTAWA, 1978. INFORMATION CURRENT AS OF 1979.

ELEVATIONS IN METRES ABOVE MEAN SEA LEVEL
CONTOUR INTERVAL 10 METRES
NORTH AMERICAN DATUM 1927
TRANSVERSE MERCATOR PROJECTION

IDLOUT POINT
DISTRICT OF FRANKLIN
NORTHWEST TERRITORIES
Scale 1:50,000 Échelle

ELEVATIONS IN METRES ABOVE MEAN SEA LEVEL
CONTOUR INTERVAL 10 METRES
SYSTEME DE REFERENCE GEODESIQUE NORD-AMERICAIN 1927
PROJECTION TRANSVERSE DE MERCATOR

ÉTABLI PAR LA DIRECTION DES LEVÉS ET DE LA CARTOGRAPHIE, MINISTÈRE DE L'ÉNERGIE, DES MINES ET DES RESSOURCES, OTTAWA, EN 1978. RENSEIGNEMENTS À JOUR EN 1979.

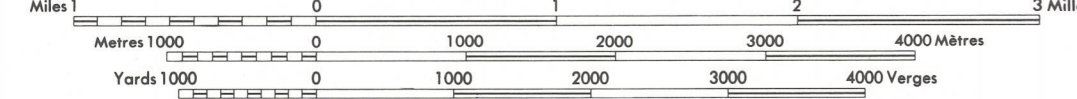

ON PEUT OBTENIR DES RENSEIGNEMENTS SUR LE LIEU ET L'ALTITUDE EXACTE DES REPERES DE NIVELLEMENT EN ÉCRIVANT AUX LEVÉS GÉODÉSIQUES, DIRECTION DES LEVÉS ET DE LA CARTOGRAPHIE, OTTAWA.

