

body with a central opening within said seat, and constructing the valve to open by its own weight, and supporting it by means of a

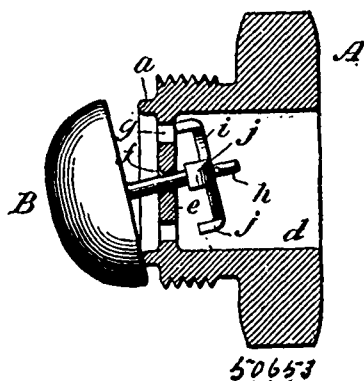

stem projecting rigidly from it and passing through said opening. 3rd. The described improvement in gravity steam-traps which consists in constructing the fixed body or shell with a perforated diaphragm within its seat, having a central opening for the passage of the valve stem, and constructing the valve to open by its own weight, with a stem rigidly projecting from it through said central opening, and a baffle-disc fixed on the stem on the opposite side of the diaphragm and adapted to strike the diaphragm when the valve opens to serve as a stop. 4th. The described improvement in gravity steam-traps consisting in constructing the fixed body or shell with a discharge opening through it, a valve seat on its inner side, and a transverse partition in said opening formed with a central opening for the passage of the valve stem, and with perforations around it for the passage of steam.

**No. 50,654. Continuous Brick Kiln. (Four à briques.)**

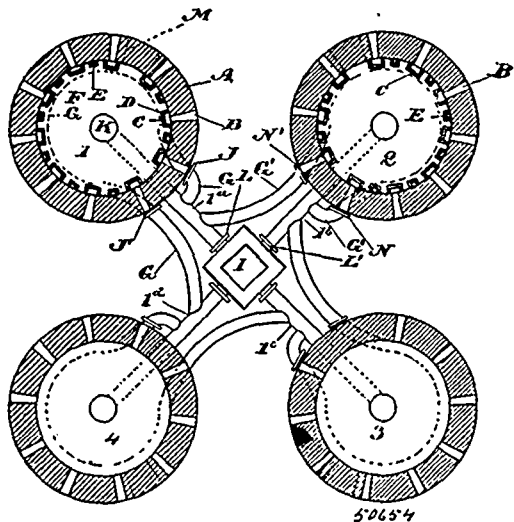

Charles James Lewis, Grimsby, Ontario, Canada, 22nd November, 1895; 6 years.

**Claim.**—1st. A continuous brick kiln consisting of a series of independent kilns, each kiln consisting of an outer wall, a series of vertical fire chambers arranged around the inner side of the outer wall having their upper ends opening into the body of the kiln, the chimney, a main flue from the kiln to the chimney, a draft well centrally through the floor of the kiln to the main flue, substantially as specified. 2nd. A continuous brick kiln consisting of a series of independent kilns, each kiln consisting of an outer wall, a series of vertical fire chambers arranged around the inner side of the outer wall having their upper ends opening into the body of the kiln, the chimney, a main flue from the kiln to the chimney, a draft well centrally through the floor of the kiln to the main flue, and a damper for the main flue, substantially as specified. 3rd. A brick kiln consisting of an outer wall, a series of vertical fire chambers on the inner side of the outer wall the upper end of each of the vertical fire chambers opening into the body of the kiln, a series of vertical hot air flues arranged around the inner side of the outer wall and extending through the floor of the kiln, a flue connecting together the lower ends of each of the hot air flues, and means for conveying the

heated air and gases from the connecting flue to the chimney, substantially as specified. 4th. A brick kiln consisting of an outer wall, a series of vertical fire chambers on the inner side of the outer wall, the upper end of each of the vertical fire chambers opening into the body of the kiln, a series of vertical hot air flues arranged around the inner side of the outer wall and extending through the floor of the kiln, a flue connecting together the lower ends of each of the hot air flues to the chimney, and a damper for each of the hot air flues, means for conveying the heated air and gases from the hot air flues, substantially as specified. 5th. A brick kiln consisting of an outer wall, a series of vertical fire chambers on the inner side of the outer wall, the upper end of each of the vertical fire chambers opening into the body of the kiln, a series of vertical hot air flues arranged around the inner side of the outer wall and extending through the floor of the kiln, a flue connecting together the lower ends of each of the hot air flues, a main flue to the chimney into which the connecting flue discharges, and a draft well formed centrally through the floor of the kiln, into the main flue, substantially as specified. 6th. A brick kiln consisting of an outer wall, a series of vertical fire chambers on the inner side of the outer wall, the upper end of each of the vertical fire chambers opening into the body of the kiln, a series of vertical hot air flues arranged around the inner side of the outer wall and extending through the floor of the kiln, a flue connecting together the lower ends of each of the hot air flues, and means for conveying the heated air and gases from the connecting flue to the chimney, and means for conveying the gases from the connecting flue to the next adjacent kiln of the series, substantially as specified. 7th. A brick kiln consisting of an outer wall, a series of vertical fire chambers on the inner side of the outer wall, the upper end of each of the vertical fire chambers opening into the body of the kiln, a series of vertical hot air flues arranged around the inner side of the outer wall and extending through the floor of the kiln, a flue connecting together the lower ends of each of the hot air flues, means for conveying the heated air and gases from the connecting flue to the chimney, a damper for each of the hot air flues, and means for conveying the gases from the connecting flue to the next adjacent kiln of the series, substantially as specified. 8th. A brick kiln consisting of an outer wall, a series of vertical fire chambers on the inner side of the outer wall, the upper end of each of the vertical fire chambers opening into the body of the kiln, a series of vertical hot air flues arranged around the inner side of the outer wall and extending through the floor of the kiln, a flue connecting together the lower ends of each of the hot air flues, a main flue to the chimney into which the connecting flue discharges, a draft well formed centrally through the floor of the kiln into the main flue, and means for conveying the gases from the connecting flue to the next adjacent kiln of the series, substantially as specified. 9th. A brick kiln consisting of an outer wall, a series of vertical fire chambers on the inner side of the outer wall, the upper end of each of the vertical fire chambers opening into the body of the kiln, a series of vertical hot air flues arranged around the inner side of the outer wall and extending through the floor of the kiln, a flue connecting together the lower ends of each of the hot air flues, a main flue to the chimney into which the connecting flue discharges, a draft well formed centrally through the floor of the kiln into the main flue, and dampers for the main flue and connecting flue, substantially as specified.

**No. 50,655. Apartment House. (Maison-appartement.)**

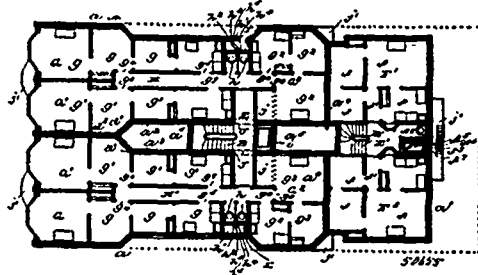

Martin Louis Ungrich, New York, State of New York, U.S.A., 22nd November, 1895; 6 years.

**Claim.**—An apartment house, comprising shops *h*, *h*<sup>1</sup>, central hallway *D*, having a rear side extension *C*, and transverse hallways *E*, *E*<sup>1</sup>, two courts *a*<sup>2</sup>, stairways *B*, following said courts, apartments *F* *F*<sup>1</sup>, at rear apartments *G*, *G*<sup>1</sup>, *G*<sup>2</sup>, at front and sides, hallways *H*, *H*<sup>1</sup>, elevator wells *h*<sup>1</sup>, *f*<sup>2</sup>, at rear and sides and water closets *h*, *f*<sup>2</sup>, at said wells, the whole arranged as set forth.

**No. 50,656. Linen Polisher. (Machine à polir le linge)**

Samuel M. Douglas, Ingersoll, Ontario, Canada, 22nd November, 1895; 6 years.

**Claim.**—1st. The combination of the iron *C*, with the lever *P*, and the bearing *O*, substantially as and for the purpose set forth. 2nd. The combination of the iron *C*, the handle *F*, the lever *P*, and the