

# LAKEVIEW

## The Choicest Residential Section of Greater Regina

The best investment today. More Regina people are buying Lakeview lots now than any other property. Over 300 lots have been sold in Lakeview during the past two weeks.

"Think of the location of Lakeview." Adjoining the new Parliament Buildings overlooking Wascana Lake and Park. In the southwest part of the city, the only direction in which the city can grow.

## Good Reasons Why You Should Buy Lakeview Lots

1. Because street cars are sure to serve this property as soon as the Parliament Buildings are finished.
2. Because several of the shrewdest business men of Regina have purchased lots in Lakeview during the past month.
3. Because you cannot fail to make a profit by next spring.
4. Because a portion of Lakeview has city water and sewer already.
5. Because Regina will have a population of one hundred thousand in a few years.
6. Because Regina will have more railroad development in 1911 than any other city west of the Great Lakes.
7. Because you will never be able to buy Lakeview lots at present prices by next spring.
8. Because our prices are low and terms easy.

THE CUT BELOW SHOWS LAKEVIEW AND THE NEW PARLIAMENT BUILDINGS, ETC.

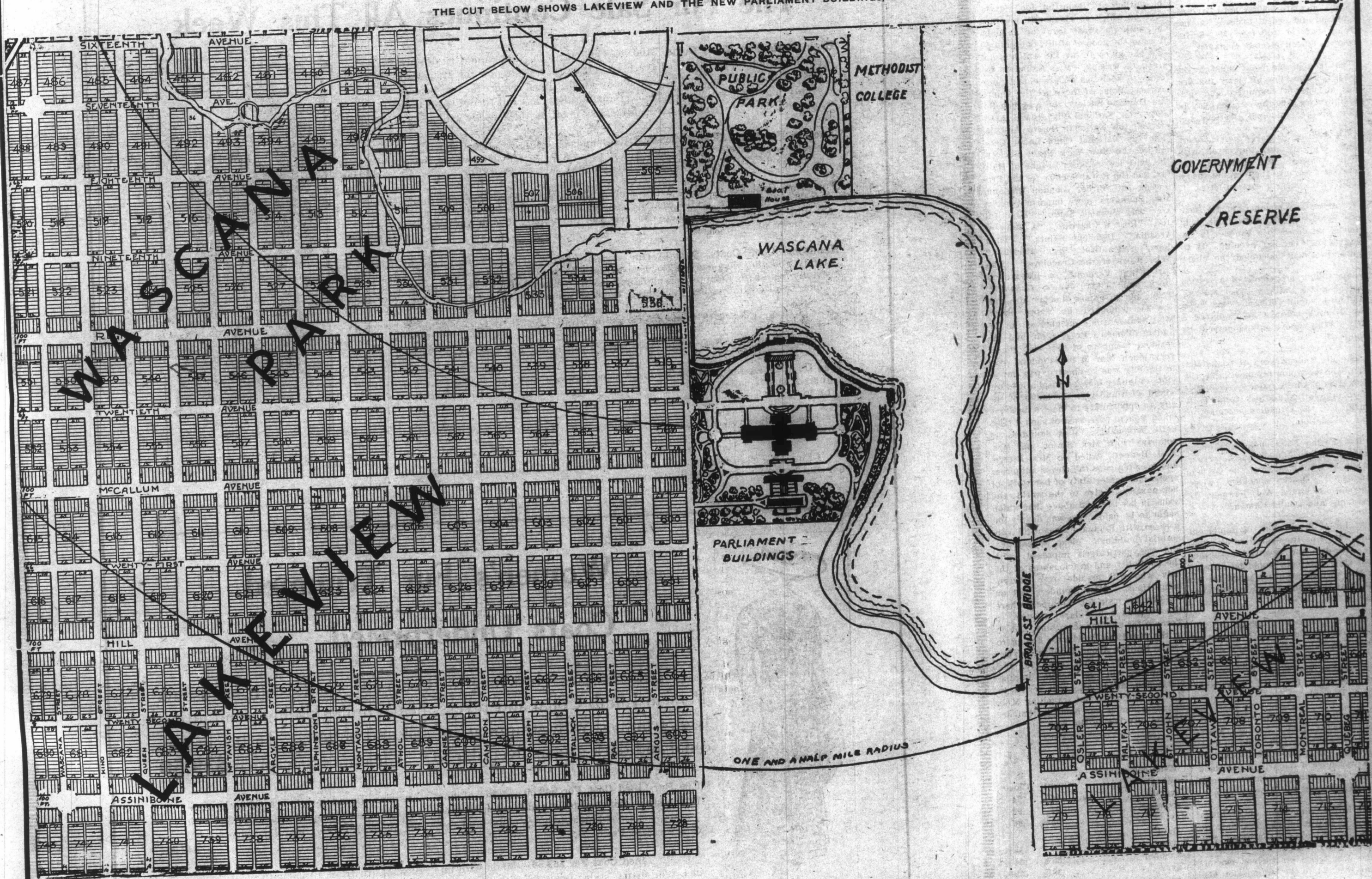

### LAKEVIEW BUY NOW

### LAKEVIEW BUY NOW

Call, Phone, or Write for Maps and Prices

# McCALLUM, HILL & CO.,

Phone 145  
1770 Scarth St., Regina

Office Open in Evenings from 7 to 9 p.m.

Owners

Office: 1770 Scarth St., Regina Phone 145

ember 16, 1910.

r of the old re-

Mr. Powell and  
r O'Reilly were  
eps to ascertain  
est site for the  
obtained. Two  
ntlemen replied,  
urchase of two  
district—now a  
untry—but the  
ent-General re-  
urchase until a  
reserve was as-  
Macdonald, who  
oncurred in this.  
ndence in respect  
ngement was con-

Meanwhile Mr.  
g for the Esqui-  
Railway Company  
he C.P.R.) offered  
ve. He was auth-  
the Indians for  
led to gain their  
would be tedious  
tedious attempts  
e years. The re-  
ghees became a  
nherited from gen-  
on. Visits were  
ttawa made visits  
ons were won and  
settlement issue,  
sives made propo-  
suitable, and those  
her side made pro-  
Indians would not  
of names of those  
es to the task of  
question would look  
e voters' list. At  
emed so near as to  
d, but invariably  
o wrong at the last  
t problems seemed  
fier more than fifty  
cess has been ach-

st gratifying points  
of the long-standing  
t that the Songhees  
rely satisfied. They  
ade fair" long since,  
ow that they needed  
consideration. At  
g but praise of the  
t about the settle-  
d from the Indians,  
arrangements as a  
ho-yoy kimanox  
nghees."

able Stipend  
10.—An example of  
ry and treatment the  
receive in this pro-  
n today when Miss  
t. Francois de Salles,  
cover \$97.00 from the  
ioners. The young  
ed three years ago at  
0 per annum, out of  
to pay \$120 for an  
left her \$10.85 a  
those three years she  
of the school, scrub-  
the fire and supplied  
or it. It is in com-  
ese services that she  
or \$32.33 a year. The  
ren registered in the  
las Monette taught is  
an average attend-  
gment was reserved.

Annexing Maine.  
P.E.I. Nov. 11.—The  
of the State of Maine  
advocated by the Char-  
Guardian, which says:  
that the statement of  
erious consid-ration to  
to use no stronger  
ing the adjoining state  
he Dominion.  
the map is sufficient to  
State of Maine belongs  
to Canada rather than  
states, but being now a  
is to some extent al-  
to the right develop-  
eat transportation sys-  
the same time the state

ENTIS  
PLY SECURED  
Business of Manufacturers,  
era who realize the advisabil-  
Patent business transacted  
inary advice free. Charges  
entor's Advice sent upon re-  
ation, Reg'd., New York Life  
ed Washington, D.C. U.S.A.

nos

ROFIT

ET