

# Will You Help? To Get Every Canadian Farmer

TO READ A GOOD FARM JOURNAL? IF THE FARMING INDUSTRY IS TO RECEIVE ITS PROPER SHARE IN THIS PERIOD OF RE-ADJUSTMENT AND EXPANSION

## EVERY FARMER

Must be fully informed; and able to act with others, in securing new markets, and expanding and stabilizing those we now have, as well as constantly improving live stock, and general farming methods, so as to be able to hold our markets against all competition.

## THE FARMER'S ADVOCATE AND HOME MAGAZINE

Should be in every farm home in Canada. It covers every department of farming, it has always been owned and edited by practical farmers, and no expense is spared securing and publishing information of value to its readers at the time it is most needed.

Public questions are discussed editorially, and each week while the "House" is in session at Ottawa, "The Farmer's Advocate" gives a plain report of all that has been done by the House. The paper being absolutely non-political, this report is merely a record, intended to keep readers of the "Farmer's Advocate" fully informed of what has been done, and is, of course, absolutely non-partisan.

## SUBSCRIBERS

Will you make an effort to help one of your neighbors now by telling him about the "Farmer's Advocate," and by sending in his subscription of \$1.50 to the paper.

For the name of each New Subscriber with \$1.50 that you send us we will advance the date to which your own subscription is paid FOUR MONTHS FREE OF ANY CHARGE.

For the names of Three New Subscribers with \$4.50 we will advance the date to which your subscription is paid ONE YEAR FREE OF CHARGE.

### Coupon

THE WILLIAM WELD CO. LTD.  
LONDON, ONTARIO.

GENTLEMEN:— Enclosed is ..... for \$..... to cover the following new subscriptions to the  
Money Order or Postal Note  
Farmer's Advocate and Home Magazine for one year. Kindly advance the date on my label ..... months in accordance with  
your advertisement.

Name of Sender..... Address.....  
Name of New Subscriber..... Address.....  
Name of New Subscriber..... Address.....  
Name of New Subscriber..... Address.....

ent.

purposes the chief  
ety of production,  
e practical work re-  
teacher would do  
t plants which are  
be assigned to Form  
ls. Form IV should  
t out such exercises  
lings, and successive  
a later crop between  
p, etc., so that when  
ren up for use, the  
e along for fall use  
The idea of thrift  
ated.

should emphasize  
antity. The Cana-  
rmer has a strong  
e size and extent  
n, and has yet to  
lesson of intensive  
reason why a small  
will score a higher

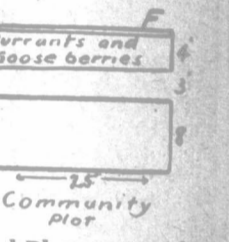

Community Plot

al Plots are 8x5 ft.

han one twice the  
weeds or producing  
den truck.

lot can be used to  
of interest in which  
are of the teacher  
from a point of view  
re. All the pupils,  
m IV should keep  
mental investigations  
problems may be  
p rotation, value  
ertilizers, ways of  
plants, testing out  
potatoes, carrots,  
ilflower, parsnips,  
s, barley, or the  
eds from biennials,  
of weeds and such  
wth by mulching,  
ay be necessary to  
omic results should  
h the school garden  
lot.

al border should be  
of the garden and  
source of pleasure  
eacher. The plans

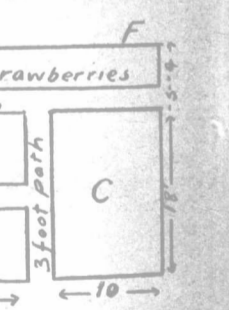

Represents a

ng the fence with  
but the size may  
he conditions and  
en. Certainly the  
this border. Why  
a beauty spot even  
en the edge along  
a sweeping curved  
add much to the  
ppearance, accord-  
at curved lines are  
raight outlines and

though simple if  
nterested teacher,  
ng the pupils realize  
ciples underlying  
render them cap-  
investigating for  
practical study of  
stly in the pupils'  
nd will immeasur-  
leasure in school  
ing the case fewer  
brought up on the  
o leave it.