

...THE... LAST CHANCE

TO BUY A LOT IN THIS SECTION

We are offering a limited number of 25 FOOT LOTS on YARMOUTH GARDENS and PALMERSTON GARDENS at the low price of \$47.00 per foot, this price being FOR QUICK SALE ONLY.

THE EXCELLENT POSITION of this section is shown on the small map in the corner.

Full particulars may be obtained by applying to

JAMES HEWLETT, 79 Victoria St.

PHONE MAIN 168

Or to **JONES & LEONARD, 18 Toronto St.** PHONE MAIN 3511

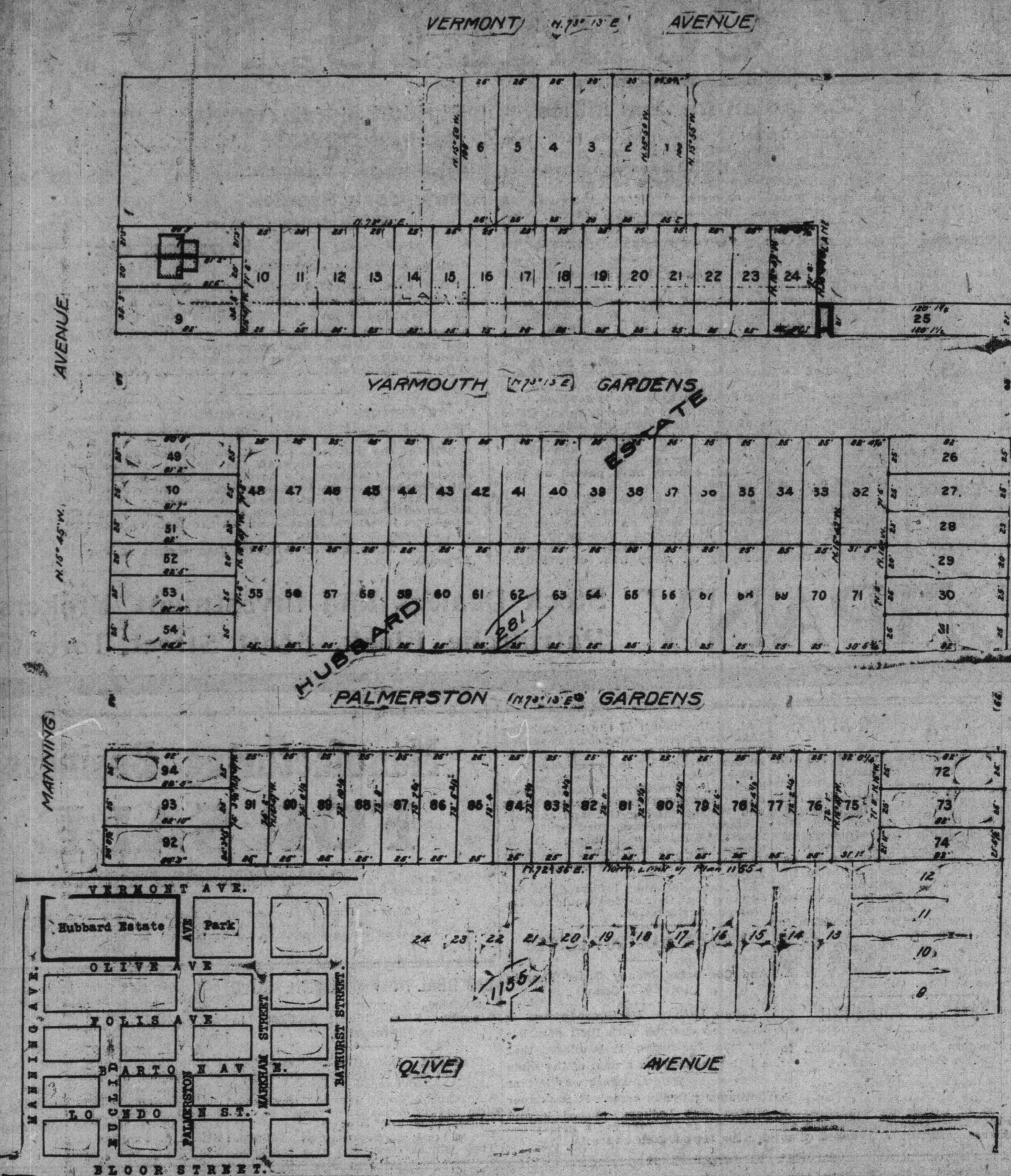

WAREHOUSE TO RENT

Cor. George and King Sts.

Basement and Four Floors suitable for light manufactory.

The Toronto General Trusts Corporation

...TO LET...
OFFICES,
WAREHOUSE,
FLATS.

JOHN FISKEN & CO.
23 SCOTT ST. 461357

HORSES AND CARRIAGES.

SEVEN HORSES AND MARES, including Lexington, fast road or family horse, prize winner, bred by Kewwick (mark 200), his road wagon and two-minute road harness to match; outfit cost \$800 this season, will for less than half value; taken for debt, must sell. 1588 West King Street.

TWO MARES FOR SALE—BOTH

tired to heavy horse. Apply 1187 Queen Street East.

FOR SALE—AN EXCEPTIONALLY high-class Shetland pony, with his handsome rubber-tired buggy, up-to-date cutter, robes, and every stable requisite; also full riding outfit. This outfit cost over three hundred; everything good as when first purchased; selling for no fault, but leaving for England on Tuesday next; will sacrifice lot for \$150, including pony, which is fully guaranteed every way. Apply to groom, rear 14 Hallowell Street.

PROPERTIES FOR SALE.

The McArthur-Smith Co's List.

THE McARTHUR-SMITH CO. OFFER:

\$4000 WILL PURCHASE TEN

acres, 3 miles from Toronto, with

brick dwelling, 8 rooms; barn, stables and

drive house, good orchard.

\$3600 WILL PURCHASE EIGHT-

een acres garden lands, 3 miles

north of city limit.

\$1000 SECURES 4 ACRES WITHIN

thirty minutes of Toronto.

SEVERAL 5 AND 6 ROOMED HOUSES,

central, to exchange for larger.

LOT (NORTH TORONTO) AND FIVE

hundred cash for house in Deer Park

vicinity.

THE McARTHUR-SMITH COMPANY,

44 Yonge.

FOUND.

STRAYED—TO S. STEWART CON. 2

Lot 11, West York, one two-year-old

toan steer.

BUSINESS CHANCES.

W. Parsons' List.

W. PARSONS, 18 TORONTO STREET.

Real Estate, Mining and Business

Chance Broker. Established twenty-five

years. Correspondence and business con-

nections in nearly every town and city in

Canada and border States. No deposit

asked. No charge unless I do business. I

make a specialty of selling mining prop-

erties, oil stock. W. Parsons.

GOWANDA—TWO FORTY ACRE

claims, two years' assessment

work completed. Obusung Lake;

splendid showing; surrounded by and ad-

joining working mines; five thousand;

easy terms. W. Parsons.

MINING CLAIM—THREE IN THE

Muskrat Reserve, assay 338 ounces

silver practically from surface; near rail-

road; title guaranteed; fifteen thousand;

two thousand cash. W. Parsons.

GROCERY, CONFECTIONERY, ICE

cream and candy business in large

northeastern town; stock about twelve

hundred; horses, rigs, scales, fixtures,

about five hundred; rent, with dwelling,

twenty-five; turnover, ten thousand year-

ly. W. Parsons.

WHOLESALE JOBBERS' STOCK STATION-

ery, fancy goods, leather goods,

sporting goods, jewelry, worth four thou-

sand dollars; must sell; would take five

hundred; easy terms. W. Parsons.

BILLIARD, POOL, TOBACCO AND

cigar business in Edmonton, Alberta,

centred receipts, billiard room, twelve

hundred monthly, expenses two hundred

and twelve dollars; price, five thousand

five hundred; easy terms. W. Parsons.

HOTEL—CHANCE OF LIFETIME—

Forty-five rooms, sample room, forty

bedrooms, seven sample; phone in every

room; receipts thirty dollars; low rent,

good lease, option defeated; thirty-five

hundred; two thousand cash. W. Par-

sons.

HOTEL—LARGE TOWN, MUSKOKA—

Forty-five rooms, sample room, forty

bedrooms, seven sample; phone in every

room; receipts thirty dollars; low rent,

FARMS FOR SALE.

W. A. Lawson's List.

YOU WANT A FEW ACRES, WITH

buildings, near this city? Then ask

for our list of small properties. A post-

card will bring it.

56 ACRES—JOINING THE TOWN OF

Brighton; a lovely situation, over-

looking the lake; valuable grove of pine

and maple, eight acres drift orchard;

excellent water; eleven-roomed

brick house, lawn, ornamental trees;

bank barn, on stone wall; other build-

ings; all first-class; land in choice black loam;

nothing better either as a farm or gen-

tleman's residence; seven thousand.

87 ACRES—ONE MILE FROM ELEC-

tric city and good village; sandy soil;

three acres orchard, seventy cultivated, fifteen

hardwood; nine-roomed frame house;

bank barn on stone wall; stables for

thirty head; other buildings, in excellent

repair; no better farm to be had for the

money; sixty-five hundred.

100 ACRES—TWO AND HALF MILES

from Beeton Village; sandy loam;

forty cropped, thirty-eight pasture, two

hilly, balance level; twenty good timber

land; and hardwood; spring creek;

comfortable house, five rooms; frame

barn, stables for fourteen head; all fairly

good; twenty-five hundred.

100 ACRES—KING TOWNSHIP—

Twenty-eight miles from city; two

niles from station and village; choice

white land; ninety cultivated, two

orchards; spring creek, good fences; com-

fortable house, bank barn, other build-

ings, in good repair; stables for twenty

hundred; five hundred.

100 ACRES—THREE MILES FROM

East Toronto, close to two railway

stations; ninety acres level, ten

hundred eight hardwood, eight

running stream, well, windmill; ten-room

ed brick house, first-class, three large

berns, stables twenty-two head, all in

good order; twelve thousand.

110 ACRES—NEAR BRIGHTON—

Four acres choice apples, seventy

acres cultivated; frame house, five rooms;

FARM FOR SALE.

Philip & Beaton's List.

BY PHILIP & BEATON, WHITEVALE,

Ont.

125 ACRES—MARKHAM TOWNSHIP,

adjoining Markham Village, where

are G.T.R. station, public and high

schools, churches, mills, etc.; 3 miles

from creamery; 16 miles from Toronto;

good clay loam, level, free from stumps

and stones; 6 acres bush, 1 acre young

orchard; splendid house of 8 rooms, bank

barn, etc.; all in excellent repair; good

water supply, creek; \$3750, \$3200 down.

50 ACRES, PICKERING TOWNSHIP,

good clay loam, in good condition;

good frame house, bank barn and all

other necessary buildings, all in good re-

pair; well fenced; good water supply and

orchard; 2 acres hardwood bush; 6 miles

from Pickering, G.T.R. same distance

from Town of Whitby; 26 miles from To-

rontario; postoffice, church and school con-

veniently near; will be within a couple of

miles of C.N.R. station; \$2200, \$200 down.

WE HAVE A NUMBER OF GOOD

farms of different sizes for sale in

York and Ontario Counties, within driv-

ing distance of Toronto; send for descriptive

list.

PHILIP & BEATON, REAL ESTATE

Brokers, Whitevale, Ont.

HOUSES TO LET.

The Toronto General Trusts Corpora-

tion's List.

\$14—MITCHELL AVE., FIVE ROOMS

and water.

\$15—WESTERN AVE., SIX ROOMS

and water.

\$20—LANDOWNE AVE., 8 ROOMS,

all conveniences.

\$22—BATHURST ST., SEVEN ROOMS,

and water.

\$23—ONTARIO ST., NINE ROOMS,

all conveniences.

\$25—PARLIAMENT STREET, STORE

and dwelling, eight rooms.

\$25—DOWLING AVE., NINE ROOMS,

all conveniences.

\$35—GROVE AVE., SEVEN ROOMS

all conveniences, and nicely fur-

SUBURBAN PROPERTIES.

Waddington & Grundy's List.

W. WADDINGTON & GRUNDY, 36 KING

Street East, Main 636. Branch Office,

Eglinton, North 101, offer as follows:

EGGINTON—ABOUT TWO ACRES,

close to Avenue-road extension, and

convenient to street cars. This property

has a ravine frontage of three hundred

feet, with an attractive outlook. A de-

sirable site for suburban home; \$400.

VICTORIA AVENUE, EGLINTON—

About four acres, part or whole;

some large pine trees, fine surroundings,

ravine on two sides, number of fruit trees;

\$200 per acre.

POSIDALE GOLF GROUNDS—ONE

or more acres, overlooking the links,

beautiful bungalow sites, at ten dollars

per foot; or would sell by the acre.

BALMY BEACH—TWO DWELLINGS,

on large lot, close to lake front; rent

about seven hundred per annum; price,

\$400; would consider city house in ex-

change.

Summer Resorts.

LAKE SIMCOE—NEAR JACKSON'S

Point—Five hundred feet; lake front-

age, about three hundred feet deep,

sandy beach; price, \$9 per foot.

LAKE SIMCOE—ROACHE'S POINT—

About five hundred feet, water front-

age, with street in rear; price, \$16 per

foot, or \$400 for the block.

ALSO ABOUT SIX ACRES OPPOSITE

Beach Croft, the property of Mr. F. E.

Beach. This block has a street front-

age of about eleven hundred feet; price,

in block, \$600.

A GOOD FARM NEAR JACKSON'S

Point, with large lake frontage;

brick house, bank barn; suitable for sum-

mer hotel; \$15,000.

LAKEVIEW AVE.—VICTORIA PARK

district—One hundred feet frontage,

with cottage, opposite D. D. Mann pro-

perty; chance for builder; would enter-

tain city house in exchange.

Farms for Sale.

YONGE STREET—108 ACRES.

YONGE STREET—14 ACRES.

YONGE STREET—20 ACRES.

"CLARIN' UP TIME"

We owe much to old Aunt Dinah for these words, the mere men-

tion of which suggests that odds and ends of work and things may be

lurking around requiring attention.

Such a situation confronts us to-day. We have a number of lots

in some of the choice residential subdivisions opened during last sum-

mer and fall.

We want to clean up these "remnants." That the sale may be

rapid we will make the prices low and terms easy. The properties

are offered as bona fide Christmas bargains.

NORTHERN HEIGHTS, BEDFORD PARK

A wide range of lots to choose from. Splendid home prospects, \$6

to \$9 per foot.

Northern Heights Annex, in the same district, \$4 to \$6 per foot.