

Two Energy-Conserving Suggestions

An Inexpensive Dumb Waiter

HOW many trips have to be made to the cellar for each meal? Three young ladies, each familiar with every detail of housekeeping, were asked this question independently. Each stated that it takes at least two trips in the preparation of each meal and two more afterward in putting the things away. That means four times down and up again for each meal or 12 trips per day. Most cellars are at least eight feet deep so that the daily climb is 96 feet and back, or a total for the year of 35,000 feet. In the preparation of meals for one year the housewife must climb to a height of several thousand feet above the top of Mount

with free passage from one to the other.

The greater part of the work done in the kitchen is that associated with the processes of preparing and serving the food and of cleaning up. In performing these various tasks certain distances must be travelled. For in-

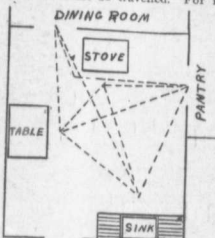

An Inconvenient Kitchen.

stance, it is necessary to go from the pantry to the table, and from the table to the stove or sink very many times. It is evident from this that to shorten the distances travelled, the table, sink and stove should be placed close together, and at the same time in close proximity to the dining-room and pantry. Where there is no dining-room these should be placed together near the pantry in one end of the kitchen, which should be used strictly for the preparation of the food, the other part of the room being reserved for eating.

The figures illustrate how steps, and therefore time and strength, may be wasted by the improper location of the pantry, table, stove and sink with reference to the dining-room. The dotted lines represent the distances travelled in preparing, serv-

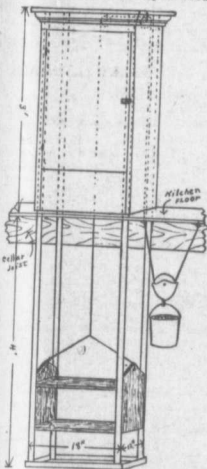

Everest, the highest mountain in the world.

The dumb waiter here illustrated will save most of this climb. The part above the kitchen floor is three feet high and enclosed. Access to the carrier is through the small door. The four corner strips, which serve as guides to the carrier, extend below the floor about four feet, which allows the carrier to come within easy reach of a person in the cellar. The carrier is supported by a rope, which passes through two small pulleys, as shown by the dotted line, and down to a weight which is simply an old pall full of small stones. This weight balances the carrier, which can be easily moved up and down, and will remain stationary at any height at which it is left. The shelves are 12 inches by 18 inches, and may be two or three in number as required.

The total cost of the material for this dumb waiter is about \$2.50, and anyone handy with tools can install it in a few hours. In one year it will save the busy housewife from climbing over six miles of stairs.

Saving Steps in the Kitchen

IN planning or re-modelling the kitchen, the table, cupboard stove and sink should be so located that the tasks in the kitchen may be performed most conveniently and with the least expenditure of time and energy, which means they must be near together, but must not interfere

ing, and cleaning up after a meal, and indicate how steps may be saved by bringing the table, stove, and sink together in one corner of the room near the pantry and dining-room.—Selected.

The Awakening of Josh Rutherford

(Continued from page 7)

he'd bring me the price of all my sales, and if there was no trip to market, he'd just put down what he thought was the right sum, sheepishly, on my side, and I always understood and was happy.

Josh has been dead for five long years. If he had only known one money matter, what I planned we would have had, for Josh loved me. And, well, did I love Josh? I just guess I did, money or no money.

Cut the corn not too green and cut into the silo very fine.

Protect Your Ensilage with a GOOD SILO ROOF

BIG OPENING FOR FILLING

PLENTY OF LIGHT AND VENTILATION

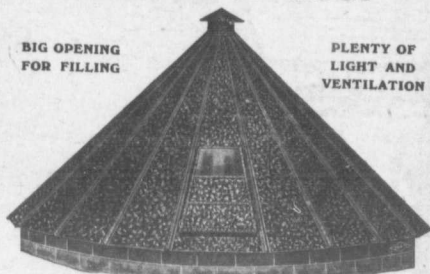

HERE IS A ROOF WE CAN RECOMMEND—

The "EMPIRE" Silo Roof

Weather-tight, Fire-proof, Strong and Neat. Simple, Efficient and Moderate Priced. Big Opening for Filling. Lots of Light and Ventilation. Perfect in every respect.

PRICES AND FULL INFORMATION ON REQUEST

The Metallic Roofing Co. of Canada

Manufacturers of "Quality First" Sheet Metal Roofing, Siding, Ceiling, etc. LIMITED
Cor. King and Dufferin Streets - TORONTO

A FEELING OF SECURITY

Of absolute Reliability and Power is Enjoyed by Every Owner of a

GILSON ENGINE

"GOES LIKE SIXTY"

A mechanical masterpiece of the highest type, with our improved simple methods of cooling, governing and sparking. Positively guaranteed, biggest value in any part of house, barn or field possible.



GILSON MANUFACTURING COMPANY
7 York Street, Guelph, Canada 33 10

"Water, Water, Everywhere," And Comfort for You and Your Wife

In the stables, in the house, in the garden; clean, pure, fresh water at all times, summer or winter. No more heavy lifting and pumping for yourself or your wife. No more unsightly attic tanks. Water any place on the farm—without work—without trouble—with little expense.

PEERLESS WATER SYSTEMS

save time, labor, doctors' bills, and inconvenience: they bring city comforts to the farm, make bath rooms, lavatories and running water in any part of house, barn or field possible.

Compact, strong, simple, require little attention and cost almost nothing to operate.

Water is pumped from source of supply to tank located in cellar, outdoors or underground. Then held under air pressure which provides and forces it to wherever you run the pipes in house, barn or garden. There's no cost of operation beyond the filling of the tank, and when desired the engine used for this purpose can be used for driving cutting box, churn, separator or other machines on the farm.



You would be interested in our circular about Peerless Water Systems.

NATIONAL EQUIPMENT CO. LTD.
7 Wabash Ave., TORONTO.

Sole Manufacturers of Peerless Water Systems.