

Grand Opening---WOODMOUNT PARK



Absolutely the most attractive subdivision north of Danforth Avenue offered the workingman or small investor. It's three minutes' walk from a coming car line.

Woodmount Park is just what its name implies—beautifully wooded with royal oaks—situated on a high level plateau overlooking the city.

\$21 a foot. Easy terms.

Note the attractive size, 25x140, just the right dimension for a pretty home built under reasonable restrictions.

Woodmount Park is on the south side of Salmon Avenue, west of Woodbine Avenue.

Our motors will be waiting for you at Kingston Road and Queen Street any time this afternoon.

SEE THIS. It's the best chance this year for the man with a little money.

Owners: **W. N. McEACHREN & SONS, Ltd.**
63 Victoria Street TORONTO Adelaide 42

TWO PROPERTIES SOLD UP YONGE

Thirty Feet North of Firehall Brings \$3000 a Foot Small Carlton Parcel Sold.

The little lot of 35 feet frontage, by a depth of 14 feet, facing on Carlton street, on the south side, and in the rear of the Bank of Montreal at Yonge and Carlton streets, has been sold to Mr. Sheppard of Burns & Sheppard at a price of \$1000 per foot. There is a small frame house on the lot. The 30 foot frontage on Yonge street, immediately north of the fire hall, by 125-foot depth to a line, has been sold at \$200 per foot. The name of the purchaser is not yet given out. Other transactions about Carlton street are under way.

King St. Firm Will Move to Upper Yonge

Elliott & Son, decorators, have decided to erect a four storey building on property they recently purchased on Yonge-st., south of Dundas-st. They have 45 feet of vacant frontage next to the corner lot. They will move out of their leased premises at 75 West King-st. as soon as possible. The move is made necessary because of outgrown capacity, and because their situation, now part of a financial district, is losing value for retailing and commercial purposes.

By coating eggs with unsalted lard and storing them in a cool, airy place they may be kept fresh for a year, according to an Italian authority. Two heavy flywheels to make the motor steady running have been fitted to an automobile used in London for carrying electric lamps and other fragile articles. For the convenience of persons who have small amounts of washing to do at home there has been invented a pull with a washboard sliding in grooves in one side.

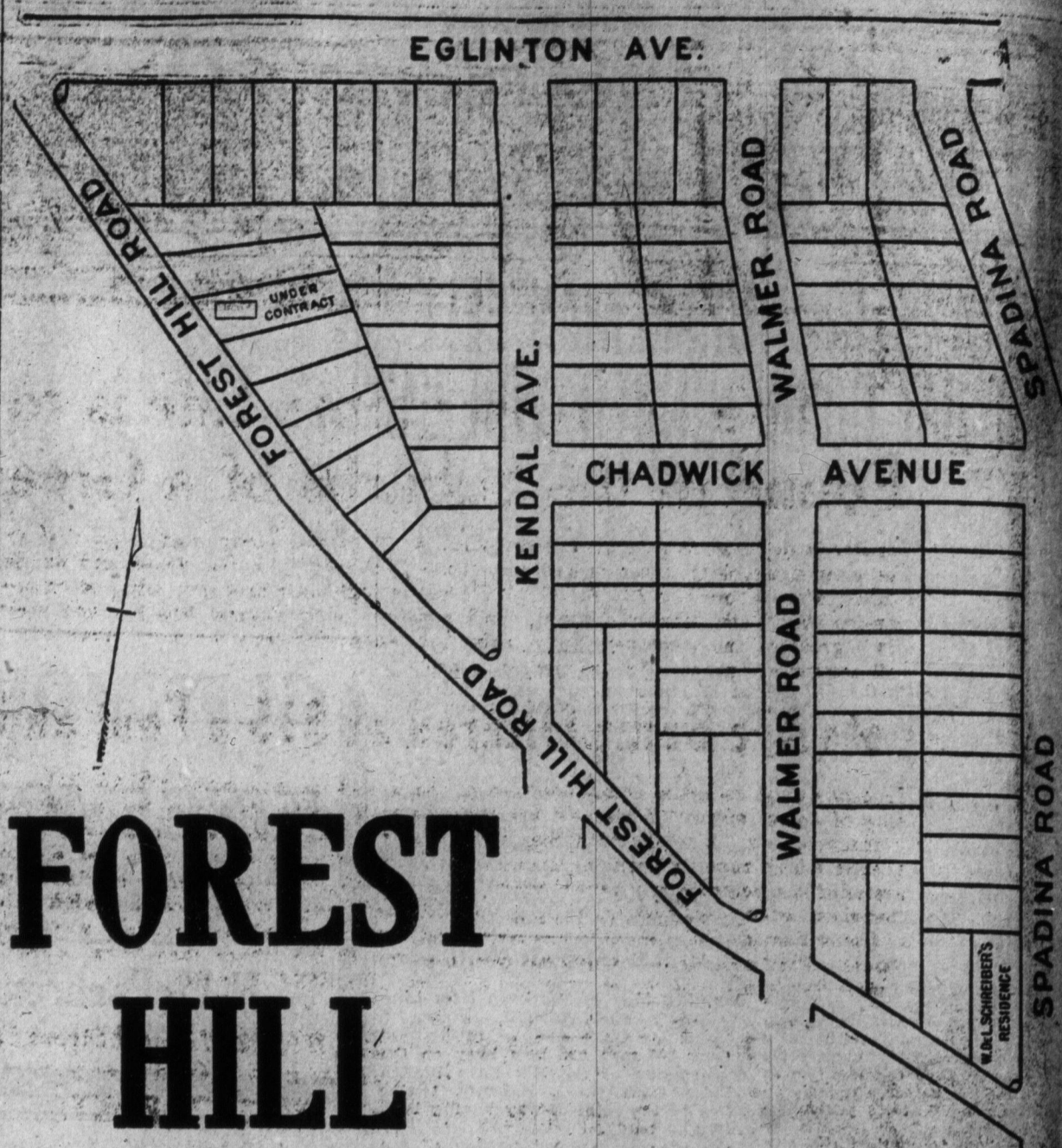

FOREST HILL

Choicest and best lots in this high-class district \$25.00 foot upwards.

COLONIAL REALTY & SECURITIES CORPORATION
LUMSDEN BUILDING LIMITED
CHADWICK & ROGERS, Exclusive Agents.

Invest 60 Minutes TO-DAY IN LOWTHER PARK ESTATES

A SPLENDID PROPERTY NEAR DANFORTH AND WOODBINE



YOU can afford to invest 60 minutes in learning how to profitably invest 60 dollars or more in Lowther Park lots. Do This To-day

THE Danforth civic car line is projected to serve this property this year. This is but the forerunner of the extension of Bloor Street East along Danforth, and the beginning of phenomenal development in the east. There is every reason to believe that Lowther Park lots along Danforth will become as extremely valuable as Bloor Street West lots now selling from \$250 to \$350 per foot.

LOWTHER

NOW is the time to buy for homeseite or investment. Present prices are the lowest in this splendid Danforth section; but how soon the advance will come is difficult to say. Buy now and the advance in prices cannot come too quickly for you. Come Out This Afternoon.

VISIT Lowther Park this afternoon. Our motor cars will be waiting for you at the eastern office, Greenwood and Gerrard, end of Parliament car line, from 1 to 5 p.m. to-day. Don't miss this trip.

ROBINS LIMITED
22 Adelaide East. Phone Main 7171
Eastern Office, Greenwood and Gerrard. Phone Beach 677

WELLAND WELLAND

REAL ESTATE

IN A FAST GROWING TOWN IS THE Best Investment on Earth

THE FASTEST GROWING TOWN IN CANADA TO-DAY IS

WELLAND

WELLAND has 25 manufacturing plants. WELLAND has 7 railroads. WELLAND has the Welland Canal. WELLAND has natural gas at 30 cents per M. WELLAND has electric power at \$12.00 per H.P. WELLAND needs 500 homes built. WELLAND needs 1,000 men.

We own and offer, as the best speculative investment in Canada, a few choice lots in WELLAND SOUTH, the only restricted sub-division, adjoining the manufacturing district of Welland, at from \$5.00 per foot up.

For full particulars send

Name

Address

—TO—

Canadian General Securities Corporation, Limited
39 Scott Street, - TORONTO

WELLAND WELLAND

ALEXANDRA GARDEN VACANT LAND SNAPS

We make a specialty of building in the most desirable restricted district and have exclusive selling in the best sections of the GARDEN.

FORBES & LOVE
2 Court Street
Main 586
Night Phones: June, 1540; Park, 4872

SCARLETT ROAD SUBDIVISION
DUNDAS CARS RUN TO PROPERTY YOU NEED NO MOTOR SANDY SOIL, NO MUD, LOW PRICES —Term \$5 Monthly—

Humber Land Co., Limited
38 Queen East - - - Phone M. 710

Yonge St. Properties
BETWEEN CARLTON AND BLOOR STREETS

We have some first-class investments to offer in this section of Yonge Street.

Gibson Bros.
REAL ESTATE BROKERS
7 Toronto Street.

FOR SALE
4 Acres and large Brick House, 12 rooms; fruit trees, large barns, thirty miles from Toronto.

\$2000.00
Goulding & Hamilton
106 Victoria Street

FARMS AND BUSINESS PROPERTIES
Our Specialty
J. M. WILSON & CO.
Real Estate Agents
14 KING STREET EAST
Phone M. 4461-2. ad112

UNION TRUST CO., LIMITED
FARMS FOR SALE

Our farm lists are at present very complete, and we have almost anything a purchaser would desire, both large and small, in all the best districts in Halton, Peel, York, Ontario and Durham Counties, and we are always prepared to assist intending purchasers in making selections, with a view of making a home, or as an investment in farm land. We have a practical farmer at the head of this department, who is always prepared to accompany purchasers who desire to make inspections and give his opinion of values.

We always prefer to see clients at our office, but if that be inconvenient, write us stating the kind of farm, locality and how much money you desire to put into a property, and we will endeavor to meet your views and procure you the best value.

To those having good farms and wishing to sell, suitable either for grain or stock raising, fruit-growing or gardening, call and let them with the

UNION TRUST CO., LIMITED - TEMPLE BUILDING
176 BAY STREET.

Crescent Roofing Co.
Slate, Tile and Gravel Roofs. Repairs. Insulation. Estimates. Estimates on all kinds of roofing.
W. H. ADAMS, Manager.
Phone Junor. 904. 257 55 Stanley St.

SECURITIES, LIMITED
202 KENT BLDG. Main 671.
Will buy, sell and exchange business properties, city lots and farm lands.

REDMOND & BEGGS
Architects and Structural Engineers
(Late of City Architect's Dept.)
ROOMS 311-312 KENT BUILDING, TORONTO
Phone A. 176.

ME W
We R
the T
for se
chanic
men. I
to see
tion
where
drop
your
tion an
carrin
Can
Securi
39
TOR
PROPE
S. W.
W. BLAC
\$5000—DE
foundation
order, also
dals. Splendid
\$6200—HO
combination
Bloor street.
\$6500—RO
turbid water
frontage, also
street. Black
\$7000—W
all large, but
good rooming
smaller house
\$7250—QU
built 2-room
modern imp
room for side
city, and in
W. & Co., 25 Tor
\$2500—SIL
6-roomed dwell
ing; good
Well rented,
& Co.
\$40—IVY A
the city. Blac
\$125—ST. C
& Co.
\$500 PER
the good purchas
N. W. BLAC
Moving Pl
ge
Regular mov
ach of human
process of dig
exhibited in
what it will
pictures will
students as a
teaching.
Experiments
according to
admit a little
harmless pow
lines; the cont
visible to the
ing X-ray ph
step. It beca
ing picture
the stomach
Meal.
The old ide
vided practice
ing used as
other doing
proved by th
which work
Soon after th
beings to dis
forth. This ch
form of regul