

SACKETT PLASTER BOARD

INSTEAD OF LATH



Christian Bros.' School, Longueuil, P.Q., recently completed. 18,000 square yards of SACKETT PLASTER BOARD were used in this building.

Architects in Canada are rapidly realizing the unequalled advantages of SACKETT PLASTER BOARD over both wood and metal lath, for various reasons:—

First—Walls and ceilings of SACKETT PLASTER BOARDS will be dry and ready in half the time required when lath is used, as less than half the quantity of water is needed.

The superior insulating qualities of SACKETT PLASTER BOARD makes a house warmer in winter and cooler in summer.

The first cost is no more than for good work on wood lath, and less than on metal lath. SACKETT PLASTER BOARD is an efficient and economical fireproofing.

Among the recent buildings in which SACKETT PLASTER BOARD has been used, might be mentioned the Christian Bros.' School, Longueuil, P.Q., in which 18,000 square yards of SACKETT PLASTER BOARD were applied, and the Orphanage Building at Kingston, Ont., H. P. Smith, Architect, and Wm. McCartney, Contractor, in which 10,000 square yards of SACKETT PLASTER BOARD were used.

SACKETT PLASTER BOARD comes in sheets or slabs, 32 by 36 inches, ready to be nailed to studdings, furring or beams.

For all kinds of buildings, its use is ideal. It speeds construction; it lessens building cost; it reduces fire charges for insurance; it makes fire resisting walls and ceilings, and gives absolute satisfaction.

BOOKLET SHOWING BUILDINGS ALL OVER THE COUNTRY WHERE THESE BOARDS HAVE BEEN SUCCESSFULLY USED, WITH SAMPLES, FURNISHED ON APPLICATION.

FLAWLESS PLASTER

In prepared "FLAWLESS HARD" WALL PLASTER you have the ideal combination of a perfect plaster and a perfect sand. In its manufacture, true silica sand is used, washed, cleaned, screened, and made thoroughly dry. In fact, "FLAWLESS" HARD WALL PLASTER is made under ideal conditions, in a plant especially equipped for cleaning, mixing and testing plaster.

Nothing but water is required on the job, in mixing prepared "FLAWLESS." It requires only one-third the water that lime does. You can dispense with a "mixer man," which saving offsets the slightly extra cost of "FLAWLESS."

Architects who have specified "FLAWLESS" HARD WALL PLASTER will permit nothing else to be used on their work.

One ton of "FLAWLESS" HARD WALL PLASTER, when applied to "STANDARD" SACKETT PLASTER BOARD, will cover 120 square yards, while one ton will only cover 60 yards on wood lath, and 45 yards on metal lath.

For a perfect wall, there is no combination that can compare with SACKETT PLASTER BOARD and "FLAWLESS" HARD WALL PLASTER.

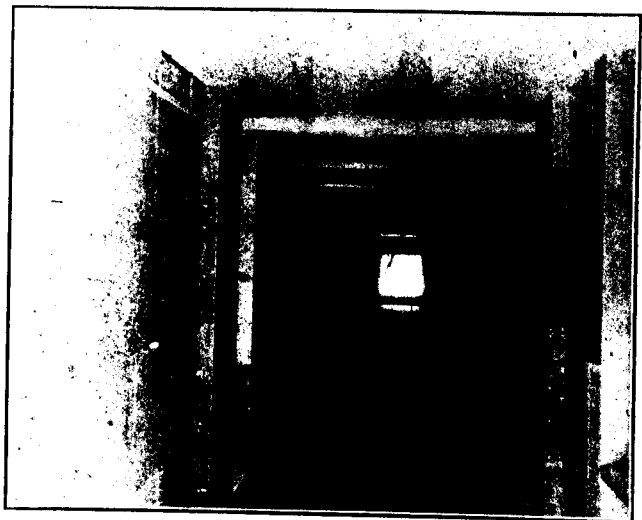

Corridor in Christian Bros.' School, Longueuil, P.Q., showing SACKETT PLASTER BOARD before "FLAWLESS" HARD WALL PLASTER was applied.

Stinson-Reeb Builders' Supply Co., Limited
 9th Floor Eastern Townships Bank Building - - - MONTREAL