

BRUCE'S RECLEANED FARM SEEDS

THE BEST OFFERED IT PAYS TO BUY THE BEST
OUR LONG ESTABLISHED REPUTATION THE BEST GUARANTEE
OF RELIABILITY

Clovers and Timothy must be marked No. 1, No. 2, or No. 3. Number of weeds allowed in No. 1 is so few that it makes it difficult to procure this grade, except in Timothy, consequently price for this grade is high. Our No. 2 grades are excellent value, in some cases very close to No. 1 in purity, but not equal in color. We mark the Government test number on each bag. We solicit your order, which will have the best of care. Our samples of Seed Corn are splendid and of very high germination.

We offer for immediate orders, as the market fluctuates, subject to being unsold, prices here, cash with order, as follows: March 15, 1917.

SEED GRAINS, ETC.		SEED GRAINS, ETC.		SEED GRAINS, ETC.	
Barley, Mandscheuri.	\$1 65	Peas, Golden Vine.	\$3 75	Lucerne, Regal, No. 1 G.S., Amer.	\$13 50
" " No. 21.	1 70	" Canadian Beauty.	4 00	" Choice, No. 2 G.S., Amer.	12 00
Beans, Soja, or Soy.	4 50	" Marrowfats, White or Black.	4 50	" Turkestan, No. 2 G.S.	11 50
Buckwheat, Silverhull.	2 25	" Early Brittany.	3 50	Red, Regal No. 1 G.S.	14 00
Corn, Compton's Early, 12 Rowed.	2 50	Potatoes, Eureka.	2 70	" Choice, No. 2 G.S.	13 50
" Angel of Midnight, 8 Rowed.	2 50	" Early Chicago Market.	2 70	" Prime, No. 3 G.S.	13 00
" White Flint, Dakota, 8 Row.	2 50	" Delaware.	2 70	Mammoth, Choice, No. 2 G.S.	15 00
" Longfellow, 8 Rowed.	2 50	" Noroton Beauty.	2 70	White, Regal.	35 00
" King Philip, 8 Rowed.	2 50	" Sir Walter Raleigh.	2 70	" Choice.	34 00
" Australian, Extra Early.	2 50	" Empire State.	2 70	" Prime.	33 00
" Improved Leaming, Bruce's.	2 20	" The Dooly.	2 70	White and Alsike, Mixed.	13 00
" Butler Dent.	2 20	" Green Mountain.	2 70	Sweet Clover, White Blossom.	12 00
" Cloud's Dent.	2 20	Rye, Spring.	2 70		
" Cuban Giant Yellow.	2 20	Speltz or Emmer, per 40 lbs.	1 35		
" Reid's Dent.	2 20	Tares, Black.	3 75		
" Wisconsin White No. 7.	2 20	Vetch, Hairy.	15 00		
" Leaming.	1 80	Vetch, Hairy, mixed with Rye.	8 50		
" White Cap Dent, Bruce's.	2 20	Wheat, New Marquis.	3 00		
" Selected Giant Red Cob.	1 80				
" Selected Mammoth White.	1 80				
" Evergreen Ensilage, 40 lbs.	3 20				
Cow Peas, Whippoorwill.	4 00				
" New Era Early.	4 00				
Oats, Scotch Black Tartarian.	3 00				
" Canadian Black Tartarian.	1 35				
" Bruce's Leader.	1 75				
" Green Mountain.	1 35				
" Siberian.	1 25				
" Bruce's Conqueror.	1 50				
" Scottish Chief, Bruce's.	1 35				
" Silver Mine, Early.	1 35				
" American Banner.	1 35				
" New O.A.C. No. 72.	1 35				
" Abundance, Regenerated.	1 35				

Remit 25 Cents Each for used, 30c. for New Two-bushel Cotton Bags.
POULTRY SUPPLIES.—Oyster shells, 85c.; Pearl Grit, 75c.; Granulated Bone, \$2.60; Beef Scraps, \$4.00; Blood Meal, \$4.00; Beef Meal, \$4.00; Chick Food, \$3.50; Scratch Food, \$3.10; Developing Food, \$3.25; Pigeon Food, \$3.65; Mash, \$2.70; Alfalfa Meal, \$2.75. All per bag of 100 lbs. Bags free.

The Letters G. S. after Clovers and Timothy stand for Government Standard.
Bitter Lick Salt Brick.—A splendid conditioner for horses. Bricks, 25c. each. Holder for fastening in stall so it cannot be wasted, 20c. each.

Our Beautifully Illustrated Catalogue of Vegetable, Flower and Root Seeds, Bulbs, Plants, Implements and Poultry Supplies—128 pages—mailed FREE to all applicants. Write for it at once.

JOHN A. BRUCE & CO., Ltd., Seed Merchants, Established 1850 **Hamilton, Ont.**

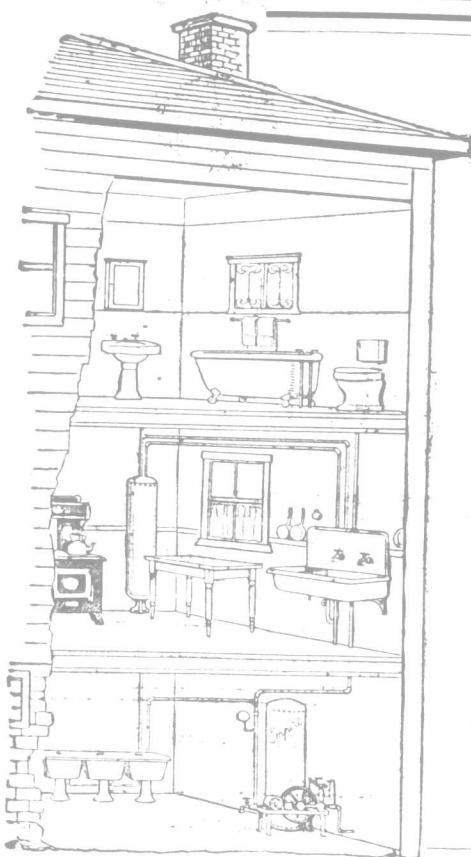

Have Your Own Water System

Have running, hard, soft and hot water on every floor of your home—in the basement for laundry purposes, in the kitchen, in the bathroom. Then a tap outside for watering the lawn or flowers, and another

for the stock in the yard, also water in the barn, poultry house, garage.

The water supply is constant, and always under good pressure when you use an

Empire WATER SUPPLY System

Empire Water Supply Systems are simple in design, compact, powerful. There is an Empire system suited to the needs of every home, and priced so reasonably that no home need go without it.

Send to-day for our Free Catalogue and Information Blank.

Fill in the latter, mail it to us and we will select a system suited to the needs of your particular place, and estimate its cost without charge or obligation.

EMPIRE MANUFACTURING CO., LIMITED
EAST LONDON, CANADA. Branch Office: 119 Adelaide St. W., Toronto

EARN \$10.00 A WEEK AT HOME
The Hosiery trade is booming. Help to meet the huge demand. Industrious persons provided with profitable all-year-round employment on Auto-Knitters. Experience and distance immaterial.
Write for particulars, rates of pay, etc. Send 3c stamp. Auto-Knitter Hosiery (Can.) Co., Ltd. Dept. 311R, 257 College St., Toronto.

Advocate Ads. Pay



Head Office, Toronto

AN HUNDRED-BUSHEL CROP of comfort will be the yield if you invest now in an Old Age Endowment OF THE
EXCELSIOR LIFE INSURANCE COMPANY
For Pamphlet and Memo. Book, write Dept. F.

1. Carefully plan the crop production for the season at an early date.
2. Thoroughly clean and grade the grain so as to procure the large, plump, sound and well-matured seed.
3. Test the germinating power and the vigor of the seed before time to sow.
4. Overhaul implements and machines so as to be ready to start seeding early and to sow each class of crop at the best time for highest results.
5. Arrange for at least a small amount of such cultivated crops as beans, potatoes, turnips and corn.
6. Watch and destroy the weeds before they are able to make much headway.
7. Economize man labor by using three and four-horse teams when possible.
8. Plan so as to make the best use of the unskilled labor which is available.

Copies of bulletins on "Farm Crops," "Field Beans" and "Potatoes" may be obtained from the County Agricultural Representatives or from the Ontario Department of Agriculture, Parliament Buildings, Toronto.

Let us do our part as best we can for the good of humanity and for the prevention of a world famine in essential food materials.

C. A. ZAVITZ, O. A. C., Guelph.

Gossip.

Cleanings From Oak Park Farm.

Beautifully situated on the main road about half way between Brantford and Paris, Ont., lies some 500 acres of choice sandy loam known to Canadian live-stock men for more than a quarter of a century as Oak Park Farm; the home of many a champion on both this and the other side of the border. In the old days, however, Shorthorn cattle, Yorkshire swine and Shropshire sheep were the chief lines, but five years ago, when the present owner, W. G. Bailey, purchased the entire establishment, the Shorthorns were disposed of and replaced by the splendid herd of Holsteins which brought so many new laurels to Oak Park on the Ontario show circuit in the fall of 1916. The Shropshires and Yorkshires, while they are no mean side lines, were at the time of our visit sold down exceptionally low, so that most of our time was spent in the dairy barns amongst the Holsteins. In all, the herd, at present, numbers almost 100 head, including, of course, the 1917 calves, of which there are a large number. These, as are also the majority of the one and two-year heifers, are all sired by their grand champion Toronto and London winner, Lakeview Dutchland Hengerveld 2nd. The senior sire in service, Lakeview Dutchland Hengerveld 2nd, should need very little introduction to Farmer's Advocate readers. To say that he is a 27.18 lb.-bred son of that great sire Colantha Johanna Lad seems almost sufficient in so far as his breeding is concerned, but to say that he was first, as a two-year-old, at Toronto in 1915 and the grand champion bull again at both Toronto and London, 1916, seems to leave no room for doubt as to his worth among the best sires of the country to-day; many of his get were also prominent winners in 1916, and the majority of these are still in the stables. They all have their sire's same great depth and smoothness, all are exceptionally well grown, and the majority are from the good record cows that are now in the Oak Park herd. These records run up to 26.15 lbs. of butter in 7 days for 5-year-old cows, while the highest 3-year-old record is 22.28 lbs., and the highest 2-year-old, 20 lbs. The management are, however, expecting to be able to announce several excellent new records within the next few months. For use on the heifers sired by Lakeview Dutchland Hengerveld, Mr. Bailey has just recently purchased the young sire, King Sylvia Keyes, which is without doubt one of the best individual young sires in the country. He is sired by Inka Sylvia Beets Posch, the sire of the world's champion milk cow, May Echo Sylvia; while his dam, Helena Keyes, is a show ring champion winner and is fully expected to materially increase her 26.26 lb., 7-day record when freshening within the next few weeks. King Sylvia Keyes carries 62½ per cent. of the same blood as May Echo Sylvia, 92½ per cent. the same as Helena Sylvia Posch, the only heifer in Canada to make 100 lbs. of milk in one day with second calf, and, still better, 20 of his nearest relatives average 29.97 lbs. of butter in 7 days. Mr. Bailey is leaving very little "to chance" in following up his champion senior sire with such record breeding as has King Sylvia Keyes.