

Plan of ground floor.

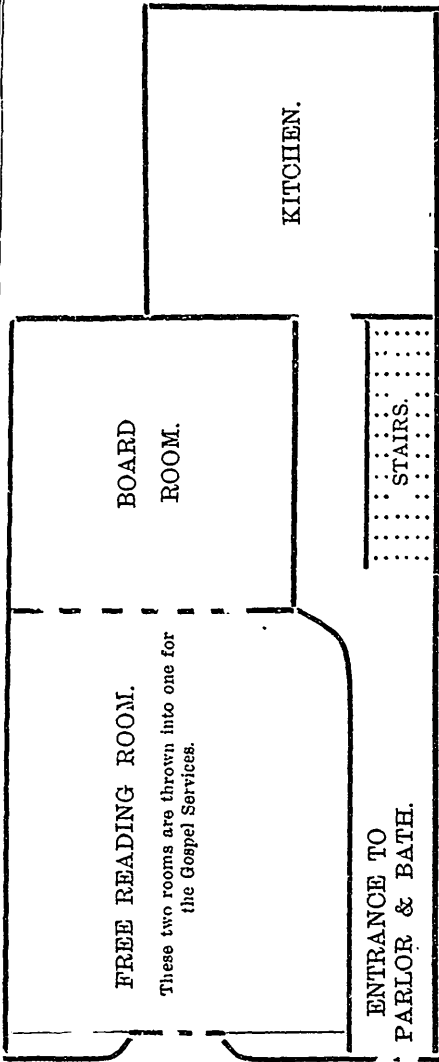

Plan of first floor.

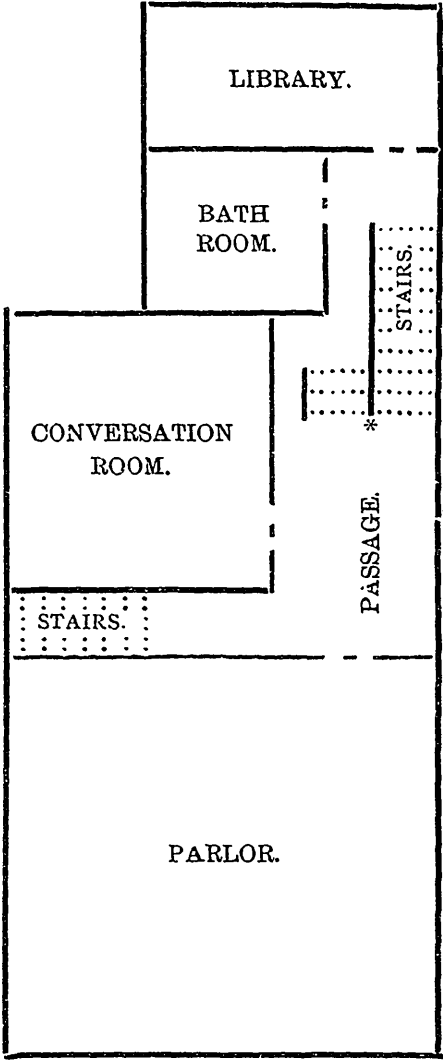

QUEEN STREET.

The room on ground floor is 15 x 32 ft. Parlor, 21 x 18 ft. Conversation and Amusement Room, 14 x 14 ft. Room for Library, 14 x 13 ft.

with ice cream and cake, and many accepted the invitation. The meeting which was a great success was not broken up till quite a late hour. Above will be found a diagram and description of the rooms.

We hope the railway men when they need anything in the watch line will call and see Kent Bro.'s stock, at 168 Yonge St., before purchasing elsewhere; they made us a present of the clock in West End Reading Room.