

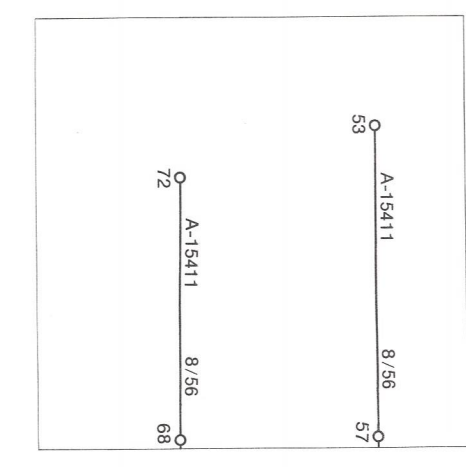

LEGEND - LÉGENDE

Legend table with two columns: English and French descriptions of symbols for roads, landmarks, drainage, relief, and other features. Includes symbols for roads, landmarks, drainage, relief, and other features.

PHOTOGRAPHY PHOTOGRAPHIE



REVISION

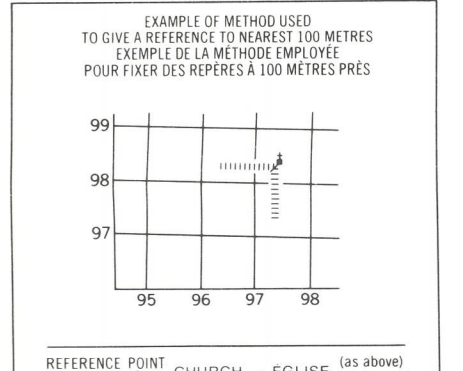
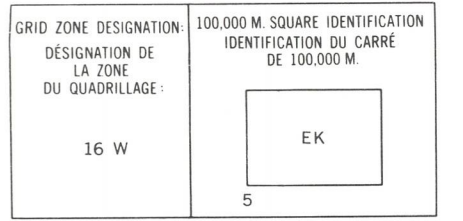
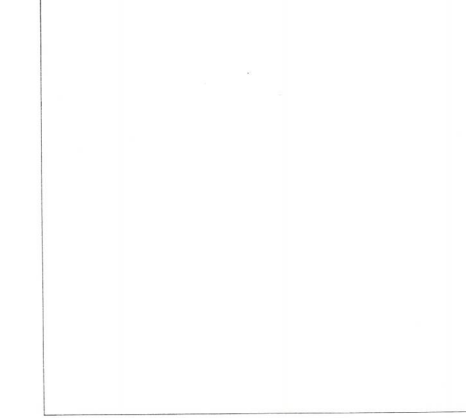

Text explaining the grid reference system, including 'REFERENCE POINT', 'EASTING', 'NORTHING', and 'GRID REFERENCE SAMPLE'.

ONE THOUSAND METRE UNIVERSAL TRANSVERSE MERCATOR GRID ZONE 16 QUADRILLAGE DE MILLE MÈTRES UNIVERSEL TRANSVERSE DE MERCATOR

Table of grid zone designations: 46 M/11, 46 M/10, 46 M/9, 46 M/6, 46 M/7, 46 M/8, 46 M/3, 46 M/2, 46 M/1.

Text explaining the magnetic bearing and annual change of magnetic declination: 'The 1974 MAGNETIC BEARING is 35°10' (825 mils) WEST OF GRID NORTH. ANNUAL CHANGE DECREASING 25.2° GRID NORTH is 0°14' (4 mils) EAST OF TRUE NORTH for centre of map.'

Text stating: 'THE MAGNETIC COMPASS IS LIKELY TO BE USELESS IN THIS AREA. LA BOUSSOLE SERA PROBABLEMENT INUTILE DANS CETTE RÉGION.'

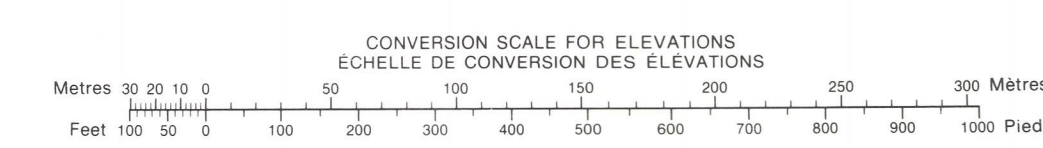

Produced by Surveys and Mapping Branch, Department of Energy, Mines and Resources, Ottawa, 1974.

Contour interval: 50 feet. ELEVATIONS IN FEET ABOVE MEAN SEA LEVEL. NORTH AMERICAN DATUM 1927. TRANSVERSE MERCATOR PROJECTION.

CAPE WATT DISTRICT OF FRANKLIN NORTHWEST TERRITORIES

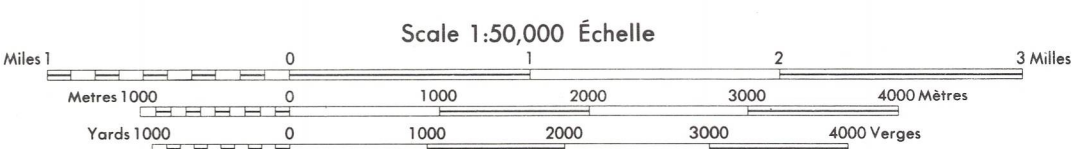

Équidistance des courbes: 50 pieds. ÉLEVATIONS EN PIEDS AU-DESSUS DU NIVEAU MOYEN DE LA MER. SYSTÈME DE RÉFÉRENCE GÉODÉSIQUE NORD-AMÉRICAIN 1927. PROJECTION TRANSVERSE DE MERCATOR.

Établi par la direction des levés et de la cartographie, ministère de l'énergie, des mines et des ressources, Ottawa, en 1974. Ces cartes sont en vente au bureau de distribution des cartes, ministère de l'énergie, des mines et des ressources, Ottawa.