

ing description, but the posts and the timbers carrying the central part of the roof are exactly like those of the houses. The houses of the

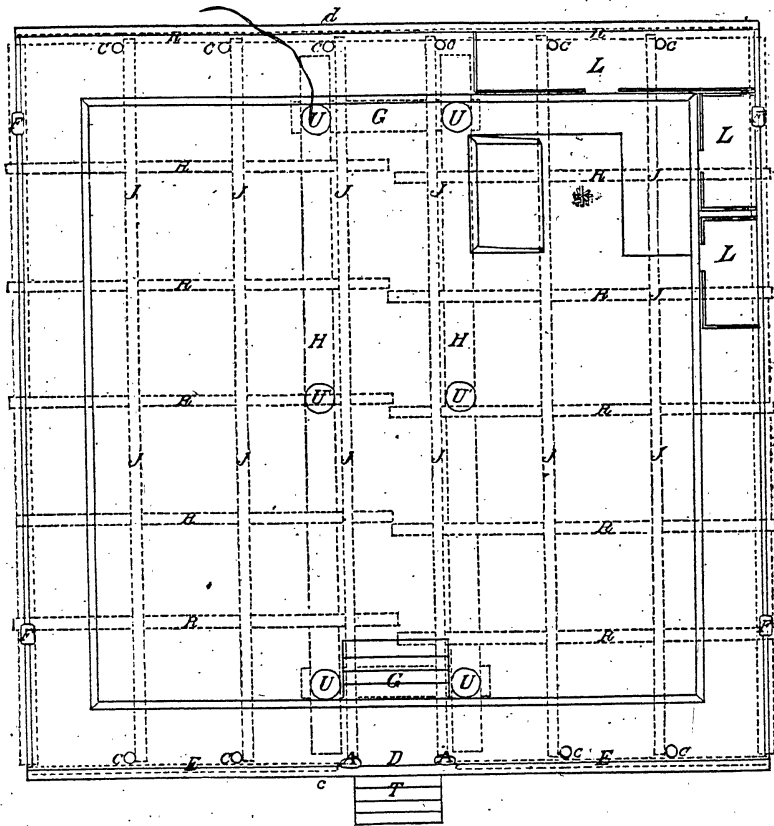

FIG. 2. Ground plan of Kwakiutl house.

Kwakiutl and their neighbors form a square, the sides of which are from 40 to 60 feet long (Figs. 2, 3, 4). The door (*D*) is generally in the center of the side nearest the sea, which forms the front of the house. The

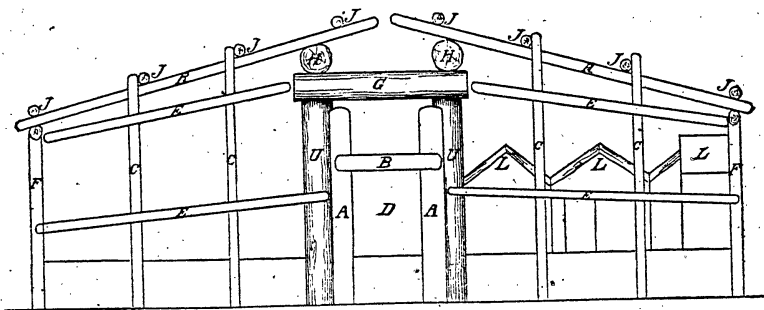

FIG. 3. Construction of Kwakiutl house. Front elevation.

latter has a gable roof, the ridge of which runs from the front to the rear. The walls consist of boards, which are fastened to a frame-work