



AN ADIAN ARCHITECT

BUILDER

MECHANICAL & INDUSTRIAL ARTS
 DECORATION & FURNISHING
 CONSTRUCTION & SANITATION
 ENGINEERING

Vol. VI.—No. X.

OCTOBER, 1893

PRICE 20 CENTS
 \$2.00 PER YEAR.

As any one passes up and down in the public buildings, hotels, clubs, dwellings and business structures, he seems invariably to ride in Otis Elevators, built by Otis Brothers & Co., 38 Park Row, New York. Canadian Offices: 45 St. Sacramento Street, Montreal, and Queen's Hotel, Toronto.

HYDRAULIC FOR FREIGHT AND PASSENGER
 FAST ELEVATOR VALVES
 SCREW GEAR
 BELT STEAM
 PORTABLE ELEVATOR & CEILING HOISTS
 SPECIAL STYLES FOR APARTMENTS
 HAND POWER
 ELECTRIC SAFETY ELEVATOR
 DIRECT TRIP AND PUMPING SYSTEMS
 SAFETY CARS OF NEW BEAUTIFUL DESIGN

— CANADA ELEVATOR WORKS —
 LEITCH & TURNBULL, HAMILTON, ONT.

A HARDWOOD FLOOR

should be an artistic as well as a useful feature in the house. Wide boards with $\frac{1}{8}$ in. crevices between are not beautiful. Our floors are $\frac{5}{16}$ in. thick, are laid on top of any ordinary floor, are so perfect that a sheet of paper could not be inserted in the joints. They are made in oak, cherry, walnut, mahogany and other woods. Cost little more than a good carpet, and can be laid by any good carpenter. We quote prices to supply or supply and lay in any part of Canada. Send for sheet of designs and price list.

Wall Papers
 Stained Glass
 Relief Ornament
 Wood Floors

ELLIOTT & SON
 92 to 96 Bay Street,
 TORONTO.

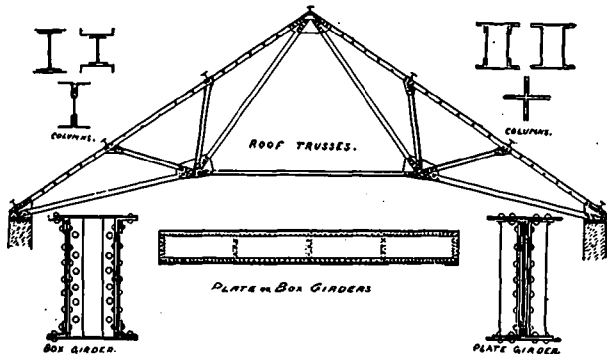

DOMINION BRIDGE CO. (LIMITED)

WE BUILD

Bridges of all designs in both Iron and Steel, Roofs, Telephone Poles, House Girders, and all kinds of Structural Iron Work.

OUR STOCK IN HAND COMPRISES

Steel Beams, Angles, Tees, Channels, Plates, Rolled Edged Plate, Bars, Rivets, Rounds, &c.; Iron Beams, Bars, Squares, Rounds, Turnbuckles, Rivets, &c.

Estimates furnished for Structural Iron Work delivered at building or erected.

J. H. MCGREGOR,
 Ontario Agency: 35 York Street, Toronto.
 Telephone 2164.

R. B. ROSS,
 Montreal Agent: 35 St. Francois-Xavier St.
 Bell Telephone 596.

Telephone
 2535



TUCKER & DILLON,
 Sheet Metal Cornice
 Workers. 22 Adelaide St. W.
 Ceiling work a specialty. TORONTO.

JOHN WHITFIELD,

174 and 176 Front Street East,

SUPPLIES ALL KINDS OF

IRON AND STEEL WORK

FOR BUILDERS, &c.

Telephone No. 2099.