

# ~ VERTICAL OR VELOCITY CURVES USED IN GRADES ~

GENERAL RULE - The length of Velocity Curves should be governed by the conditions of the ground; that is after the grade on either side has been determined, it then depends on the cuts and fills near the intersection point, as to whether a flat or sharp curve will be allowed. Bear in mind that the flatness increases with the length -

~ TABLE ~

| Length given for each tenth of Algebraic difference in the intersecting grades - | Rate of change -<br>1st Point. Intermediate points | In plotting on regular profile paper use the following degree of curve |
|--|--|--|
| 50'  | 00.100   | 2° - 10'   |
| 100'   | 00.050   | 1° - 05'   |
| 200'   | 00.025   | 0° - 33'   |

## ~ EXAMPLE ~

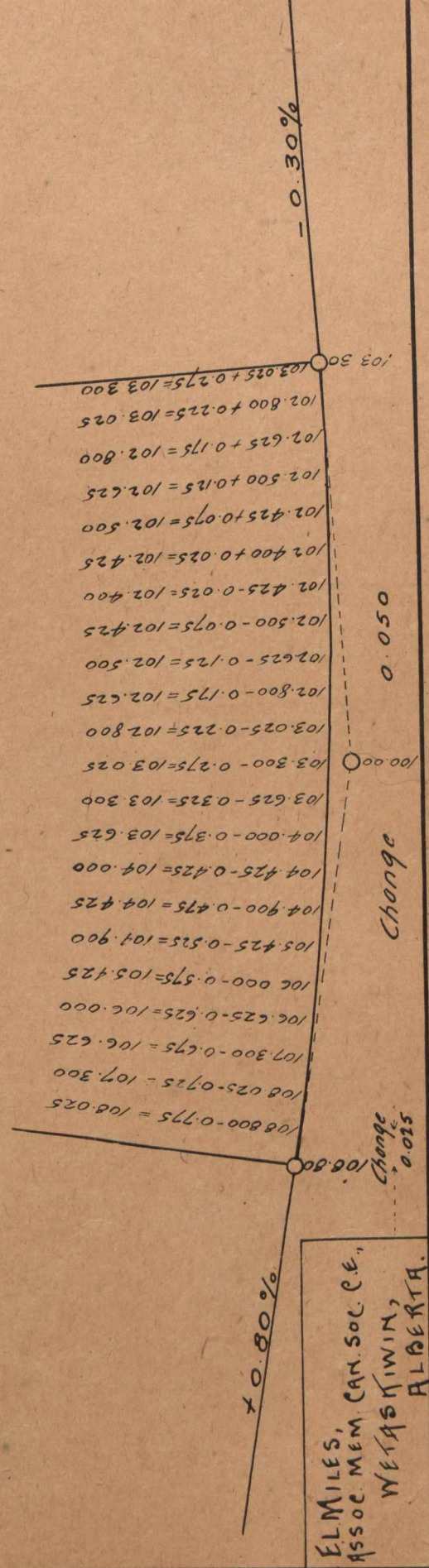

ELMILES,  
ASSOC. MEM. CAN. SOC. C.E.,  
WETASKIWIN,  
ALBERTA.