

GROUND FLOOR PLAN.

is a large allegorical painting typifying the various features of the stage, and reminiscent of Montreal in the background, all cleverly illuminated by concealed lighting.

Our only criticism is that of the inevitable electric sign, which is as usual a hideous excrescence on the exterior of the building, but presumably the architects could not control this commercial necessity.

BUILDING MATERIAL SHORT-AGE IN NETHERLANDS

At a meeting in Amsterdam of an association of employers and workmen in the building industry, gloomy reports were made regarding the supply of timber for building purposes. Holland has more woodlands than most foreigners suppose, but they are far from sufficient

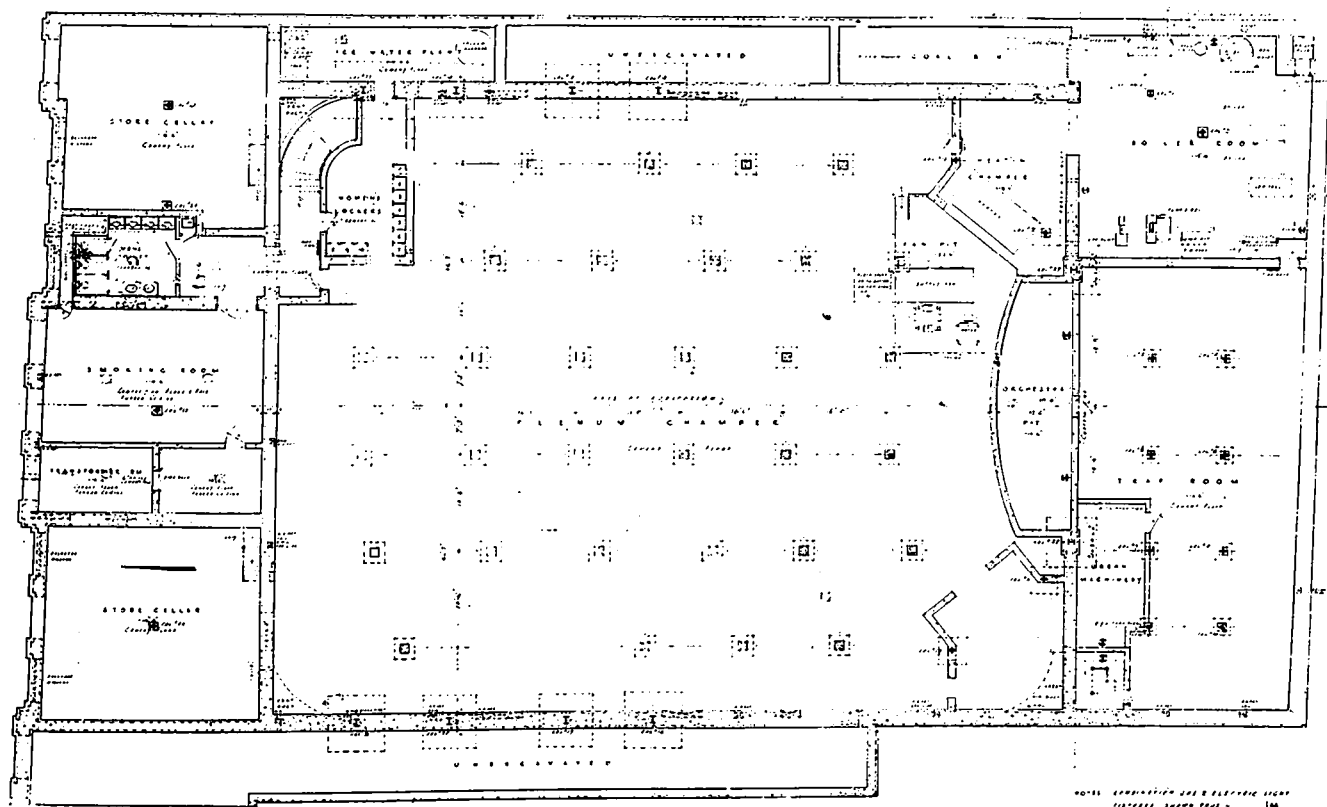

BASEMENT PLAN, ST. DENIS THEATRE, MONTREAL.

NO. 11. ILLUMINATION AND ELECTRIC LIGHT
FIVE-FOOT SQUARE PLATEAU CHAUFFÉ
THE POSITION OF SEWERS, GAS PIPES
AND TELEPHONE LINES ARE INDICATED