

THE CANADIAN ARCHITECT AND BUILDER

Vol. XVII.—No. 8.

TORONTO, MONTREAL AND WINNIPEG, CANADA, AUGUST, 1904

PRICE 25 CENTS
3.00 PER YEAR

TILES MOSAICS PAIENCED
Craven, Dunnill & Co., Limited

JACKFIELD, R. & O., SHROPSHIRE.
SHOWROOMS—
London: 27, Maddox St., Regent St. W.
Birmingham: 174, Corporation Street.
Manchester: 64, Bridge St., Deansgate.

ENAMELS LUSTRES WALLS

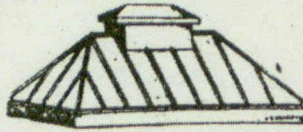

METAL

Roofing
Cornices
Ceilings
Sky-lights
Fire-Proof Windows
Corrugated Iron

SEND MEASUREMENTS FOR ESTIMATES.

A. B. Ormsby Limited, ROOFERS AND METAL WORKERS.
Cor. Queen and George Streets, Toronto, Ont.

OTIS ELEVATORS

"The Standard of the World"

CANADIAN OTIS ELEVATOR COMPANY, LIMITED

Hamilton

Toronto

Montreal

THERE IS THIS
FEATURE ABOUT

Fensom's Elevators

which attracts the attention of those who know anything about hoisting machinery:—

Their Entire Construction is Mechanically Correct

Unsafe or untried ideas are never utilized.

We are in a position to install elevators for any service.

FENSOM ELEVATOR WORKS

100, Duke Street, TORONTO, ONT.

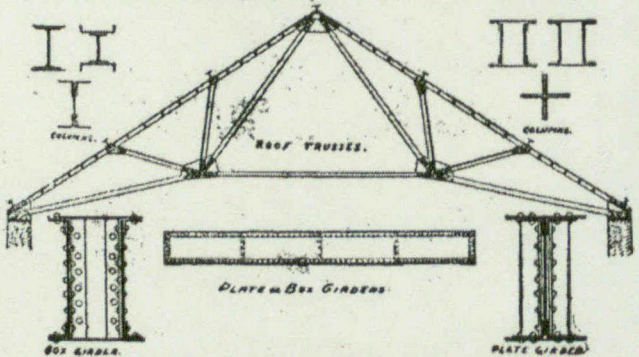

DOMINION BRIDGE CO. (LIMITED)

WE BUILD Bridges of all designs in both Iron and Steel, Roofs, Telephone Poles, House Girders, and all kinds of Structural Iron Work.

OUR STOCK IN HAND COMPRISES Steel Beams, Angles, T-ees Channels, Plates, Rolled Edged Plate Bars, Rivets, Rounds, &c. Iron Beams, Bars, Squares, Rounds, Turnbuckles, Rivets, &c.

Estimates furnished for Structural Iron Work delivered at building or erected

GEORGE E. EVANS,
Ontario Agency: Room 38, Canada Life Building, Toronto Telephone Main 364.

P. O. Address . . .
DOMINION BRIDGE CO. Ltd., Montreal, P. Q.
Works at Lachine Locks, P. Q.



HAPPY THOUGHT FOLDING PARTITION FIXTURES are what you require to secure positive, uniform and easy motion, for all widths and heights of opening.
O. T. SPRINGER,
Box 44, BURLINGTON, ONT.

ELEVATORS

For all purposes. Satisfaction guaranteed.
Write for prices and references.

THE PARKIN ELEVATOR WORKS

134 Bay Street North,
HAMILTON, ONT.