



GROUP DEVELOPMENT, LYNDBURST AVENUE, TORONTO.
HAROLD R. WATSON, ARCHITECT.

ceedingly monotonous type of architecture adjacent to the site. The south house, which is illustrated by plan, is just being completed, and its irregular contour was necessary through the slope of the adjacent street.

The living room feature is worthy of note

through the excellent placing of the fireplace location to the north, which allows for a delightful southern exposure to the living room proper. The house is finished downstairs with the exception of the dining room, in quartered white oak; the dining room is in gum wood, and the

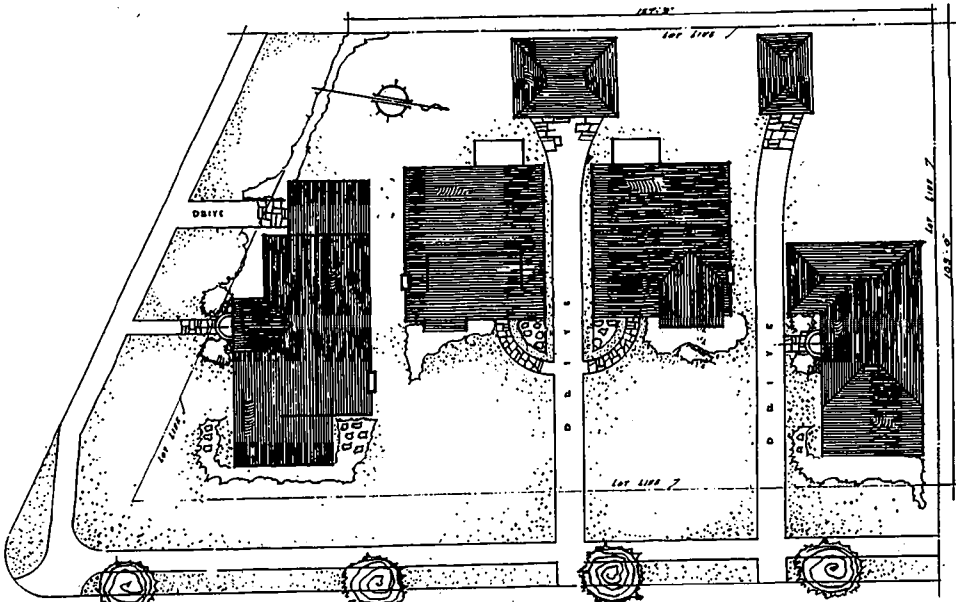

PLOT PLAN