

This is an error, made in drafting the map. These lots are the same depth as the other corner lots in these four Blocks, namely, 155 feet. All corner lots in these four Blocks are \$175 each. All inside lots in these Blocks are \$125 each. But where a corner lot and an adjoining inside lot is purchased, a discount of \$25 will be allowed, that is a corner lot and an adjoining inside lot in these four blocks may be purchased for \$275. We call the attention of prospective purchasers of corner lots to the many advantages of buying also an adjoining inside lot, which will give a frontage of 155x114 feet. Many corner lots sold by others are only 25x110 feet, yet the demand for lots in the important Western Canada cities is so great that lots of this size sell readily. Those who purchase a corner and an adjoining inside lot will have six lots (lacking one foot), each 26x114 feet. Another advantage is that in erecting a dwelling house or stores the building can front on either street, whereas if the purchaser owned but one 67 foot lot he would not have this choice.

Lots 1 and 2, or 8 and 9, or 10 and 11, or 17 and 18, in any of these four Blocks, can be purchased for \$275.00, payable \$27.50 with your application, and the remainder in nine monthly instalments of \$27.50 each. If you desire to pay cash in full with your order a discount of 5% may be deducted, that is \$261.25 will pay in full for two lots.

All other corner lots are 50x150 feet, excepting Blocks 135, 140, 143 and 148, which are 55x150 feet. The price of these corner lots is \$150 each. All inside lots are \$100 each. A corner lot and an adjoining inside lot having a frontage of 150 x100 feet, may be purchased for \$225, or a saving of \$25, payable on the terms stated above. It will be noticed that those who purchase a corner lot and an adjoining inside lot in Blocks 135, 140, 143 and 148 will secure a frontage of 150x110 feet, at the same price, namely, \$225.

All lots have 20 foot lanes in rear.

No interest is charged on deferred payments.

Perfect title issued direct from the Grand Trunk Pacific.

No taxes to pay on these lots until the year 1912.

If selection of lots made by our representative is not satisfactory The Grand Trunk Pacific Railway Company guarantee to give the purchaser his choice of lots remaining unsold, at the same price, or refund all money paid.

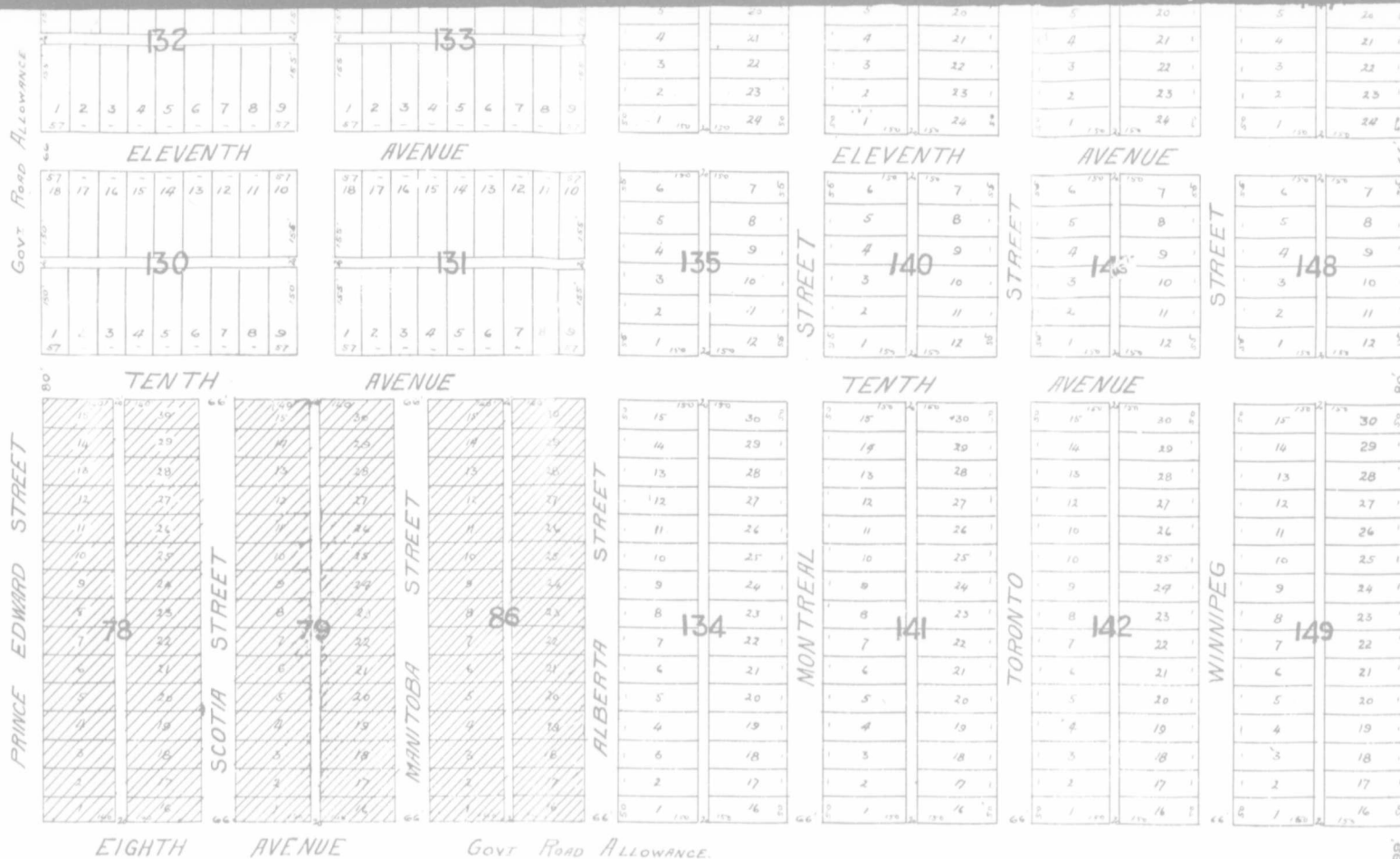

99' 99'

LAND DEPT.
GRAND TRUNK PACIFIC RAILWAY
WINNIPEG
October 1910
W. H. H. H.
Land Commissioner

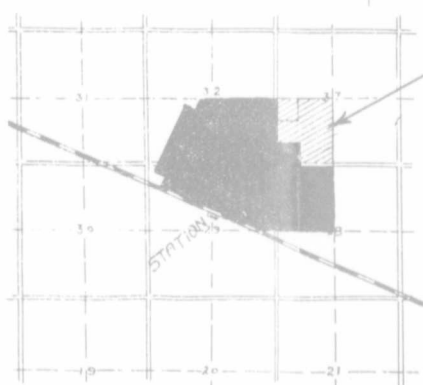

THE ABOVE SUBDIVISION

PLAN SHOWING ADDITION TO TOWNSITE OF
MELVILLE
ON ITS EAST SIDE

SW 1/4 SEC 33 Tp 22 RANGE 6 WEST OF 2ND MER.
SECOND DIVISIONAL POINT ON MAIN LINE
GRAND TRUNK PACIFIC RAILWAY
279.3 MILES WEST OF WINNIPEG.

LOTS SOLD

Send Orders and Remittances direct or through our authorized representatives in the various cities to
Land Commissioner
GRAND TRUNK PACIFIC RAILWAY
SOMERSET BLOCK, WINNIPEG, MANITOBA

All inquiries and requests for further information should be addressed to
International Securities Co. Limited (Melville Dept.)
EXCLUSIVE SELLING AGENTS
SOMERSET BLOCK, WINNIPEG, MAN.
We want a Good Agent in every locality to sell lots in Melville and other good towns on the G. T. P. Railway