

## BUSINESS LOCALS

Remodeling, fur storage—Morin, 52 Germaln. 12828-5-2

Have a "Hart," men. Get them at Wiese's for \$7.75 and \$8.75.

**A FISH DINNER.**  
Red Clover Salmon. For dinner, salads, sandwiches. Nothing equals it. 12902-4-29

**CARD OF THANKS.**  
Loyalist Temple, No. 18, Pythian Sisters, wish to thank T. H. Eds-brooks & Co. for demonstrating Red Rose coffee at the Temple anniversary on April 25 and also to thank all those who kindly assisted in making the programme so successful. 12902-4-29

**DESIGNER SUBSCRIBERS**  
Please call for your magazines at Macaulay Bros' store this week. June copies will be obtained from T. W. Thompson, 385 Main street. 12902-4-29

Regular meeting Moulton Temple, No. 14, Pythian Sisters, Monday evening, at 7.15 sharp, Castle Hall, Union street. 12902-4-29

**NOTICE.**  
Mr. George K. Bell having disposed of his drug business, all accounts due by him must be paid at the offices of MacLach, Sinclair & McRae, Pugsley Building, on or before the 10th day of May, 1924. 12973-4-29

**EUCARISTIC CONGRESS PICTURES TONIGHT AND TUESDAY NIGHT**  
A faithful reproduction of a great religious event also showing pictures of the Eternal City. This picture is one of the real big ones of the day. Tickets 15 cents. St. Vincent's Auditorium, Cliff St. 12977-4-29

## Your Guarantee

is the name

# "SALADA"

It insures tea that is fresh, fragrant and pure—Try it.

Colored Mats  
Milliners say that despite the fact that colored hats are shown it is difficult to get the average woman to wear them, that she prefers black or a combination of black and white.

## BIRD'S ASPHALT TWIN SHINGLES

Surfaced with natural Slate Red, Green or Blue-Black  
Attractive, Fire-Safe, Long-Wearing.

Write us for name of your Bird dealer and Free Booklet—"The Roof the owner is proud of"—  
**BIRD & SON, LIMITED**  
Head Office—Hamilton, Ont.  
GANDY & ALLISON, LTD. Dealers.  
St. John Warehouse, 1 and 4 North Wharf, Phone 1541.



## Sharpes Know To Fit Them Nicely

Youth and Glasses must go well together, for so many of every age must have Glasses to overcome defective vision and strain that bring on headaches.

Sharpes Glasses make your appearance show up comfortably.

## SHARPES

Opposite Oak Hall.  
(Glasses by part payment.)

## "Mamma" 98c Dolls

\$1.25, \$2.40 up to \$18.00

Soft "Cuddle" Dolls (for Baby) 15c, 29c, 39c, 50c, 98c

Sent by mail upon receipt of price.

## WASSONS

9 SYDNEY ST. 711 MAIN ST.

## BUSINESS LOCALS

**PRIZE MASQUERADE DANCE, "RITZ," TUESDAY.**

Four costume prizes; eccentric dancing by "Billy Carrigan." Admission 25 and 50 cents. Special musical features tonight. 12908-4-29

**NO PRETENCE HERE.**  
Hard facts. Our drive sale of wall papers continues for 10 days. All grades of wall paper in any quantity. Bedroom and kitchen, 6c to 69c per roll; parlor, dining room, hall or den.

10c. to 89c. Odd borders, 2c. to 8c. Special. McArthur's, 19 King square only. 12907-4-29

St. David's superfluous sale, April 29 and 30, corner Union and Waterloo. 12909-4-29

**RUMMAGE SALE.**

St. Andrew's church schoolroom, Tuesday, 29th, 2 o'clock. 12907-4-29  
The annual meeting of the Seamen's Mission Society of the Port of St. John will be held in the Seamen's Institute on Friday, May 2nd, at 4 p.m.

All members and subscribers are requested to be present.

J. N. ROGERS, secretary. 12910-5-1

**SOLDIER'S LIFE ENDS.**

The death of Patrick Gulemet of Little Caraguet, N. B., occurred yesterday morning at the St. John County Hospital. He enlisted in 1916 in the 163rd Battalion and served in France. He was discharged from the army in 1918, in poor health and given treatment at the County Hospital, being discharged from there slightly improved. In December, 1922, he was

## Henry Ford Is "At The Throttle"

Marquette, Mich., April 28—Henry Ford is learning to drive a locomotive; Harvey Firestone, millionaire tire manufacturer, is acting as fireman, while Thomas Edison encourages them when they return from the engine cab of the Ford special train touring the upper peninsula of Michigan on an inspection tour of Mr. Ford's properties. Mr. Ford has taken to his new job with the avidity of a youngster, according to the trainmen with the party, and can handle the engine efficiently. Mr. Firestone, they said, is a fireman. Mr. Edison is taking his annual outing with the Fords. Mr. and Mrs. Edsel Ford also are with the party.

## AUTOS COLLIDE

Following a collision with another auto on Sunday, J. H. Simpson, a local taxi driver, will come before Magistrate Wilson Dutton, Renforth, on Tuesday, on the charge of driving on the wrong side of the road while under the influence of liquor. The other car, owned by Mr. Hamm, was not injured.

London has a deep sea divers' school.

## Ceylon Tea

We have just received, direct from Ceylon, a shipment of Black Tea to retail at 53c per lb.

## Humphrey's Coffee Store

14 KING ST.

For EYE Trouble  
Consult  
K. W. EPSTEIN & CO.  
Optometrists & Opticians  
195 Union St.

## Robertson's

554 Main St. Phone M. 3461  
141 Waterloo St. Phone M. 3457

1 lb Block Pure Lard..... 19c  
3 lb Tin Pure Lard..... 55c  
5 lb Tin Pure Lard..... 87c  
1 lb Block Domestic Shortening... 18c  
3 lb Tin Domestic Shortening... 52c  
5 lb Tin Domestic Shortening... 83c  
Small Picnic Hams..... 17c. lb.  
Bacon by the piece..... 22c. lb.  
Best Creamery Butter..... 45c. lb.  
6 lbs Best Onions..... 25c  
6 lbs Pastry Flour..... 25c  
5 lbs Whole Wheat Flour..... 25c  
5 lbs Graham Flour..... 25c  
5 lbs Oatmeal..... 25c  
3 lbs Lima Beans..... 25c  
2 qts Yelloweye Beans..... 24c  
2 qts Small White Beans..... 24c  
4 Bags Table Salt..... 25c  
3 pkgs Shaker Salt..... 25c  
3 1/2c. Boxes Matches for..... 33c  
Nonsuch Stove Polish..... 16c. bottle  
2 qts Best White Beans..... 24c  
2 qts Y E Beans..... 24c  
6 lbs Pastry Flour..... 25c  
5 lbs Best Oatmeal..... 25c  
4 lbs Rice..... 25c  
3 pkgs Shaker Salt..... 25c  
3 pkgs Lipton's Jelly Pdr..... 25c  
2 lb tin Red Cherries..... 23c  
2 lb tin Sliced Pineapple..... 23c  
2 2-lb tins Plums..... 29c

## BIG SPECIALS AT DYKEMAN'S

443 Main St. Phone 1109  
151 City Road

10 lbs Lantic Sugar,  
with orders .. \$1.00

Best Small Picnic Hams, lb 17c  
6 lb Best Onions..... 25c  
Finest Dairy Butter, lb..... 39c  
Best Creamery Butter, lb..... 44c  
1 lb block Pure Lard..... 19c  
3 lb tin Pure Lard..... 55c  
5 lb tin Pure Lard..... 87c  
2 tins St. George Milk, large 25c  
2 qts Best White Beans..... 24c  
2 qts Y E Beans..... 24c  
6 lbs Pastry Flour..... 25c  
5 lbs Best Oatmeal..... 25c  
4 lbs Rice..... 25c  
3 pkgs Shaker Salt..... 25c  
3 pkgs Lipton's Jelly Pdr..... 25c  
2 lb tin Red Cherries..... 23c  
2 lb tin Sliced Pineapple..... 23c  
2 2-lb tins Plums..... 29c

Large tin Red Salmon,  
Reg. price 40c,  
Only..... 25c

4 lb glass jar Pure  
Raspberry Jam..... 90c  
4 lb glass jar Pure  
Strawberry Jam..... 90c

98 lb bag Robinhood  
or Cream of West..... \$3.75

98 lb bag Purity or  
Five Roses .. \$3.75

24 lb bag Robinhood or  
Cream of West \$1.00

Finest White Potatoes,  
1-2 barrel bag \$1.60

5 lbs Best Bulk Cocoa,  
only..... 28c

Goods delivered to  
all parts of the City,  
Carleton and Milford.

## Robertson's

THE 2 BARKERS, LTD.

100 PRINCESS STREET  
Phone M. 642

Satisfaction guaranteed or money  
cheerfully refunded.  
10 lbs. Granulated Sugar..... \$1.00  
24 lb. Bag Pastry Flour..... 89c  
24 lb. Bag Royal Household Flour..... 95c  
5 lb. Bulk Cocoa..... 28c  
10 lb. Bulk Cocoa..... 55c  
Best Small Picnic Ham, per lb..... 16.1c  
Best Flat Bacon, per lb., by piece..... 21c  
1 lb. Can Baking Powder..... 17c  
4 Rolls Toilet Paper..... 25c  
4 lb. Tin Apple and Strawberry..... 45c  
A good 3 string Broom for..... 49c  
2 lbs. Evaporated Apples..... 29c  
Comfort or Pearl Napsa Soap, 12  
bars..... 89c  
Non-Such Stove Polish, per bottle..... 15c  
Scrub Brushes or Stove Brushes..... 18c  
Sweet Relish, 8 oz. bottle, 3 for..... 25c  
Bulk Tea, per lb..... 45c and 55c  
Chase & Sanborns Seal Brand, per  
lb..... 55c  
Fresh Ground Coffee, 40c per lb to 55c  
Shelled Walnuts, per lb..... 33c and 43c  
California Prunes, 3 lbs. for..... 25c  
12 oz. Can Jersey Cream Baking  
Powder..... 29c  
Best White Potatoes, per 5 lbs..... 29c  
Goods delivered in City, West Side  
Fairville and Milford.



A nice pattern for the living room, one of the many attractive designs available in tasteful colorings.

# Delightful Patterns for Every Room

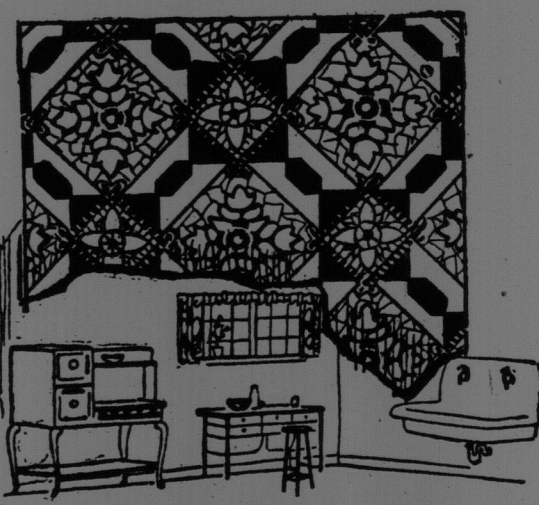

An attractive block pattern that looks well in any kitchen.



This pattern lends just that touch of brightness the Bedroom needs.

MUCH of the charm of a tastefully decorated room is due to its appropriate floor covering. The colors blend, the pattern harmonizes. It is pleasingly attractive, yet quietly unobtrusive, being part and parcel of, and in perfect accord with, its entire surroundings.

That is the kind of floor Dominion Linoleum assures. It is appropriate for every room. Rich and substantial, Dominion Linoleum never looks out of place whether in living or dining room, bedroom, hall or kitchen. Choosing the right color scheme and design from the endless variety of beautiful floral, oriental and block treatments offered, is simplicity itself.

You can have soft, soothing harmonies, or equally tasteful contrasts; subdued tones, or a note of cheery brightness. Consider the room, consider its furnishings and hangings and the effect you wish to get. Then choose Dominion Linoleum to suit.

## DOMINION LINOLEUM

by the yard comes in widths sufficient to cover the entire floor of any ordinary room, without seam or crack. Many, however, prefer Dominion Linoleum Rugs, made in convenient sizes, in the same wide range of artistic patterns.

Whichever you take, rug or piece goods, you are assured of a clean, sanitary, labor-saving floor of unusual beauty that will wear for years and years, giving comfort and pleasure every day of its life.

Dominion Linoleum and Dominion Linoleum Rugs are remarkably low in price. And their wonderful wearing qualities make them cheaper still. See them to-day at your dealer's.

Send us your name and address and we will send you an attractive rug folder in colors. Address—Dominion Oilcloth & Linoleum Co. Limited, Montreal.

Look for the strong, long-fibre burlap back when buying. It identifies genuine Dominion Linoleum and assures long and satisfactory wear. The Dominion label on the face of all Dominion Linoleum Rugs or piece-goods is an additional guarantee of quality.

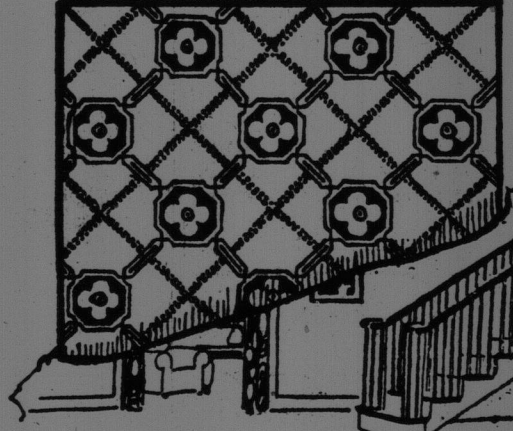

This refined design is particularly appropriate for Hall or Dining Room.

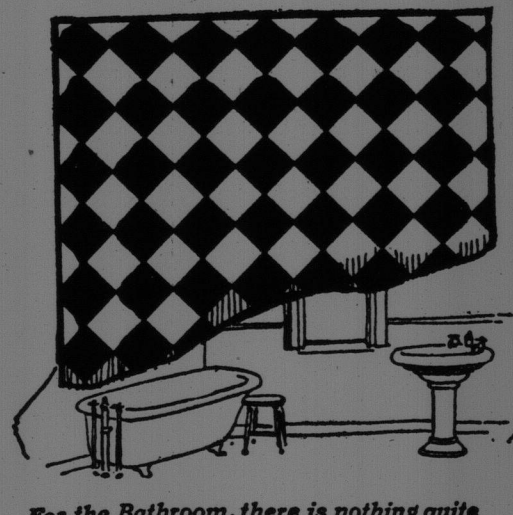

For the Bathroom, there is nothing quite as suitable as a simple tile design.

