

Layout diagram of the dialkylaminoethanol
production unit at the "Sintez" production
association



Key

Building
No.

- 75 Finished-product store
- 36.36A Dialkylaminoethanol production unit
- 156 Incinerators
- 123 Diethylamine store
- 121 Ethylene oxide store
- 99 Medical department
- 102 Para-military firefighting unit
- 547 Entrance

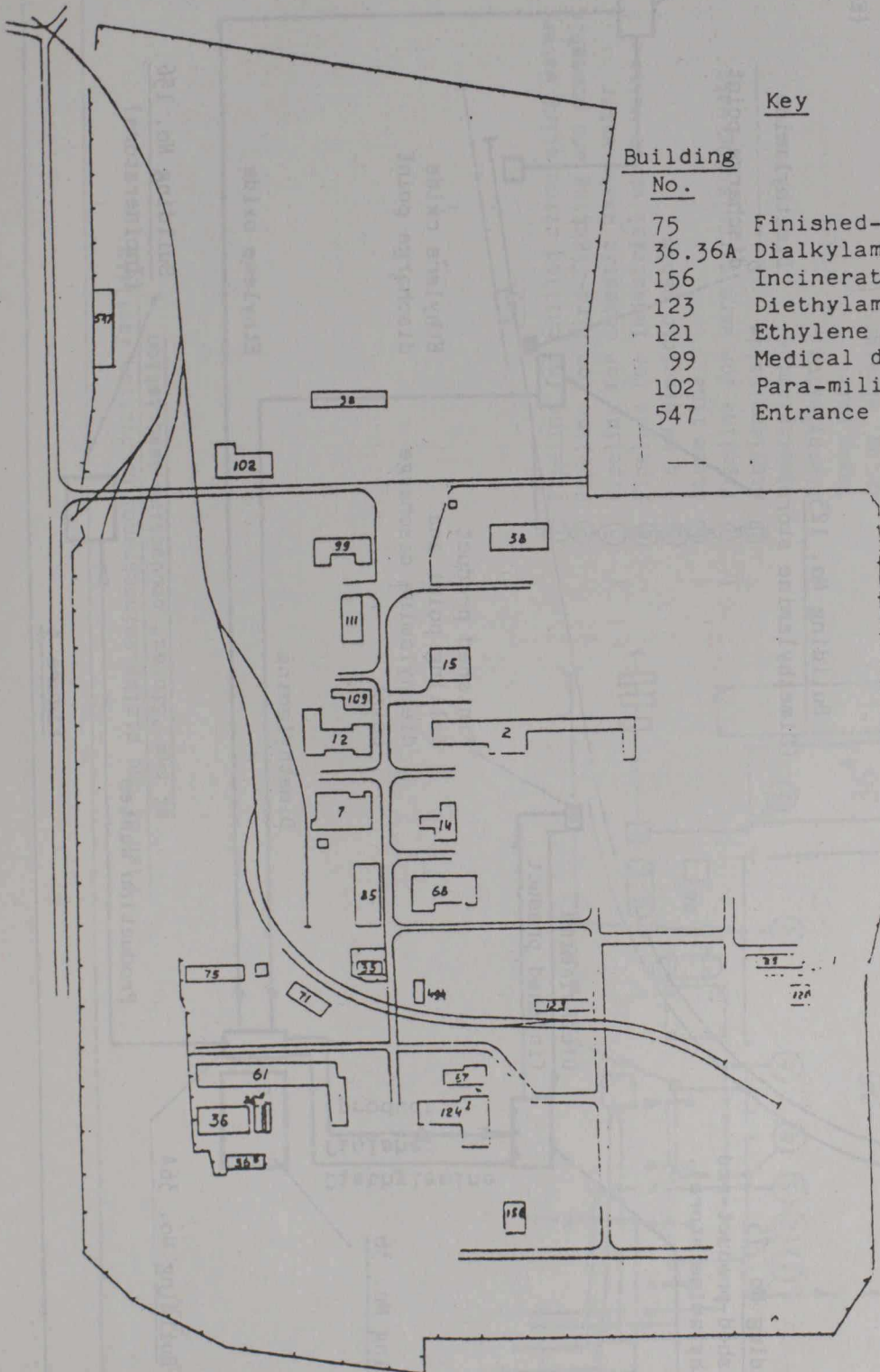

Figure 2