

FIRST FLOOR, PLAN OF NO. 2.

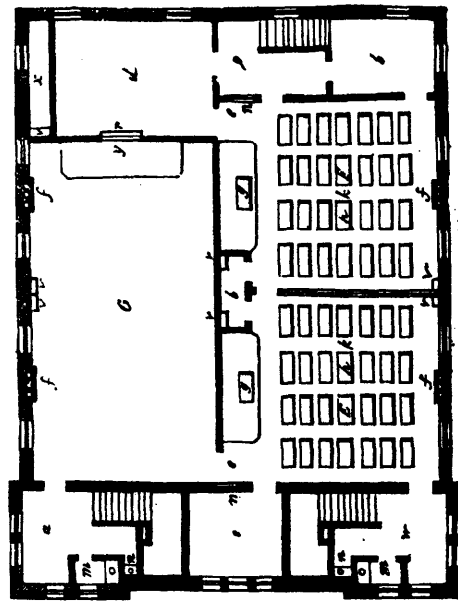

SECOND FLOOR, PLAN OF NO. 2.

- A. Girls' intermediate or Superior School room.
- C. Boys' intermediate or Superior School room,
- B. Boys' Primary.
- D. Girls' Primary.
- aa. Outside Porches for boys and girls.
- bb. Clothes rooms for boys and girls.
- c. Teacher's or recitation room.
- d. Entrance to Primary School and clothes room, with stairs to boys' upper room.
- e. Seats for two pupils each.
- f. Flues for warm air or gas.
- g. Teacher's desk.
- h. Passages two feet wide.
- v. Ventiducts.

- E. Girls' Secondary School.
- F. Boys' Secondary School.
- G. Lecture Room.
- a. Lobby and entrance to lecture room.
- b. Clothes room for boys.
- c d. Class rooms.
- ee. Passages.
- f. Flues.
- g. Teachers' Desks.
- h. Seats for two pupils each.
- l. Closets for books, &c.
- mm. Water Closets.
- nn. Wash basins.
- vv. Ventilating flues.
- w. Girls' clothes room.
- x. Closet for library and apparatus.

Secondary Schools may be placed across the back part of the building over the Primaries, each being of sufficient size to seat about sixty pupils; the partition between them should also be of glass, to correspond with the first story.

The remaining portion of the second story, next the stairs, will then become applicable to the lecture hall and class rooms; two class rooms of about twelve by fifteen feet each being taken off one end of this space.

The lecture hall will be about thirty by forty feet, and as it will never be occupied when the Schools are in session, the doors to the secondary and class rooms may open into it. By this arrangement, also, the class rooms will be readily accessible both to the Superior and Secondary Schools, in connection with which they will be chiefly used.

Thus the same space will be made to accommodate a larger number of pupils and in better proportion to the numbers and wants of each grade, than as set forth in the plans above given. The cost of the third stairway will also be saved, and will defray the expense of the alterations just specified.

If, however, the plans as given are preferred, the following are the specifications prepared to accompany them, without embracing any of the changes above recommended.

SPECIFICATION.

The building will be fifty five by seventy-six feet, with two towers projecting slightly from the line of the building. The first and second stories will be each fifteen feet in the clear; pitch of roof nine feet; and elevation of first floor two feet six inches. The walls will be of

stone, stuccoed on the exterior and laid off in blocks in imitation of cut stone. The eave and cornice and cupola, from the level of the eave, will be of wood, and painted and sanded in imitation of cut stone. The covering of the roof will be of tin, as also the base of the cupola and roof of the same, and of the porches. The exterior walls in the cellar will be twenty-four inches, the first story twenty-two, and the remainder twenty inches thick; the walls forming the front stairways will be of brick, thirteen inches first story, nine inches second. Piers will be built in the cellar of stone or hard brick, for the support of the iron pillars, 27 inches at the base, and tapering upwards to 18 inches at the top, for the support of the glass partition which runs longitudinally through the building, and for the support of the floors of joists. The flooring joists of the first, and second stories will be three by fourteen inches; and in addition, a camber-rod will be run through them. The roof will be constructed as in the plan aforesaid. The window frames the same, excepting that all the shutters will be hung inside.

This building will require three flights of stairs, with wall rail, &c. The glass partition in the first story will also require iron posts. The partition separating the girls' and boys' superior School room in the second story, will also be of sash, without the iron posts. The partition forming the lecture rooms, and all others, will be three by six inch scantling. A water closet and wash basin for the accommodation of the girls of the superior School, and also one of each for the teachers will be constructed where shown in the plan, and connected with sufficient and properly constructed sinks or wells.

PLAN No. 3. (See next page.)

The building next represented is 70 feet long by 40 feet wide; with a front projection, 28 feet long by 14 feet wide. The lot on which it is proposed to erect the building, should be from 150 to 200 feet long, and from 150 to 200 feet wide. They should be corner lots, if possible, and have large open spaces around them. The school-houses should be protected by small lightning-rods (as seen in the engraving, and each building furnished with a school-bell, which could be heard in the remotest part of the town, village, or section.

As seen in the engraving, the building should be surrounded by umbrageous elm, maple, and lime trees—thus giving an air of shade and coolness to the otherwise exposed situation of the building in summer, and relieving the bleakness of the general aspect of the com-

paratively isolated school-house lot in winter. It is greatly to be regretted that, in little matters of this kind, involving so much the comfort, cheerfulness, and happiness of both pupils and teacher, in the naturally heated atmosphere of a school-room, more attention is not paid to the interests of health. We would earnestly commend the matter to the attention of School Trustees and Building Committees.

Before proceeding to an explanation of the interior arrangements of the building, we present a general view, on a reduced scale, of the ground plan of a Grammar School-house, already built, including the cellar, yards, fences, gates, side-walks, &c. This will be seen in the annexed figure.