

# THE GEOGRAPHIC REGION: ASIA AND THE PACIFIC

## NEW CANADIAN CHANCERIES

There are three major projects currently underway, or just completed, in this geographic region: Hong Kong, Beijing and Tokyo.

### HONG KONG: AN IMPRESSIVE NEW CHANCERY

In March 1986, our new chancery in Hong Kong was officially opened. Located on floors 11-14 in Tower 1 of Exchange Square, the publicity brochures describe the Square as: "destined to become Asia's most sophisticated business and communications centre. The two 50-storey towers are situated at Hong Kong's commercial core, enjoying the most spectacular views of Victoria Harbour. The facilities will provide a standard of prestige and a working environment that will be hard to match in other financial centres of the world."

For the Department's interior designers the project provided unique challenges due to the unusual shape of each floor, the "tea factor" — providing accessible facilities for tea-making, "fung tsu" — the belief that one must face south-east for good luck, and the Chinese preference for round shapes and the color red.

Finally, it was all acceptably resolved.

### BEIJING: CONSTRUCTION IS ABOUT TO BEGIN

Work on the new Canadian complex in Beijing is scheduled to begin this summer.

The complex, as shown in the site plan pictured here, will contain the chancery, official residence, and ten townhouses, together with recreational facilities including a tennis court, swimming pool, squash court, games room, children's play area, lounge, and greenhouse. It is scheduled to be completed by the summer of 1988.

### TOKYO: AN ARCHITECT HAS BEEN SELECTED

Ray Moriyami, a Japanese Canadian from Toronto, will be designing the new chancery in Tokyo. The Department is currently in the process of preparing the design brief detailing the specific requirements, from which the architectural plans will be drawn.

The present chancery will be torn down and the new one built on the four acre property. Meanwhile temporary accommodation will be needed.

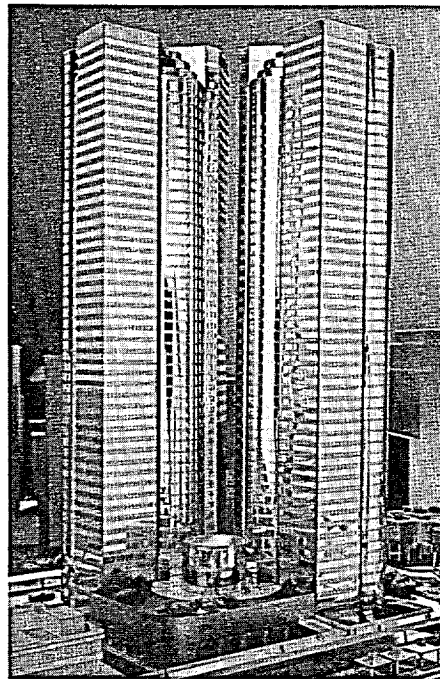

Hong Kong: the new Canadian chancery is on floors 11 to 14 in the left tower.

### A VISIT TO SOUTHEAST ASIA

Communiqué No. 50, February 21, 1986.

... "On this trip I have had the pleasure of announcing almost \$100 million worth of contracts awarded to Canadian firms now doing business in this vital area. As for the future, we have opened lines of credit for more than \$65 million to facilitate new exports to the region". [Mr. Kelleher]

## OSAKA, SHANGHAI AND BEIJING

Statement 85/54 address by James Kelleher, Vancouver, October 3, 1985.

...My government is launching a major trade initiative in the Asia-Pacific area. We have decided to commit an additional \$6.5 million this fiscal year to beef up our trade representation in the Pacific Rim. We are opening a Consulate General in Osaka which will be heavily oriented to trade and the acquisition of technology. We are sending four more Trade Commissioners to China, and we will be opening a Consulate in Shanghai before the end of the year. We also have started work on a score of special projects throughout the Asia-Pacific area and we're considering the merits of several more...

### BOMBAY: A NEW TRADE OFFICE

Communiqué No. 70, March 21, 1986.

... "The opening of the Bombay office demonstrates the importance which Canada attaches to trade with India. The new office will significantly improve services to Canadian exporters in India's most important commercial and economic centre". [Mr. Clark]

"If you look at our trade figures, you will see that Canada today exports more to the Asia/Pacific region than to all of Europe".... "this is not only a sign of the times, it is a sign of the future". [Mr. Kelleher]

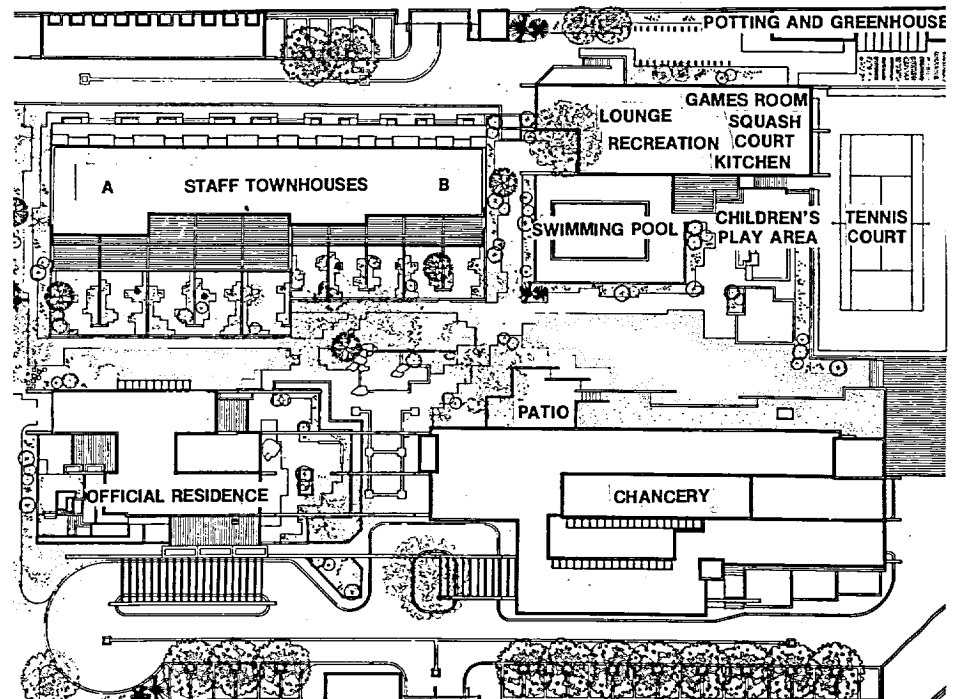

Site plan for the new Canadian complex in Beijing, China