

# THE CANADIAN ARCHITECT AND BUILDER

Vol. XX.—No. 7.

Toronto, Montreal—JULY, 1907—Winnipeg, Vancouver

PRICE 25 CENTS  
\$3.00 PER YEAR.

TILES FAIENCE MOSAICS  
**Craven, Dunnill & Co., Limited**  
JACKFIELD, R. S. O., SHROPSHIRE.  
ENAMELS WALLS LUSTRES

## KALAMEINED GLAD DOORS

Artistic and Fireproof

SEND FOR BOOKLET  
Automatic Heat Closing Fireproof Windows, Doors and Skylights,  
Fire Door Hardware, Adjustable Fire Door Hangers, Rolling Steel  
Shutters, Asbestos Lumber, Cornices, Corrugated Iron, Metal  
Ceilings, etc., Asbestos, Slate, Felt and Gravel Roofing.

**A. B. ORMSBY, LIMITED**

Factories: Queen & George Sts., TORONTO. 677-9-81 Notre Dame Avz. W., WINNIPEG  
Montreal Agents: Stinson-Reeb Builders' Supply Co., Limited, 188 William Street.

## OTIS-FENSOM ELEVATOR CO., Limited

MANUFACTURERS OF "OTIS STANDARD ELEVATORS"

HEAD OFFICE:  
CONFEDERATION LIFE BLDG.,  
TORONTO.

MONTREAL OFFICE  
423 ST. JAMES ST.

WINNIPEG OFFICE:  
44 CANADA LIFE BUILDING.

"MADE IN CANADA"

## Bent Glass

Made in all Kinds of Glass  
on Short Notice.

Large Bent Plate Glass for  
Shop Fronts a Specialty.

Toronto Plate  
Glass Importing Co.  
(MILL & RUTHERFORD)  
155-143 Victoria Street

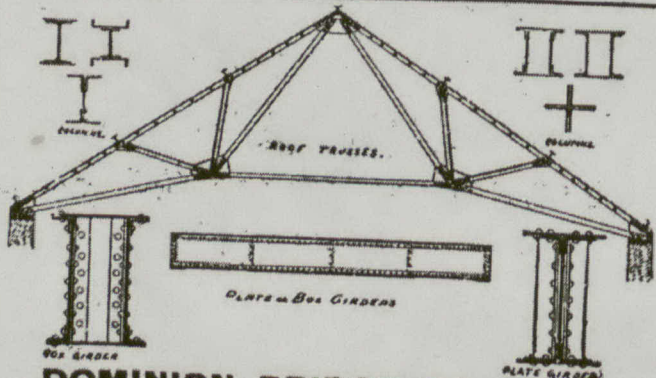

## DOMINION BRIDGE CO. (LIMITED)

WE BUILD { Bridges of all designs in both Iron and Steel, Roofs, Telephone  
Poles, House Girders and all kinds of Structural Iron Work.

OUR STOCK IN  
HAND COMPRISES { Steel Beams, Angles, Tees, Channels, Plates, Rolled Edged  
Flats, Bars, Rivets, Rounds, &c. Iron Beams, Bars,  
Squares, Turnbuckles, Rivets, &c.

Estimates furnished for Structural Iron Work delivered at building or erected

GEORGE E. EVANS,  
Ontario Agency: Room 25, Canada Life  
Building, Toronto. Telephone Main 2164

Post Office Address:  
DOMINION BRIDGE CO., LTD., Montreal, P.  
Works at Lachine Locks, P. Q.

## TURNBULL ELEVATORS

SEE AD. PAGE VIII

## ELEVATORS

The Turnbull Elevator Mfg. Co. Toronto

For all purposes. Satisfaction guaranteed.  
Write for prices and references  
**THE PARKIN ELEVATOR WORKS**  
258 Catherine Street North,  
HAMILTON, ONT.

WORKS:  
99-215 Victoria Street  
TORONTO