

School house No. vii. has just been erected in Rochester. It is a substantial and elegant building, and in its general arrangement, and a adaptation to school purposes, is superior to any other school house in that section of the State. One fault of several of the school houses built within the last few years, is the large size of the rooms designed for the primary scholars. The fault is not because there is room to spare—for those of the largest size are full to overflowing, and so many

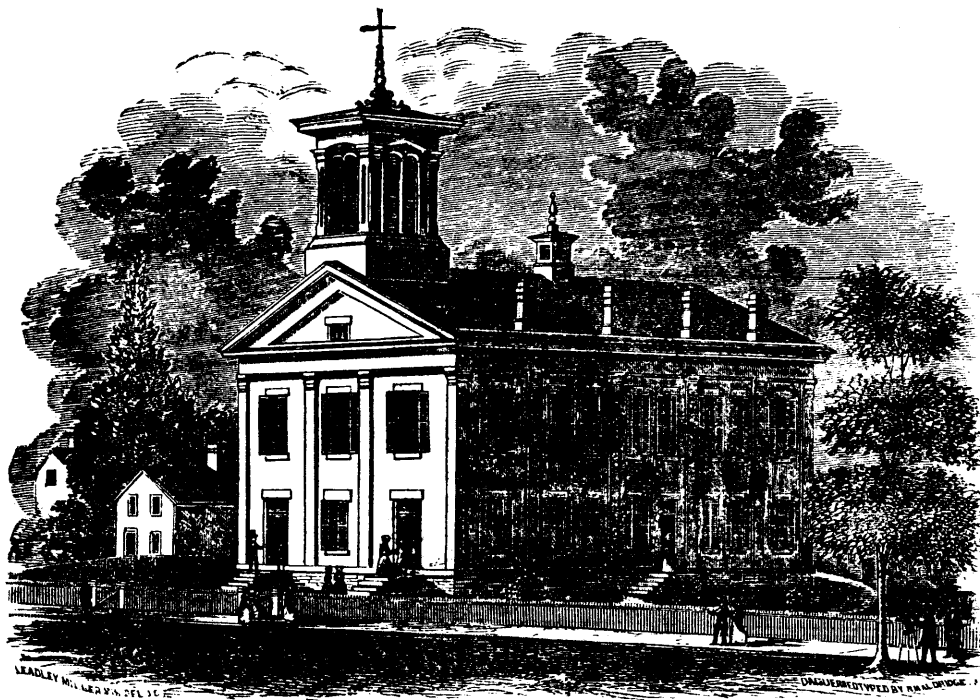

are assembled in one department without recitation rooms, that it is found necessary to employ two teachers in the same room. This necessarily creates confusion, often prevents the preservation of good order, and leads to other serious annoyances. After scholars have passed the primary department a larger number may be assembled in one room to advantage, if there is a full complement of recitation rooms adjoining. A plan of the school rooms is given herewith.

PLAN NO. VII. PERSPECTIVE OF SCHOOL HOUSE, FENCE AND GROUNDS.

The size of the building on the ground is 84 feet 8 in. by 60 feet 8 in.

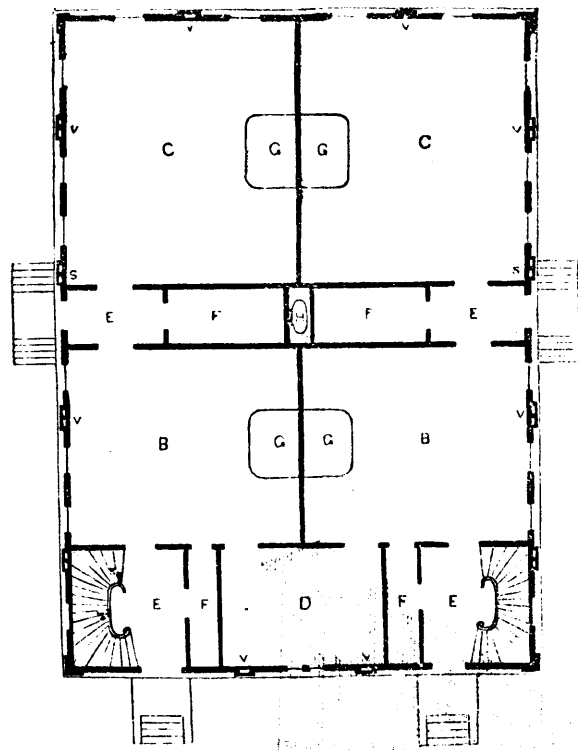

FIG. III.—PLAN VII. FIRST FLOOR.

- B. Intermediate Rooms, 28½ by 25 feet.
- C. Primary Rooms, 28½ by 33 feet.
- D. Recitation Room, 19½ by 15 feet.
- E. Halls, 15 by 14 feet.
- F. Wardrobes, 15 by 4 feet.
- G. Teachers' Desks.
- H. Furnace Register.
- V. Ventilating Registers.

The building is heated by two of Chilson's Furnaces in the basement.

It will be seen that there are two primary rooms, in each of which can be comfortably accommodated as many as one teacher can instruct. The intermediate rooms, though about the same size as the primary, will be occupied by older pupils, pursuing a greater range of studies, and they will seat more than two teachers can well instruct. The third teacher will occupy the adjoining recitation room, which it will be seen communicates with both of the intermediate rooms, so that classes can be received from either or both as circumstances may require.

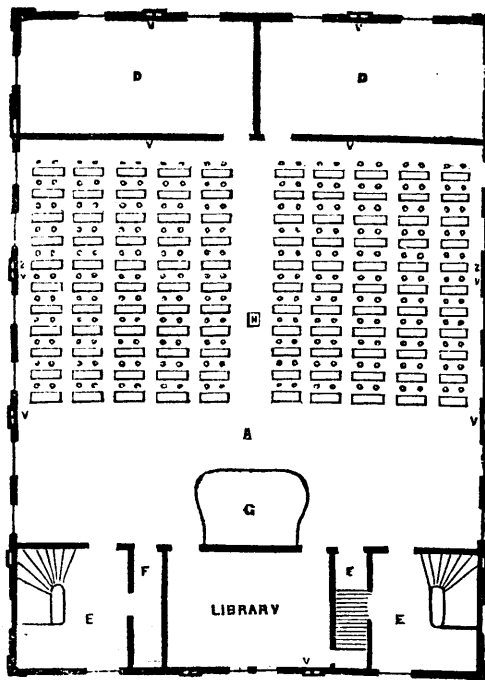

FIG. III.—PLAN VII. SECOND FLOOR.

- A. Senior Room, 50 by 58 feet.
- L. Library and Teacher's Room, 19½ by 15 feet.
- D. Recitation Rooms, 28½ by 15 feet.
- E. Halls, 15 by 14 feet.
- F. Wardrobes, 15 by 4 feet.
- G. Teacher's Desk.
- H. Furnace Register.

The senior department, without being unduly crowded, will seat 220 scholars. The recitation rooms in the rear of the building, are so arranged that classes make the least possible disturbance in passing to and from the main school room. The library room in the rear of the Master's desk is sufficiently commodious for a recitation room, in addition to the other purposes for which it is designed, and may be used for that purpose if necessary. With slight alteration in the arrangement of doors, and one or two other points easily remedied, a school house for the accommodation of 500 pupils could not be better arranged. It will doubtless be a model, in its general arrangement, to be followed hereafter whenever houses of similar size are to be constructed.