

THE CANADIAN ARCHITECT AND BUILDER

STUDENTS' DEPARTMENT.

ANCIENT ENGLISH CATHEDRALS.

Winchester, in its earliest form, must hold the place of the most ancient. The original cathedral claims, on very apocryphal authority, to have been built in 177, by the newly-converted British King Lucius, on the site of a great Pagan temple. Another was built in 313, and another in 871. The present pile, regarded in its various parts, is of at least seven principal dates; and if viewed in its minor features, its smaller accessories, its remodellings, and its restorations, must be pronounced to belong to ten centuries. The oldest parts of the edifice belong to a pile in the Saxony style, by the famous architects and bishops of Winchester, to Ethewold in 980. Lichfield Cathedral is said by some authors to have been erected in 300, and by others in 667, and rebuilt in 700. Canterbury is very ancient; it is said to have been founded by St. Augustine, as also is Rochester. They appear to be of about the same date. The former was founded in 598, and partially rebuilt in 1080; the latter between 600 and 1000. Exeter had a cathedral standing in 1050.

THE COLONNADE.

Colonnades are of various forms and dimensions, and assume different names according to their application and uses says the

Builders' Reporter. When in front of a building or in the interior of a quadrangle they are called porticoes; when surrounding a building of any shape, peristyles; when double or more, as in some of the ancient temples, and the circular peristyle in front of St. Peter's at Rome, they are polystyle. No people have made more use of colonnades, or with greater effect, than the ancient Egyptians, many of their temples being literally thickset, both in the interior and exterior, with colonnades of every description. The Greeks were more simple in their arrangement, and their colonnades were mostly distributed into porticoes and peristyles, both monostyle and polystyle. Their most magnificent example is perhaps the Temple of Jupiter Olympius at Athens. Baalbec and Palmyra present also various examples of splendid colonnades. Of modern works, the magnificent colonnade of the Piazza di San Pietro at Rome, the work of Bernini, is at once the grandest and most beautiful. It consists of 280 columns, and 48 pilasters of 40 feet high, raised on three lofty steps. It is surmounted by a balustrade, on which are 88 colossal statues 15 feet in stature. Colonnades are among the most beautiful and splendid works of architecture, and in the hands of a man of taste and science are capable of the grandest and most imposing effects.

Mr. J. Wilson Gray, architect, of Toronto, is at present on a visit to Great Britain.

Milton

DR. ROBERTSON, PRESIDENT.

J. S. McCANNELL, MANAGING DIRECTOR.

ARCHITECTURAL TERRA COTTA

BRICK MANTELS



FLOOR TILE

High-Grade Pressed and Ornamental Bricks in red, buff, yellow, salmon, brown, and special shades. : : :

Pressed

Our products have a wide reputation and are specified by leading architects. : :

THE MILTON PRESSED BRICK CO., LIMITED

Works and Head Office: MILTON, ONT.

Bricks

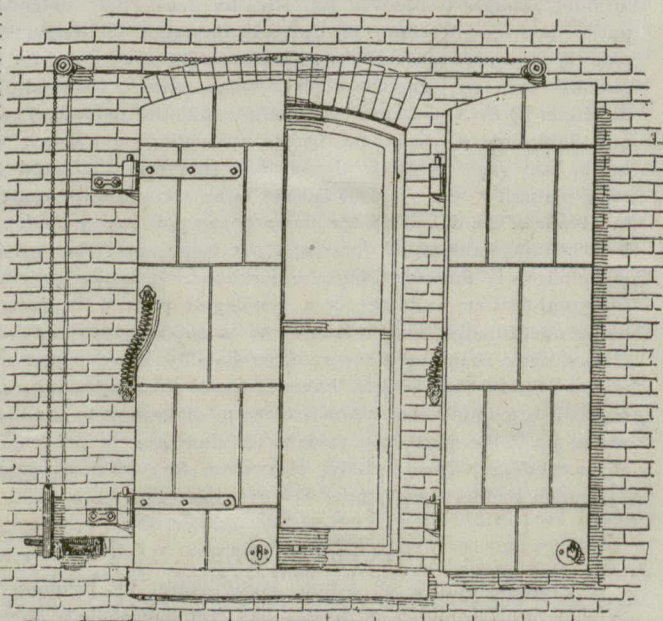
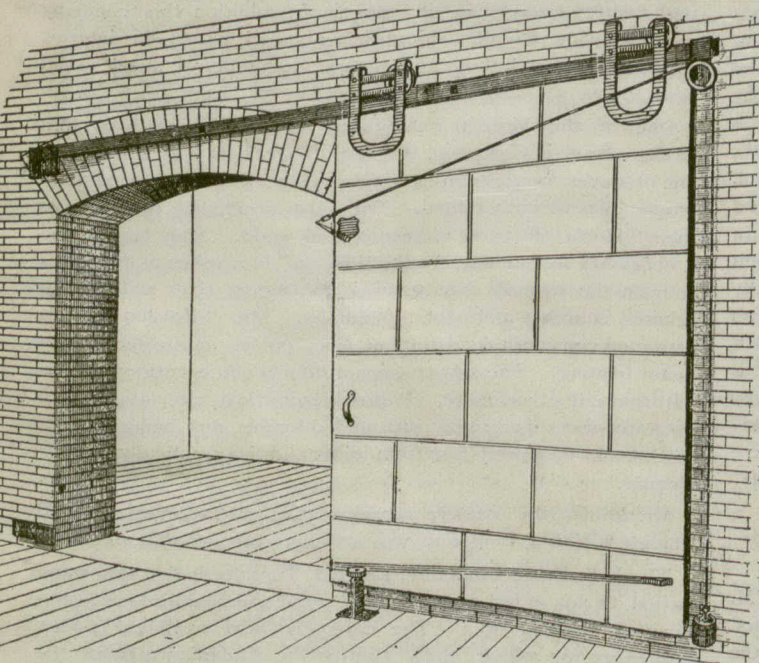

Double Swing Shutters.

SET No. 444

"ACME" AUTOMATIC FIRE DOOR FITTINGS, (SET No. 99) "ACME" AUTOMATIC FIRE SHUTTER FITTINGS
SELF-CLOSING BY HEAT.

We manufacture the Best Kinds made of Acme Automatic Self-Closing Fire Door and Shutter Fittings. Write us for Catalogue and Prices. Use Acme Fittings and Save Insurance.

THE VOKES HARDWARE CO., Limited, - - Cor. Yonge and Adelaide Sts., - - TORONTO.