

Bank of British North America, Montreal, Quebec

A BANK to possess the necessary facilities for proper administration must be a resultant of the combined efforts of banker and architect. This is often a serious difficulty, as the banker lacks the faculty, as a rule, of interpreting plans, while the architect can rarely spare sufficient time to inform himself of the various needs and proper methods for executing same. Sometimes the trouble is evaded by calling in the services of a specialist, who becomes the official medium between the client and the designer, thereby facilitating the work of both.

In the Bank of British North America, located on St. James street, the firm of Barott, Blackader & Webster have successfully solved the problem, adapting the design and arrangement to meet the present needs and still adhere to the architectural style of the original structure. They have secured the greatest amount of efficiency in the available space and brought the administrative corps in close relation to the general public.

Upon entering one passes through heavy walnut doors elaborately carved into the vaulted vestibule lined with marble, which in turn opens into the banking room proper, seventy-four feet long, sixty-five wide and thirty-five high. Twenty fluted columns, eighteen feet in height, support the clere storey, while above is a deeply coppered ceiling, richly ornamented and painted in varying harmonious shades, with the ornament picked out in gold leaf and color. The screen and counter is one hundred and five feet in length, the latter supporting a low polished bronze and glass screen, except where enclosures are required for the tellers' cages, at which place the screen is of a greater height and formed of bronze pilasters and cornice, with bronze mesh enclosures at the rear and sides. The trim and fixtures throughout are of mahogany, and the floor in the clerical section of compressed cork, and that in the public space of marble.

In order to obtain the maximum amount of direct light for the banking room, the side walls

of the building were recessed to form courts above the main ceiling and skylights installed over the side clerical sections, the clere storey being pierced with openings into the same side courts, while in addition to these large windows are located in the rear wall of the room. Facing the principal street and directly off the banking room are located the local manager's office, and rooms for correspondence and committees. The general manager's and executive offices are over the banking space, the former being twenty-six by twenty feet, designed in mahogany, and amply lighted by three large casement windows. On the second floor is located additional clerical and staff offices, while on the present top floor ample accommodation is provided for the use of the staff, consisting of living and bedrooms, dining-room and kitchen in addition to a large filing room.

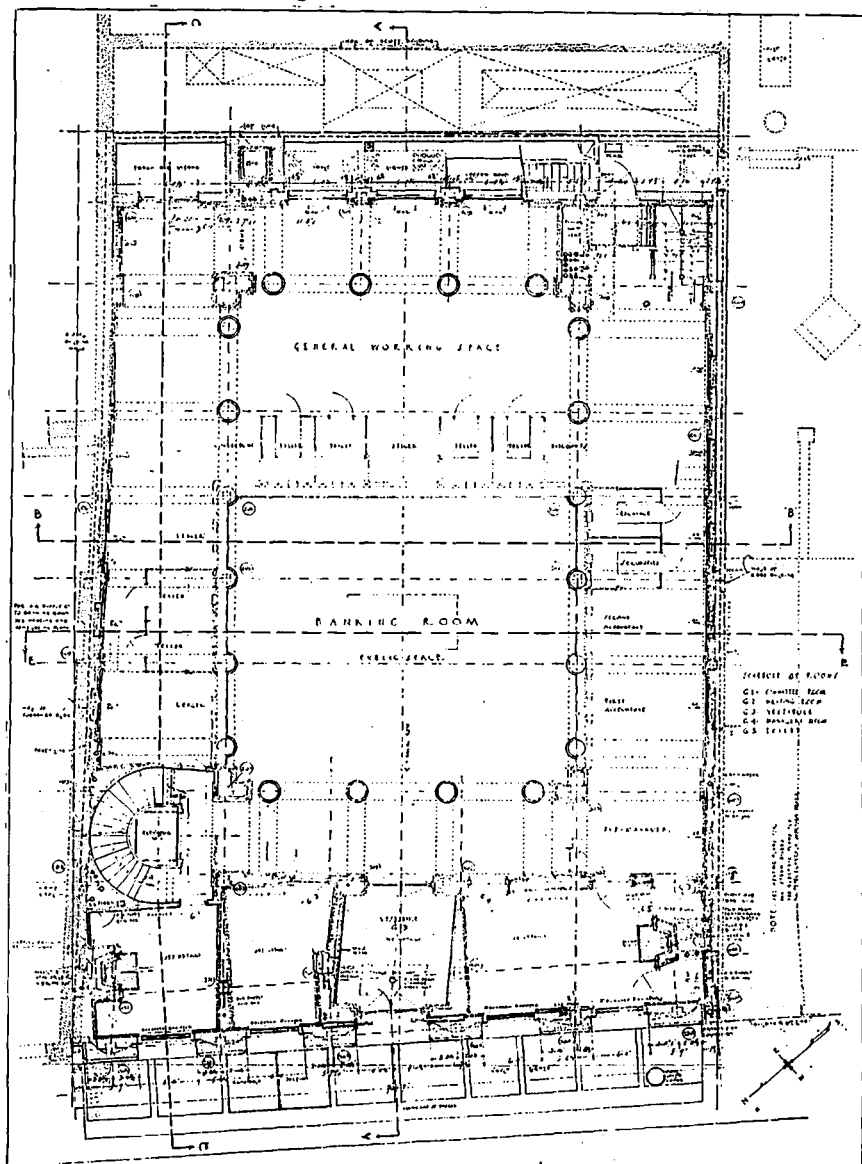

MAIN BANKING ROOM FLOOR PLAN.